



AGENDA
REGULAR MEETING
AGOURA HILLS CITY COUNCIL
Civic Center - Council Chambers
30001 Ladyface Court, Agoura Hills, California 91301
Wednesday, January 28, 2026
6:00 PM

Please silence all cell phones and other electronic devices during the meeting.

ATTEND OR WATCH THE MEETING

For in-person attendance, the Council Chambers will open to the public at 5:30 p.m. To watch the live stream or archived meeting, search “Agoura Hills City Council” on [YouTube](#) and select the meeting by date, or visit [agourahillscity.gov](#) and click the dark green “View Current Agenda(s) or Live/Archived Meetings” button at the top of the page.

PUBLIC PARTICIPATION (PUBLIC COMMENT)

Option A: To provide public comments in person in the Council Chambers

Members of the public may attend the meeting in person in the Council Chambers and have the opportunity to speak or submit a written comment on any item listed on the Agenda. To speak, complete a Speaker’s Card for each item and submit it to the City Clerk before the public comment portion of that item. Public testimony is limited to three (3) minutes per speaker, and time may not be transferred to another person. Written comments submitted during the meeting will not be read aloud by the City Clerk.

Option B: To submit written public comments prior to the meeting

*Members of the public may submit written comments on any item listed on the Agenda. To ensure the City Council has time to review and/or consider the information prior to the meeting, please include the Agenda item number or topic in the email subject line and **send written public comments to comments@agourahillscity.gov on or before 4:00 p.m. on the meeting date.** Public comments are not read into the record by the City Clerk. Please note: any public comments submitted after the deadline may not be considered during the City Council’s deliberations or included in the official record. However, the public is welcome to attend the meeting to make or submit comments in person.*

CALL TO ORDER

LAND ACKNOWLEDGEMENT

PLEDGE OF ALLEGIANCE

ROLL CALL

Mayor Jeremy Wolf
Mayor Pro Tem Deborah Klein Lopez
Councilmember Kate Anderson
Councilmember Chris Anstead
Councilmember Penny Sylvester

REPORT OF CLOSED SESSION

APPROVAL OF AGENDA

PRESENTATIONS

INTERGOVERNMENTAL, SPECIAL PURPOSE COMMITTEE, AND DEPARTMENTAL REPORTS

Las Virgenes / Malibu Council of Governments Update
Santa Monica Mountains Conservancy Advisory Committee Update

PUBLIC COMMENTS

(This section is reserved for persons wishing to address items not listed on the Agenda that are under the subject matter jurisdiction of the City Council. Please refer to “Public Participation” above for full details on how to speak or submit written public comments under this category.)

CONSENT CALENDAR

(Items on the Consent Calendar may be approved by a single motion and vote. Unless pulled by the City Council, there will be no separate discussion of these items. This section is reserved for persons wishing to address items on the Consent Calendar. Please refer to “Public Participation” above for full details on how to speak or submit written public comments under this category.)

1. Approve Demand Warrant Register No. 944
RECOMMENDATION; Approve Demand Warrant Register, as presented.
2. Approve Rejection of Claim for Damages – James and Carolina Drews
RECOMMENDATION: Deny the claim for damages from claimants James and Carolina Drews c/o Chang-Klein LLP.
3. Approve Third Amended and Restated Sewer Extension Reimbursement Agreement No. 26-01 on Chesebro Road
RECOMMENDATION: Approve Third Amended and Restated Sewer Extension Reimbursement Agreement No. 26-01.
4. Adopt Ordinance No. 26-483, Adopting the 2025 Engineering and Traffic Survey
RECOMMENDATION: Adopt Ordinance No. 26-483; AN ORDINANCE OF THE CITY COUNCIL OF THE CITY OF AGOURA HILLS, CALIFORNIA, AMENDING AND DECLARING PRIMA FACIE SPEED LIMITS FOR NINE SPECIFIC ROAD SEGMENTS OF AGOURA ROAD, CANWOOD STREET, DRIVER AVENUE/PALO COMADO CANYON ROAD, KANAN ROAD, REYES ADOBE ROAD AND CORNELL ROAD.

PUBLIC HEARING

(This section is reserved for persons wishing to address items listed under Public Hearing. Please refer to “Public Participation” above for full details on how to submit written public comments or speak under this category.)

5. Conduct a Public Hearing, Waive Full Reading, and Introduce Ordinance No. 26-484; Amending Section 2900 of Chapter 9 of Article II of the Agoura Hills Municipal Code to Adjust Compensation for City Council Members
RECOMMENDATION: Waive Full Reading and Introduce Ordinance No. 26-484; AN ORDINANCE OF THE CITY COUNCIL OF THE CITY OF AGOURA HILLS, CALIFORNIA, AMENDING SECTION 2900 (COMPENSATION) OF CHAPTER 9 (CITY COUNCIL) OF ARTICLE II (ADMINISTRATION) OF THE AGOURA HILLS MUNICIPAL CODE TO ADJUST COMPENSATION FOR CITY COUNCIL MEMBERS.

6. Conduct a Public Hearing to Consider the Adoption of Resolution No. 26-2124; Approving Community Development Block Grant (CDBG) Programs and Projects for the 52nd Program Year
RECOMMENDATION: Adopt Resolution No. 26-2124; A RESOLUTION OF THE CITY COUNCIL OF THE CITY OF AGOURA HILLS, CALIFORNIA, APPROVING COMMUNITY BLOCK GRANT (CDBG) PROGRAMS AND PROJECTS FOR THE 52ND PROGRAM YEAR (JULY 1, 2026 - JUNE 30, 2027).

DISCUSSION / ACTION

(This section is reserved for persons wishing to address items listed under Discussion / Action. Please refer to “Public Participation” above for full details on how to submit written public comments or speak under this category.)

7. Consideration of 2026 Solid Waste Rate Adjustment (SWRA) Request from Waste Management
RECOMMENDATION: Consider Waste Management’s request for an additional Solid Waste Rate Adjustment (SWRA), and provide direction to staff regarding approval, modification, or denial of the requested SWRA increase for 2026.

CITY COUNCIL, STAFF COMMENTS

ADJOURNMENT

The next Regular City Council Meeting will be held at 6:00 p.m., on February 11, 2026, in the Council Chambers of the Civic Center. The Civic Center is located at 30001 Ladyface Court, Agoura Hills, California.

In accordance with the Americans with Disabilities Act, if you require special assistance to participate in a City Council meeting or to access other services offered by the City of Agoura Hills, please contact the City Clerk’s Office at (818) 597-7300. To ensure that reasonable arrangements can be made to provide appropriate access, please provide notification at least 48 hours in advance of the meeting or time when services are needed.

Copies of staff reports or other written documentation related to each item of business on this Agenda are available on the City’s website at agourahillscity.gov and are on file in the Office of the City Clerk, Kimberly M. Rodrigues, at Agoura Hills City Hall, 30001 Ladyface Court, Agoura Hills, California, 91301.

The telecast of Regular City Council Meeting held on Wednesday, January 28, 2026 will be broadcast on Channel 10 for Time Warner Cable subscribers and Channel 3 for Charter subscribers and air daily until the next regularly scheduled City Council meeting. The broadcast schedule is as follows: M-10a m; T-3pm; W-10am; Th-7pm; F-10am; S-3pm; and Su-7pm.

Date Posted: January 22, 2026



REPORT TO CITY COUNCIL

DATE: JANUARY 28, 2026
TO: HONORABLE MAYOR AND MEMBERS OF THE CITY COUNCIL
FROM: NATHAN HAMBURGER, CITY MANAGER
BY: DIEGO IBANEZ, DIRECTOR OF FINANCE
SUBJECT: APPROVE DEMAND WARRANT REGISTER NO. 944

Demand Warrant No. 944 is hereby submitted for your approval.

FISCAL IMPACT

All items on the Demand Warrant are budgeted items; and all the items, when aggregated and annualized, are found to be within budget.

RECOMMENDATION

It is recommended the City Council approve Demand Warrant No. 944.

Attachments

[DWR 944.pdf](#)

January 28, 2026

DEMAND WARRANT REGISTER NO. NINE HUNDRED FORTY FOUR

Pursuant to Section 2508, of the Agoura Hills Municipal Code (AHMC), the demands are herein presented, having been duly audited, and are hereby allowed and approved for payment in the amount as shown for the designated payees and charged to the appropriate funds as indicated.

Pursuant to Section 37202 of the Government Code, I certify the above demands are accurate and funds are available for payment thereof.

I hereby certify Demand Warrant No. 944 is a full, true, and correct statement.

A handwritten signature in black ink, appearing to read "Nathan", written over a horizontal line.

Nathan Hamburger, City Manager

Demand Register 944



Payment Date	Number	Vendor Name	Description	Payment Amount
11/28/2025		Payroll November 2025	Payroll & Vendor Payments	<u><u>300,497.37</u></u>
12/04/2025	118995	A Rental Connection	Rental Table Cloths	215.04
12/04/2025	118996	Access Corp	Storage 11/01/2025 - 11/30/2025	944.92
12/04/2025	118997	ACT, A Div of Cherokee Chemical Co., Inc	Water Treatment Service Nov 2025	340.00
12/04/2025	118998	Agromin	Cover Mulch 11/13/25	6,585.00
12/04/2025	118999	All City Management	Crossing Guard Services 11/16/25 - 11/29/25	8,839.31
12/04/2025	119000	Alliant Insurance Svc	HOTH Insurance 01/01/25 - 12/25/25	433.00
12/04/2025	119001	Andrew Young	Refund Security Deposit/Rental Income	900.00
12/04/2025	119002	Annie Sumioka	Refund Security Deposit	1,000.00
12/04/2025	119003	Base Hill, Inc.	Cleaning Service Oct 2025 Rec Center	10,471.60
12/04/2025	119004	Brightview Landscape Services	Landscape Maintenance Nov 2025	22,203.71
12/04/2025	119005	Bryco Plumbing	Plumbing Repairs Rec	2,779.00
12/04/2025	119006	Calabasas Printing	Winter Newsletter	707.34
12/04/2025	119007	CD Painting, Inc.	Refund Permit Fees PZ-2025-161-SIGN	7,587.37
12/04/2025	119008	Celeste Bird	Reimburse for Purchase on Personal Credit Card	39.99
12/04/2025	119009	County of Los Angeles Department of Public Works	Labor & Equip Driver & Ladyface Greenway	34,199.12
12/04/2025	119010	Dapeer, Rosenblit & Litvak Llp	Professional Services Oct 2025	8,866.01
12/04/2025	119011	Delphine G. Herrera	Instructor Payment - Classes	657.50
12/04/2025	119012	Dept Of Animal Care & Control	Animal Control Services Oct 2025	7,269.58
12/04/2025	119013	Deyanira Caceres	Refund Security Deposit/Rental Income	750.00
12/04/2025	119014	ECO Friendly Millworks, Inc	Millwork Touch Up Rec Center	875.00
12/04/2025	119015	Elizabeth Eaves	Instructor Payment Classes	257.70
12/04/2025	119016	Ethan Krizman	Refund Security Deposit	1,000.00
12/04/2025	119017	Gabriel M. Graham	COG Homeless Outreach Nov 2025	8,090.00
12/04/2025	119018	GSG Protective Services	Event Center Security Nov 2025	5,925.00
12/04/2025	119019	Hiloni Kadakia	Refund Security Deposit	1,000.00
12/04/2025	119020	Jessica Flores	COG Admin Support Nov 2025	3,000.00
12/04/2025	119021	Jordan Eknoian	Refund Security Deposit	1,000.00
12/04/2025	119022	Kimley Horn & Assoc.	On-Call Services Sep 2025	83,454.67
12/04/2025	119023	LA County Dept Of Public Works	Labor & Equipment Driver Ave	36,026.33
12/04/2025	119024	Larry Walker Associates	Malibu Creek CIMP/TMDL Oct 2025	109,809.03
12/04/2025	119025	Los Angeles County Sheriff Department	Wage Garnishment	3,042.96
12/04/2025	119026	Los Angeles County Sheriff's	Sheriff Services Oct 2025	481,888.66
12/04/2025	119027	Mackay Communications	GSPS Monthly Fee Oct 2025	426.87
12/04/2025	119028	Malibu BC, LLC	Catering	1,200.00
12/04/2025	119029	Michael Lang	Design Meet the Author Oct 2025	725.00
12/04/2025	119030	Myra Ming	Refund Missed Class	10.00
12/04/2025	119031	National Utility Locators LLC	Utility Locating Services Nov 2025	1,700.00
12/04/2025	119032	Pers	PERS Reporting Adjustment 11-28-2025 PR	106.23
12/04/2025	119033	Pitney Bowes	Postage Meter Lease 10/01/25 - 12/31/25 Rec	168.86
12/04/2025	119034	Ricoh USA, Inc	Copier Leases Sep & Dec 2025	1,636.28
12/04/2025	119035	RMG Communications	Filming/Editing State of the City Event Nov 2025	3,248.00
12/04/2025	119036	Rms Printing Llc	Banners/Posters State of the City	6,469.77
12/04/2025	119037	Ronald F. Troncatty	Monthly Maintenance Old Agoura Park Nov 2025	1,825.00
12/04/2025	119038	Ron's Maintenance	Catch Basin Maintenance/Filter Cleaning Nov 2025	26,112.00
12/04/2025	119039	SaberDome Corp	Monthly Services/Licenses Dec 2025	12,016.20
12/04/2025	119040	Signature Signs	PVC Sign Panel Morrison Park	291.94
12/04/2025	119041	Skylar Purvis	Refund Security Deposit	900.00
12/04/2025	119042	Solid Waste Solutions, Inc.	Film Permit Fees Nov 2025	6,149.25
12/04/2025	119043	Southern California Edison	Utilities Oct 2025	6,932.99
12/04/2025	119044	Staples Business Advantage	Supplies	299.06
12/04/2025	119045	State Water Resources Control	Annual Permit Fees	5,071.00
12/04/2025	119046	Stephanie Delgado	Refund Security Deposit	1,000.00
12/04/2025	119047	Terry Dipple, Inc.	COG Activities Nov 2025	17,218.00
12/04/2025	119048	The Acorn Newspapers	City Ads & Notices	2,050.28
12/04/2025	119049	The Frame Gallery	Reyes Adobe Days Posters	363.43
12/04/2025	119050	T-Mobile USA Inc.	Monthly Service Charges 10/21/25 - 11/20/25	31.35
12/04/2025	119051	Total Access Elevator LLC	Maintenance Billing Dec 2025	155.00
12/04/2025	119052	Townsend Public Affairs, Inc.	Consulting Services Nov 2025	5,000.00
12/04/2025	119053	TPX Communications	Monthly Communication 11/23/25 - 12/22/25	810.04
12/04/2025	119054	Underground Service Alert	AGRH New Tickets/Maintenance Fee	30.00
12/04/2025	119055	Venco Electric Inc.	Electrical Light Repair Rec Center	2,661.00
12/04/2025	119056	Vivian Rescalvo	Professional Services COG Nov 2025	13,262.58

12/04/2025	119057	Vortex	Door Repair Sumac Restroom	606.46
12/04/2025	119058	West Coast Arborists, Inc	25-26 Citywide Tree Assessment/Maintenance	43,413.27
12/04/2025	119059	Willdan	Water Quality Services Oct 2025	4,332.00
			Total	1,016,379.70
12/04/2025	<u>ACH Payment</u>	Spare Labs Inc.	Dial-A-Ride Services Oct 2025	20,728.02
			Grand Total	1,037,107.72
12/11/2025	119060	A Rental Connection	One City One Book/Holidays on the Hill Rental Equip	2,590.74
12/11/2025	119061	All City Management	Crossing Guard Services 10/26/25 - 11/08/2025	9,823.49
12/11/2025	119062	Andrew Heath	Consulting Services 11/10 - 12/07/2025	3,885.00
12/11/2025	119063	Base Hill, Inc.	Cleaning Service Nov 2025 Rec	6,010.00
12/11/2025	119064	Bobbie Constanten	Refund Senior Excursion Luncheon	7.00
12/11/2025	119065	Brightview Landscape Services	Landscape Maintenance Nov 2025	31,375.17
12/11/2025	119066	Charles Celano Jr	Individual Coaching 10/23 & 11/13/2025	550.00
12/11/2025	119067	Conrad N Hilton Foundation	Security Deposit Refund	1,352.00
12/11/2025	119068	Create Studio	Holiday on the Hill Crafts	100.00
12/11/2025	119069	Direct Tv	Cable Service Dec 2025	59.99
12/11/2025	119070	Dish	Cable Service Dec 2025 Rec	163.73
12/11/2025	119071	Esri	ArcGIS Subscription/Maintenance Renewal 2026-2027	11,680.00
	119072-119099	VOID - Printing Error		-
12/11/2025	119100	Executive Facilities Services, Inc	Janitorial Services Dec 2025	2,764.86
12/11/2025	119101	Fairytales & Heroes, LLC	Holiday Event 12/06/25 Santa & Mrs Claus	1,350.00
12/11/2025	119102	Fedex	Express Service Legal - Project NIB 25-04	173.71
12/11/2025	119103	Geodynamics	Geotechnical Review Services Nov 2025	3,422.50
12/11/2025	119104	Gotem, Inc.	Pest Control Rec Center/Parks/City Hall	660.00
12/11/2025	119105	GSG Protective Services	Security 11/24/25 - 11/30/25	540.00
12/11/2025	119106	Jeff Calica	Security Deposit Refund	1,000.00
12/11/2025	119107	Jeff Wachtel	Squarespace Annual Fee 11/19/25 - 11/19/2026	192.00
12/11/2025	119108	Lydia Gable Realty Group	Security Deposit Refund	1,000.00
12/11/2025	119109	m6 Consulting, Inc.	Building Inspection/Plan Check Services Nov 2025	33,101.27
12/11/2025	119110	Malibu BC, LLC	Holiday on the Hill Catering	2,000.00
12/11/2025	119111	Michael Baker International, Inc.	Professional Services Thru 10/2025 Kanan Corridor	26,085.05
12/11/2025	119112	Michael Lang	Design Holiday on the Hill	1,507.00
12/11/2025	119113	Ooma, Inc.	Air Dial Services Nov 2025	586.08
12/11/2025	119114	Prudential Overall Supplies	Rec Center Mats	161.55
12/11/2025	119115	Rincon Consultants	Prof Services Nov 2025 - CUP-2022-0012	4,721.00
12/11/2025	119116	SCA of CA, LLC	Street Sweeping - Special	110.00
12/11/2025	119117	Senior Concerns	Senior Advocacy Services Nov 2025	833.00
12/11/2025	119118	Signature Signs	Fabrication/Installation/Relocation of Signs	5,258.12
12/11/2025	119119	Smith Pipe & Supply Inc.	Irrigation Supplies City Wide	1,986.22
12/11/2025	119120	South Central Planning and Development Commission	Software License Fee Nov 2025	1,533.33
12/11/2025	119121	Southern California Edison	Utilities Nov 2025	18,708.56
12/11/2025	119122	Spectrum Enterprise	Cable Service 12/03/25 - 01/02/2026	402.98
12/11/2025	119123	The Acorn Newspapers	Ad Notices	2,348.08
12/11/2025	119124	Tiny Porch Concerts	Holiday on the Hill Artist	500.00
12/11/2025	119125	Turbodata	Citation Processing Nov 2025	200.00
12/11/2025	119126	Us Bank Corp. Payment System	City Credit Card Payment Dec 2025	22,218.90
			Total	200,961.33
12/12/2025		Payroll December 2025	Payroll & Vendor Payments	232,189.99
12/18/2025	119128	Access Corp	Storage Dec 2025	2,031.46
12/18/2025	119129	All City Management	Crossing Guard Services 11/23/25 - 12/06/2025	4,911.57
12/18/2025	119130	AT&T	Internet Usage 12/05/25 - 01/05/2026	195.80
12/18/2025	119131	At&t Mobility	IPad Service Nov 2025	792.94
12/18/2025	119132	Berg & Associates, Inc.	Professional Services - Ladyface Greenway	58,831.19
12/18/2025	119133	Blue Table	Reorg Reception	1,446.00
12/18/2025	119134	Brennan Estimating Svcs.	Annual Inspection/Testing Firealarm/Sprinklers	5,705.00
12/18/2025	119135	Bureau Veritas America	Plan Review Services 11/01/25 - 11/30/2025	8,229.00
12/18/2025	119136	Cal State Site Services	Portable Restrooms Morrision Park	427.93
12/18/2025	119137	Calabasas Printing	Rose Bowl Banner/Car Magnets	255.72
12/18/2025	119138	City of Thousand Oaks Transit	Dial-A-Ride Services Oct 2025	12,250.38
12/18/2025	119139	Coastal Event Lighting and Production	Lighting Holidays on the Hill Event	470.00
12/18/2025	119140	County of Los Angeles Department of Public Works	W0353010 Inspection Nov 2025	33,074.22
12/18/2025	119141	Cr Print	Business Cards - Wolf	157.50
12/18/2025	119142	Delphine G. Herrera	Instructor Payment Classes	818.50
12/18/2025	119143	Elizabeth Eaves	Instructor Payment Classes	358.00
12/18/2025	119144	Gabriel M. Graham	Homeless Outreach Dec 2025	8,090.00
12/18/2025	119145	GMZ Engineering, Inc.	Ladyface Greenway Project Progress Payment #15	397,281.84
12/18/2025	119146	GSG Protective Services	Security 12/01/25 - 12/07/25	540.00
12/18/2025	119147	Jessica Flores	Admin Support COG Dec 2025	3,000.00
12/18/2025	119148	Kathryn Walters	Refund Security Deposit	2,000.75

12/18/2025	119149	Las Virgenes Municipal Water	Water Usage 09/19/25 - 10/20/25	40,564.92
12/18/2025	119150	Los Angeles County Registrar	Notice of Exemption	75.00
12/18/2025	119151	Los Angeles County Sheriff's	Sheriff Services Nov 2025	481,448.53
12/18/2025	119152	m6 Consulting, Inc.	Professional Services - Ladyface Greenway	169,005.00
12/18/2025	119153	Michael Lang	Design & Print Winter 2025/2026 Activity Guide	11,725.00
12/18/2025	119154	Patrick O'Connell	Holidays On the Hill Supplies	750.00
12/18/2025	119155	Respect Martial Arts	Instructor Karate Classes	249.90
12/18/2025	119156	Richards, Watson & Gershon	Professional Services Nov 2025	23,778.84
12/18/2025	119157	Rincon Consultants	Professional Services - Bicycle Master Plan CEQA	2,973.85
12/18/2025	119158	Rms Printing Llc	Holidays on the Hill Signs	526.80
12/18/2025	119159	Sierra Installations	Concert/RAD Banner Swap	6,240.00
12/18/2025	119160	South Coast Lighting & Design	Light - Reyes Bridge	1,883.40
12/18/2025	119161	Southern California Edison	Utiliieis 11/03/25 - 12/03/2025	719.41
12/18/2025	119162	Southern California Gas Comp	Utilities 11/04/25 - 12/05/2025	1,802.41
12/18/2025	119163	Staples	Office Supplies	124.63
12/18/2025	119164	Terry Dipple, Inc.	COG Services Dec 2025	17,218.00
12/18/2025	119165	Unisource Solutions Inc	New Equipment - Event Center	6,770.86
12/18/2025	119166	Venco Electric Inc.	Light Replacement Rec Center	4,830.00
12/18/2025	119167	Ventura Transit Systems	Transporation 11/03/2025 Senior Excursion	4,230.00
12/18/2025	119168	Vivian Rescalvo	COG Services Dec 2025	13,262.58
12/18/2025	119169	West Coast Arborists, Inc	Tree Maintenance	4,834.30
			Total	1,333,881.23
12/18/2025	ACH Payment	Spare Labs, Inc	Spare Base Platform	21,701.46
			Grand Total	1,355,582.69
12/26/2025		Payroll December 2025	Payroll & Vendor Payments	315,032.64
01/08/2026	119174	ACT, A Div of Cherokee Chemical Co., Inc	Water Treatment Dec 2025	340.00
01/08/2026	119175	All City Management	Crossing Guard Service Dec 2025	9,823.49
01/08/2026	119176	ASCAP	License Fee 01/1/2026 - 11/30/2026	455.08
01/08/2026	119177	Base Hill, Inc.	Cleaning Service - Nov Extra Work	4,306.65
01/08/2026	119178	Brightview Landscape Services	Landscape Services Dec 2025	22,203.71
01/08/2026	119179	Chabad Of The Conejo	Security Deposit Refund	1,000.00
01/08/2026	119180	Create Studio	Instructor Payment - Camp Create	1,463.00
01/08/2026	119181	Direct Tv	Cable Service Jan 2026	59.99
01/08/2026	119182	Dish	Rec Center Cable Services 01/03/26 - 02/02/26	163.73
01/08/2026	119183	Dudek	Professional Services 7/1/25 - 08/22/25	5,148.75
01/08/2026	119184	Geodynamics	Geotechnical Services Oct 2025	3,191.25
01/08/2026	119185	Global Custom Security, Inc.	Quarterly Monitoring Fees	127.50
01/08/2026	119186	Gotem, Inc.	Rec Pest Control December 2026	495.00
01/08/2026	119187	GSG Protective Services	City Hall/Event Center Security Dec 2025	1,317.00
01/08/2026	119188	Hinderliter De Llamas & Assoc	Audit & Contract Serv - Sales Tax Q2 2025	1,997.81
01/08/2026	119189	Holiday Signs	Holiday Signs	64.35
01/08/2026	119190	Jeff Wachtel	Cert Bin/Vandalism Repairs	295.25
01/08/2026	119191	Kimley Horn & Assoc.	FY 25-26 Annual Pavement Rehab	14,350.00
01/08/2026	119192	Larry Walker Associates	Malibu Creek CIMP/Watershed Study Nov 2025	145,244.19
01/08/2026	119193	Los Angeles County Sheriff's	Sheriff Services Halloween & Reyes Adobe Days	9,120.52
01/08/2026	119195	Mackay Communications	Subscription Fees Nov 2025	952.17
01/08/2026	119196	Mdg Associates	Compliance Services - Morrison Park Nov 2025	984.00
01/08/2026	119197	Melisa Caric	GIS Contract Services Nov 2025	875.00
01/08/2026	119198	Michael Lang	Event Center Brochure	1,062.12
01/08/2026	119199	National Utility Locators LLC	Utility Locating Dec 2025	1,700.00
01/08/2026	119200	Ooma, Inc.	AirDial Services Dec 2025	586.08
01/08/2026	119201	Pegasus Studios	Broadcasting Services Dec 2025	2,800.00
01/08/2026	119202	Pitney Bowes	Postage Meter Lease 10/30/25 -1/29/26	465.98
01/08/2026	119203	Prudential Overall Supplies	Rec Center Mats	314.04
01/08/2026	119204	Ricoh USA, Inc	Copier Lease Jan 2026	818.14
01/08/2026	119205	Robert Half Inc.	Temp Services Dec 2025	2,192.58
01/08/2026	119206	Ronald F. Troncatty	Monthly Services -- December 2025	1,825.00
01/08/2026	119207	Round Star West LLC	Instructor Payment	2,016.00
01/08/2026	119208	SaberDome Corp	Monthly Services Jan 2026	12,060.20
01/08/2026	119209	SCA of CA, LLC	Street Sweeping Dec 2025	12,351.00
01/08/2026	119210	SecuriTech	Alarm Monitoring 01/01/26 - 04/01/26	150.00
01/08/2026	119211	Sesac	Music License 2026	641.00
01/08/2026	119212	Smith Pipe & Supply Inc.	Supplies	950.99
01/08/2026	119213	South Coast Lighting & Design	Signal Lens	2,186.22
01/08/2026	119214	Southern California Edison	Utilities 11/20/25 -- 12/21/25	24,864.29
01/08/2026	119215	Staples Business Advantage	Supplies	866.48
01/08/2026	119216	Sunbelt Controls	Quarterly Maintenance	1,486.50
01/09/2026	119217	**Void**		-
01/08/2026	119218	T-Mobile USA Inc.	Monthly Services 11/21/25 -12/20/25	31.35
01/08/2026	119219	Total Access Elevator LLC	Maintenance January 2026	155.00

01/08/2026	119220	Townsend Public Affairs, Inc.	Consulting Services December 2025	5,000.00
01/08/2026	119221	TPX Communications	Monthly Communication 12/23/25 – 01/22/26	804.86
01/08/2026	119222	Traffic Technologies	Supplies Farmers Market	4,153.91
01/08/2026	119223	Underground Service Alert	AGRH New Ticket Charges	28.00
01/08/2026	119224	Venco Electric Inc.	Electrical Repair/Rewiring - Rec Center	10,079.00
01/08/2026	119225	Video Voice Data Communications	EVCS Install	57,544.00
01/08/2026	119226	Wageworks	Healthcare Benefit Nov 2025	408.00
01/08/2026	119227	West Coast Arborists, Inc	ParkTree Maintenance 12/1/25 -12/15/251	2,673.14
01/08/2026	119228	Willdan	Water Quality Services Nov 2025	5,042.00
01/08/2026	119229	The Acorn Newspapers	City Ad - Recycle	580.00
01/09/2026	119230	Los Angeles County Sheriff Department	Wage Garnishment	760.74
01/09/2026	119231	Jessica Flores	Admin Support COG Dec 2025	3,000.00
			Total	<u>383,575.06</u>

1/9/2026	Payroll January 2026	Payroll & Vendor Payments	<u>208,323.90</u>
----------	----------------------	---------------------------	--------------------------

01/15/2026	119232	Access Corp	Storage Jan 2026	972.00
01/15/2026	119233	Andrew M. Merovich	Instructor Payment	1,397.20
01/15/2026	119234	AT&T	Internet 01/06/26 - 02/05/2026	203.30
01/15/2026	119235	At&t Mobility	IPAD Service Dec 2025	808.44
01/15/2026	119236	Brent Friedman	Reimburse for Fingerprinting	35.00
01/15/2026	119237	Brodersen Associates	Landscape Architectural Services Nov 2025	8,825.00
01/15/2026	119238	Bruce Fleck	Reimburse Special Senior Supplies	200.71
01/15/2026	119239	Burhenn & Gest LLP	Professional Services	2,112.00
01/15/2026	119240	Cal-State Site Services	Restroom Rentals - Morrison Park 1/13/26 - 2/09/26	427.93
01/15/2026	119241	Celeste Bird	Reimburse for photos - retirement gifts	54.82
01/15/2026	119242	David Landen	Refund Security Deposit & Rental Fees Event Cancel	1,875.75
01/15/2026	119243	ECO Friendly Millworks, Inc	Kitchen Laminate Repair - Event Center	450.00
01/15/2026	119244	Facilitron Inc.	Concert Band Rehearsals 01/27/26 - 03/03/2026	826.83
01/15/2026	119245	Fast Deer Bus Charter	Rose Parade Transportation 01/01/2026	3,174.00
01/15/2026	119246	Festival of Arts Laguna Beach	Excursion - Pageant of the Masters	4,758.00
01/15/2026	119247	Francesca Smith	Reimburse for Fingerprinting	50.00
01/15/2026	119248	Geodynamics	Geotechnical Review Dec 2025	3,422.50
01/15/2026	119249	Gotem, Inc.	Pest Control	310.00
01/15/2026	119250	Holly Anderson	Refund Class Cancellled 01/12/206	10.00
01/15/2026	119251	Jeff Ferrero	Refund ADU Covenant/Application Fee P1	740.00
01/15/2026	119252	Las Virgenes Municipal Water	Water Usage 11/19/25 -12/18/25	10,497.24
01/15/2026	119253	Laurence Levit	Refund Class Cancelled	60.00
01/15/2026	119254	m6 Consulting, Inc.	Building Inspection & Plan Check Services Dec 2025	94,438.97
01/15/2026	119255	Melisa Caric	GIS Contract Services Dec 2025	1,225.00
01/15/2026	119256	Michael Lang	Design & Print Posters	572.11
01/15/2026	119257	Rincon Consultants	Project Management 07/01/25 - 11/30/2025	206.50
01/15/2026	119258	Rrm Design Group	ADU 2025 Code Update Oct/Nov 2025	9,410.00
01/15/2026	119259	South Central Planning and Development Commission	Software License Fee Dec 2025	1,533.33
01/15/2026	119260	Southern California Edison	Utilities 12/04/25 - 01/05/2026	581.74
01/15/2026	119261	Staples Business Advantage	Office Supplies	34.68
01/15/2026	119262	Us Bank Corp. Payment System	City Credit Card Payment Jan 2026	16,955.12
01/15/2026	119263	Ventura Transit Systems	Excursion Transportation	4,860.00
01/15/2026	119264	West Coast Air Conditioning	Inspect & Service Heating/Air Conditioning	370.00
			Total	<u>171,398.17</u>

Demand Register No. 944

PASSED, APPROVED, AND ADOPTED this 28th day of January, 2026, by the following vote to wit:

AYES: (
NOES: (
ABSENT: (
ABSTAIN: (
)

Jeremy Wolf, Mayor

ATTEST:

Kimberly M. Rodrigues, MMC, City Clerk



REPORT TO CITY COUNCIL

DATE: JANUARY 28, 2026
TO: HONORABLE MAYOR AND MEMBERS OF THE CITY COUNCIL
FROM: NATHAN HAMBURGER, CITY MANAGER
BY: AMBER VICTORIA, MANAGEMENT ANALYST
RAMIRO ADEVA, ASSISTANT CITY MANAGER
SUBJECT: APPROVE REJECTION OF CLAIM FOR DAMAGES – JAMES AND CAROLINA DREWS

On January 7, 2026, the City of Agoura Hills received a claim for damages from Chang-Klein LLP on behalf of claimants James and Carolina Drews.

The claim was referred to Athens, the City's insurance adjusters, for review and investigation.

FISCAL IMPACT

There is no impact to the Fiscal Year 2025-26 adopted Budget.

RECOMMENDATION

It is recommended the City Council deny the claim for damages from claimants James and Carolina Drews c/o Chang-Klein LLP.



REPORT TO CITY COUNCIL

DATE: JANUARY 28, 2026

TO: HONORABLE MAYOR AND MEMBERS OF THE CITY COUNCIL

FROM: NATHAN HAMBURGER, CITY MANAGER

**BY: KELLY FISHER, DEPUTY DIRECTOR OF PUBLIC WORKS
CHARMAINE YAMBAO, DIRECTOR OF PUBLIC WORKS DIRECTOR / CITY ENGINEER**

**SUBJECT: APPROVE THIRD AMENDED AND RESTATED SEWER EXTENSION REIMBURSEMENT AGREEMENT
NO. 26-01 ON CHESEBRO ROAD**

In October 2005, property owners Susan and Kelly Morris of 5342 Chesebro Road completed a sewer extension of approximately 450 feet from Driver Avenue to their residence, as a result of a problematic septic sewer. The costs associated with this project included design, plan check review, permits, construction, and inspection of the extended sewer line. Since Mr. and Mrs. Morris' invitations to neighbors for participation and cost sharing were unsuccessful, the City Council approved the Morris' request for a Sewer Extension Reimbursement Agreement on February 22, 2006, for expenses incurred on the sewer line extension. The total cost of this project subject to the agreement was \$123,259.96, which excluded work performed on the Morris property.

As with previously approved sewer reimbursement agreements, the original termination date was set for fifteen (15) years from the date of execution by the City. Due to concerns from Mr. & Mrs. Morris that no property owners had yet to connect to the public sewer, they requested the City to amend the original agreement by extending the termination date an additional ten (10) years. The City Council approved Amended and Restated Sewer Extension Reimbursement Agreement No. 11-01 on November 9, 2011, which allowed the developer to request up to two (2) optional 5-year extensions subject to City Council approval.

On April 14, 2021, the City Council approved the Second Amended and Restated Sewer Extension Reimbursement Agreement 21-01, which extended the agreement to April 30, 2026.

To date, only one other property in the benefitted area has connected to the public sewer. With the agreement set to expire in the next few months, Mr. and Mrs. Morris are requesting approval of the second 5-year extension.

The proposed Third Amended and Restated Sewer Extension Reimbursement Agreement No. 26-01 would extend the term of the agreement to April 30, 2031. The original agreement included an annual 5% increase to the reimbursable construction costs, along with a 5% fee to the City for administering the agreement. As part of this amendment, a revised reimbursement schedule has been incorporated to reflect the fees that would be required to be collected during the extension period. All other terms of the original agreement are to remain the same as previously approved. This third amendment is the last of the two optional extensions allowed to the developer.

The proposed agreement has been reviewed by the City Attorney and approved as to form.

FISCAL IMPACT

The reimbursement schedule includes a 5% fee that is paid to the City for administering the agreement.

RECOMMENDATION

Staff respectfully recommends the City Council approve Third Amended and Restated Sewer Extension Reimbursement Agreement No. 26-01.

Attachments

[Third Amended and Restated Sewer Extension Reimbursement Agreement 26-01.pdf](#)

[Morris Sewer Reimbursement Agreement-2026 Request for Extension Letter.pdf](#)

RECORDING REQUESTED BY:
City of Agoura Hills
30001 Ladyface Court
Agoura Hills, California 91301

WHEN RECORDED MAIL TO:
City Clerk
City of Agoura Hills
30001 Ladyface Court
Agoura Hills, California 91301

(Space Above this Line for Recorder's Use Only)

CITY OF AGOURA HILLS
THIRD AMENDED AND RESTATED SEWER EXTENSION
REIMBURSEMENT AGREEMENT NO. 26-01

THIS AGREEMENT is made and entered into by and between the CITY OF AGOURA HILLS, a municipal corporation ("CITY") and SUSAN & KELLY MORRIS, ("DEVELOPER").

RECITALS

A. DEVELOPER owns that certain real PROPERTY commonly known as 5342 Chesebro Road and more particularly described in Exhibit "A" (Description of Developer's Property and "A-1" (Site Map) attached and incorporated by this reference ("PROPERTY").

B. In the interest of public health and safety, DEVELOPER desired to provide sanitary sewer service to the PROPERTY by constructing certain sewer improvements ("FACILITIES") as generally described in Exhibit "B" (Area of Benefit, Benefitted Properties, and Per-Connection Share of Costs) attached and incorporated by this reference, and as more particularly identified in Improvement Plans for PC 05-01 / C02-505-01 on file with CITY.

C. DEVELOPER has constructed said FACILITIES at DEVELOPER'S sole cost and expense, which provide sanitary sewer service for DEVELOPER'S PROPERTY and six other properties tributary to the proposed FACILITIES. The benefitted area is delineated on the map attached hereto as Exhibit "B-1" (Map of Benefitted Properties).

D. DEVELOPER desires to be reimbursed for the additional cost of FACILITIES necessary to be constructed to serve properties other than DEVELOPER'S PROPERTY.

E. It is in the public interest and convenience that the CITY obtain sanitary sewer service for said other properties which are within the area tributary to said FACILITIES.

F. On May 15, 2006, the CITY and DEVELOPER entered into that certain agreement entitled "SEWER EXTENSION REIMBURSEMENT AGREEMENT No. 06-01."

G. On March 4, 2012, the CITY and DEVELOPER entered into that certain agreement entitled "AMENDED AND RESTATED SEWER EXTENSION REIMBURSEMENT AGREEMENT No. 11-01."

H. On April 9, 2021, the CITY and DEVELOPER entered into that certain agreement entitled "SECOND AMENDED AND RESTATED SEWER EXTENSION REIMBURSEMENT AGREEMENT No. 21-01."

I. The CITY and DEVELOPER desire to amend and replace SECOND AMENDED AND RESTATED SEWER EXTENSION REIMBURSEMENT AGREEMENT No. 21-01 by entering into this THIRD AMENDED AND RESTATED SEWER EXTENSION REIMBURSEMENT No. 26-01 to extend the term of the Agreement and allow for one optional five (5) year extension to the term of the Agreement.

NOW THEREFORE, CITY and DEVELOPER agree as follows:

1. CONSTRUCTION OF FACILITIES

DEVELOPER HAS CONSTRUCTED, AT DEVELOPER'S sole expense, the FACILITIES referenced above in paragraph B of the Recitals, in compliance with all applicable codes, ordinances, plans, specifications, and agreements relating to such FACILITIES.

2. ACCEPTANCE AND OWNERSHIP OF THE FACILITIES

The work involving the FACILITIES was constructed under the supervision of and to the satisfaction of the CITY, and is hereby deemed approved and accepted as complete by the City Council. Said FACILITIES are hereby dedicated to CITY by the DEVELOPER and the CITY herein accepts said dedication.

3. REIMBURSABLE CONSTRUCTION COSTS

a. DEVELOPER has submitted to the City Engineer copies of invoices, payment vouchers and other documentation, as reasonably requested, in order to verify the actual total cost of construction, including related engineering and carrying costs.

b. The total cost necessarily incurred by the DEVELOPER in the construction of the FACILITIES has been verified by the City Engineer based upon the documentation submitted pursuant to subsection "3.a." above. The City Engineer has submitted such costs in Exhibit "B", attached hereto and likewise inserted in the per-connection cost of the FACILITIES, subject to reimbursement. A copy of Exhibit "B", as so completed, shall be transmitted to the DEVELOPER by the City Engineer.

c. For the purposes of this Agreement, the term "Reimbursable Construction Cost" shall mean the total cost amount listed in Exhibit "B", less DEVELOPER'S share of the total construction cost.

4. COLLECTION AND PAYMENT OF REIMBURSABLE CONSTRUCTION COSTS

a. CITY shall use all reasonable efforts to collect the applicable per-connection pro-rata share of the reimbursable construction costs of the subject FACILITIES prior to any subdivision of the properties or parcels identified in Exhibit "B", the issuance of a building permit, or

connection to the FACILITIES, whichever may first occur; provided, however, that neither the CITY, its general funds, nor its officers, agents or employees shall be in any manner responsible for, or obligated to, pay any monies promised to be paid under this Agreement.

b. The per-connection cost of the FACILITIES, as determined by the City Engineer, and as set forth in Exhibit "B" attached hereto, shall be adjusted by the City Engineer at the time reimbursable construction costs are collected pursuant to subsection "4.a." above. Such adjustment shall be computed as a five percent (5%) annual increase over the construction cost as set forth in Exhibit "C" (Annual 5% Adjustment in Reimbursable Construction Costs) attached hereto. The adjusted per-connection cost of the FACILITIES shall constitute the amount subject to collection and reimbursement by the CITY to the DEVELOPER.

c. Prior to the payment of any reimbursable construction costs by CITY to DEVELOPER, CITY shall collect an administrative fee to defray the costs incurred by the CITY in monitoring, computing, collecting, and disbursing such reimbursable construction costs. Said fee shall be computed as five percent (5%) of the adjusted per-connection cost of the subject FACILITIES pursuant to subsection "4.b." above. Said administrative fee shall be paid by the party applying to connect to the FACILITIES. The CITY shall not be entitled to collect administrative fees from reimbursable costs owed to DEVELOPER.

d. Following collection of any reimbursable construction costs pursuant to subsection "4.a." above, the CITY shall transmit same to the DEVELOPER, or to any approved assignee, at the address specified in accordance with this Agreement, subject, however, to the provisions of subsection "4.c." above.

5. NOTICES AND PAYMENTS

All written notices and payments to be given or made under this Agreement shall be transmitted by personal delivery or by mail. Payments to DEVELOPER shall be made by CITY check or warrant payable to Susan and Kelly Morris and shall be the responsibility of same to distribute such funds as may be appropriate to other parties involved in this development.

Notices or payments given or made by mail shall be addressed as follows:

IF TO THE CITY:

Director of Public Works
City of Agoura Hills
Public Works Department
30001 Ladyface Court
Agoura Hills, CA 91301

IF TO THE DEVELOPER:

Susan and Kelly Morris
5342 Chesebro Road
Agoura Hills, CA 91301

When so addressed, notices or payments shall be deemed given or made upon deposit in the United States Mail, postage prepaid. In all other instances, notices or payments shall be deemed given or made at the time of actual delivery. Changes may be made in the names of persons to

whom notices or payments are to be given or made, or in the addresses to which notices or payments are to be given or made, by the giving of notice pursuant to this section.

6. NO ASSIGNMENTS

Neither party may assign or delegate any of its rights or obligations under this Agreement without first obtaining the written consent of the other party.

7. ENTIRE AGREEMENT

This Agreement sets forth the entire agreement between the parties, and this Agreement supersedes all prior negotiations and terminates all prior agreements with respect to the subject matter hereof. With the exception of the insertions or amendments provided for under Section "3.b." hereof, this Agreement shall not be amended or modified except in writing, signed by the parties hereto.

8. FURTHER ACTION

The parties agree to take all further action and to execute all further documents as may be necessary or desirable to effectuate the intent of the provisions of this Agreement.

9. APPLICABLE LAW

This Agreement shall be governed in all respects, whether as to validity, construction, capacity, performance or otherwise, by the laws of the State of California.

10. MULTIPLE COUNTERPARTS

This Agreement may be executed in one or more counterparts, each of which shall be deemed an original, and all of which together shall constitute one and the same instrument.

11. EFFECTIVE DATE AND TERMS OF THE AGREEMENT

a. This Agreement shall become effective and commence as of the date set forth below on which the last of the parties, whether CITY or DEVELOPER, executes said Agreement.

b. From its effective date, this Agreement shall continue in full force and effect until April 30, 2031, unless terminated sooner, upon receipt by DEVELOPER of all reimbursable construction costs provided for herein.

c. In no event shall this Agreement be extended beyond April 30, 2031.

d. Upon termination, this Agreement shall be of no further force or effect, except with regard to accrued obligations, and the CITY shall be released from all further claims, duties, and obligations hereunder.

IN WITNESS WHEREOF, the parties hereto have caused this Agreement to be executed and attested by their respective officers thereunto duly authorized.

ATTEST:

CITY OF AGOURA HILLS

By: _____
KIMBERLY RODRIGUES, CITY CLERK

By: _____
JEREMY WOLF, MAYOR

By: _____
SUSAN MORRIS, DEVELOPER

Dated: _____

By: _____
KELLY MORRIS, DEVELOPER

Dated: _____

THIRD AMENDED AND RESTATED SEWER EXTENSION
REIMBURSEMENT AGREEMENT NO. 26-01

EXHIBIT "A"

DESCRIPTION OF DEVELOPER'S PROPERTY

DEVELOPER'S PROPERTY is described as follows:

<u>ADDRESS</u>	<u>TRACT</u>	<u>BLOCK</u>	<u>LOT</u>	<u>APN</u>
5342 Chesebro Road	8451	4	8	2052-007-008

THIRD AMENDED AND RESTATED SEWER EXTENSION
REIMBURSEMENT AGREEMENT NO. 26-01

EXHIBIT "A-1"

SITE MAP



THIRD AMENDED AND RESTATED SEWER EXTENSION
REIMBURSEMENT AGREEMENT NO. 26-01

EXHIBIT "B"

AREA OF BENEFIT, BENEFITTED PROPERTIES, AND
PER-CONNECTION SHARE OF COSTS

1. BENEFITTED AREA

A. A map delineating the benefitted area is attached hereto, marked Exhibit "B-1", and incorporated herein by this reference

B. The total number of potential connections in the benefitted area, including the acreage of the PROPERTY owned by the DEVELOPER is, SEVEN (7) .
is _____

2. PARCELS OR PROPERTIES WITHIN THE BENEFITTED AREA

The following parcels or properties (including the DEVELOPER'S PROPERTY), the legal description of which is more fully set forth in Exhibit "B-1", attached hereto and incorporated herein by this reference, are within the benefitted area:

<u>ADDRESS</u>	<u>TRACT</u>	<u>BLOCK</u>	<u>LOT</u>	<u>APN</u>
5306 Chesebro Road	8451	4	18	2052-008-024
5312 Chesebro Road	8451	4	13	2052-008-001
5320 Chesebro Road	8451	4	12	2052-007-011
5324 Chesebro Road	8451	4	11	2052-007-010
5326 Chesebro Road	8451	4	10	2052-007-010
5330 Chesebro Road	8451	4	9	2052-007-009
5342 Chesebro Road*	8451	4	8	2052-007-008

*DEVELOPER'S PROPERTY

3. TOTAL REIMBURSABLE CONSTRUCTION COSTS

The maximum total amount of FACILITIES construction costs eligible for reimbursement pursuant to this Agreement (excluding that amount attributable to the DEVELOPER'S parcels or Properties) is \$123,260.00 .

4. PER-CONNECTION COST OF THE FACILITIES

The per-connection cost of the subject FACILITIES is \$17,609.00 , which is the amount that shall be subject to reimbursement in accordance with the terms and provisions of this Agreement. This amount is calculated as of April 26, 2006.

THIRD AMENDED AND RESTATED SEWER EXTENSION
REIMBURSEMENT AGREEMENT NO. 26-01

EXHIBIT "B-1"

MAP OF BENEFITTED AREA

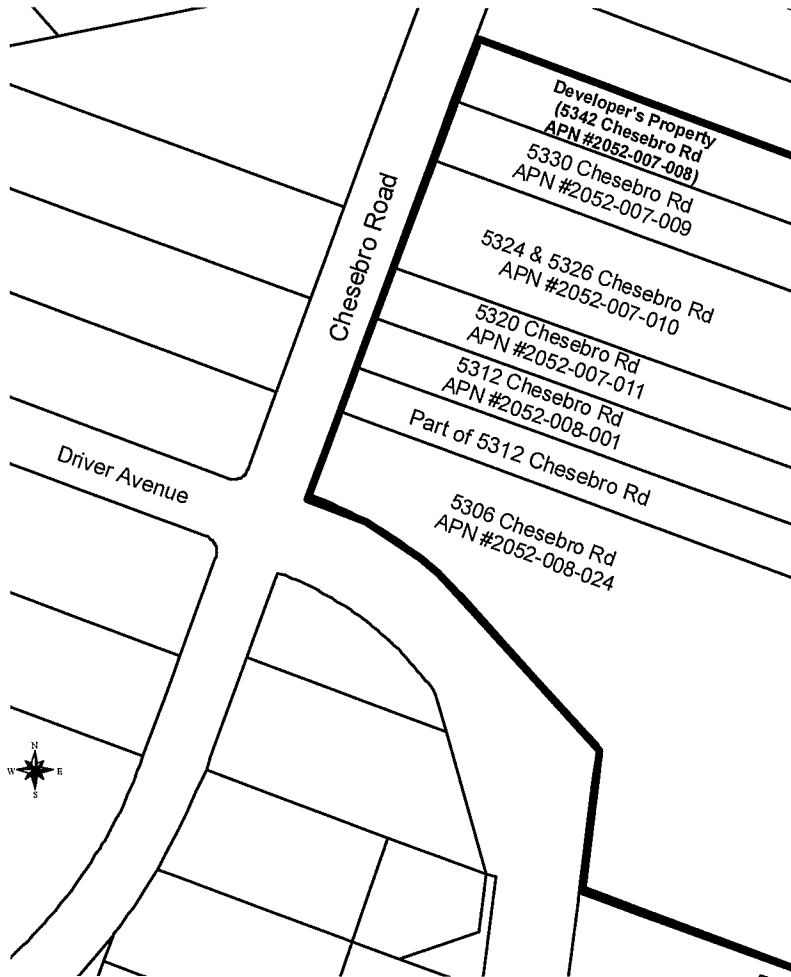

THIRD AMENDED AND RESTATED SEWER EXTENSION
REIMBURSEMENT AGREEMENT NO. 26-01

EXHIBIT "B-2"

LEGAL DESCRIPTION OF BENEFITTED PARCELS OR PROPERTIES

The lots or parcels included within Sewer Reimbursement District No. 06-01 (between the CITY OF AGOURA HILLS and SUSAN & KELLY MORRIS) consists of the following:

Lots 8, 9, 10, 11, 12, 182, and 18 of Block 4, Tract 8451 and filed in Book 104, pages 79 to 90 of Maps of All Records of Los Angeles County.

THIRD AMENDED AND RESTATED SEWER EXTENSION
REIMBURSEMENT AGREEMENT NO. 26-01

EXHIBIT "C"

Annual 5% Adjustment in Reimbursable Construction Costs

EXHIBIT "C"

ANNUAL 5% ADJUSTMENT IN REIMBURSABLE CONSTRUCTION COSTS
AGOURA HILLS REIMBURSEMENT AGREEMENT NO 26-01
 City Council Approval January 28, 2026

Date	Reimbursement Amt.	City Fee	Date	Reimbursement Amt.	City Fee	Date	Reimbursement Amt.	City Fee
May, 2006	\$ 17,609.00	880.45	May, 2011	\$ 22,598.66	1,129.93	May, 2016	\$ 29,002.19	1,450.11
June, 2006	\$ 17,682.37	884.12	June, 2011	\$ 22,692.82	1,134.64	June, 2016	\$ 29,123.03	1,456.15
July, 2006	\$ 17,756.05	887.80	July, 2011	\$ 22,787.38	1,139.37	July, 2016	\$ 29,244.38	1,462.22
August, 2006	\$ 17,830.03	891.50	August, 2011	\$ 22,882.32	1,144.12	August, 2016	\$ 29,366.23	1,468.31
September, 2006	\$ 17,904.32	895.22	September, 2011	\$ 22,977.67	1,148.88	September, 2016	\$ 29,488.59	1,474.43
October, 2006	\$ 17,978.92	898.95	October, 2011	\$ 23,073.41	1,153.67	October, 2016	\$ 29,611.46	1,480.57
November, 2006	\$ 18,053.84	902.69	November, 2011	\$ 23,169.55	1,158.48	November, 2016	\$ 29,734.84	1,486.74
December, 2006	\$ 18,129.06	906.45	December, 2011	\$ 23,266.09	1,163.30	December, 2016	\$ 29,858.73	1,492.94
January, 2007	\$ 18,204.60	910.23	January, 2012	\$ 23,363.03	1,168.15	January, 2017	\$ 29,983.15	1,499.16
February, 2007	\$ 18,280.45	914.02	February, 2012	\$ 23,460.38	1,173.02	February, 2017	\$ 30,108.08	1,505.40
March, 2007	\$ 18,356.62	917.83	March, 2012	\$ 23,558.13	1,177.91	March, 2017	\$ 30,233.53	1,511.68
April, 2007	\$ 18,433.11	921.66	April, 2012	\$ 23,656.29	1,182.81	April, 2017	\$ 30,359.50	1,517.97
May, 2007	\$ 18,509.91	925.50	May, 2012	\$ 23,754.85	1,187.74	May, 2017	\$ 30,486.00	1,524.30
June, 2007	\$ 18,587.03	929.35	June, 2012	\$ 23,853.83	1,192.69	June, 2017	\$ 30,613.02	1,530.65
July, 2007	\$ 18,664.48	933.22	July, 2012	\$ 23,953.22	1,197.66	July, 2017	\$ 30,740.58	1,537.03
August, 2007	\$ 18,742.25	937.11	August, 2012	\$ 24,053.03	1,202.65	August, 2017	\$ 30,868.66	1,543.43
September, 2007	\$ 18,820.34	941.02	September, 2012	\$ 24,153.25	1,207.66	September, 2017	\$ 30,997.28	1,549.86
October, 2007	\$ 18,898.76	944.94	October, 2012	\$ 24,253.89	1,212.69	October, 2017	\$ 31,126.44	1,556.32
November, 2007	\$ 18,977.50	948.88	November, 2012	\$ 24,354.95	1,217.75	November, 2017	\$ 31,256.13	1,562.81
December, 2007	\$ 19,056.58	952.83	December, 2012	\$ 24,456.42	1,222.82	December, 2017	\$ 31,386.36	1,569.32
January, 2008	\$ 19,135.98	956.80	January, 2013	\$ 24,558.33	1,227.92	January, 2018	\$ 31,517.14	1,575.86
February, 2008	\$ 19,215.71	960.79	February, 2013	\$ 24,660.65	1,233.03	February, 2018	\$ 31,648.46	1,582.42
March, 2008	\$ 19,295.78	964.79	March, 2013	\$ 24,763.41	1,238.17	March, 2018	\$ 31,780.33	1,589.02
April, 2008	\$ 19,376.18	968.81	April, 2013	\$ 24,866.59	1,243.33	April, 2018	\$ 31,912.75	1,595.64
May, 2008	\$ 19,456.91	972.85	May, 2013	\$ 24,970.20	1,248.51	May, 2018	\$ 32,045.72	1,602.29
June, 2008	\$ 19,537.98	976.90	June, 2013	\$ 25,074.24	1,253.71	June, 2018	\$ 32,179.24	1,608.96
July, 2008	\$ 19,619.39	980.97	July, 2013	\$ 25,178.72	1,258.94	July, 2018	\$ 32,313.32	1,615.67
August, 2008	\$ 19,701.14	985.06	August, 2013	\$ 25,283.63	1,264.18	August, 2018	\$ 32,447.96	1,622.40
September, 2008	\$ 19,783.23	989.16	September, 2013	\$ 25,388.98	1,269.45	September, 2018	\$ 32,583.16	1,629.16
October, 2008	\$ 19,865.66	993.28	October, 2013	\$ 25,494.76	1,274.74	October, 2018	\$ 32,718.92	1,635.95
November, 2008	\$ 19,948.43	997.42	November, 2013	\$ 25,600.99	1,280.05	November, 2018	\$ 32,855.25	1,642.76
December, 2008	\$ 20,031.55	1,001.58	December, 2013	\$ 25,707.66	1,285.38	December, 2018	\$ 32,992.15	1,649.61
January, 2009	\$ 20,115.01	1,005.75	January, 2014	\$ 25,814.78	1,290.74	January, 2019	\$ 33,129.62	1,656.48
February, 2009	\$ 20,198.83	1,009.94	February, 2014	\$ 25,922.34	1,296.12	February, 2019	\$ 33,267.66	1,663.38
March, 2009	\$ 20,282.99	1,014.15	March, 2014	\$ 26,030.35	1,301.52	March, 2019	\$ 33,406.27	1,670.31
April, 2009	\$ 20,367.50	1,018.37	April, 2014	\$ 26,138.81	1,306.94	April, 2019	\$ 33,545.47	1,677.27
May, 2009	\$ 20,452.36	1,022.62	May, 2014	\$ 26,247.72	1,312.39	May, 2019	\$ 33,685.24	1,684.26
June, 2009	\$ 20,537.58	1,026.88	June, 2014	\$ 26,357.09	1,317.85	June, 2019	\$ 33,825.59	1,691.28
July, 2009	\$ 20,623.16	1,031.16	July, 2014	\$ 26,466.91	1,323.35	July, 2019	\$ 33,966.53	1,698.33
August, 2009	\$ 20,709.09	1,035.45	August, 2014	\$ 26,577.18	1,328.86	August, 2019	\$ 34,108.06	1,705.40
September, 2009	\$ 20,795.37	1,039.77	September, 2014	\$ 26,687.92	1,334.40	September, 2019	\$ 34,250.18	1,712.51
October, 2009	\$ 20,882.02	1,044.10	October, 2014	\$ 26,799.12	1,339.96	October, 2019	\$ 34,392.89	1,719.64
November, 2009	\$ 20,969.03	1,048.45	November, 2014	\$ 26,910.79	1,345.54	November, 2019	\$ 34,536.19	1,726.81
December, 2009	\$ 21,056.40	1,052.82	December, 2014	\$ 27,022.91	1,351.15	December, 2019	\$ 34,680.09	1,734.00
January, 2010	\$ 21,144.14	1,057.21	January, 2015	\$ 27,135.51	1,356.78	January, 2020	\$ 34,824.59	1,741.23
February, 2010	\$ 21,232.24	1,061.61	February, 2015	\$ 27,248.57	1,362.43	February, 2020	\$ 34,969.69	1,748.48
March, 2010	\$ 21,320.70	1,066.04	March, 2015	\$ 27,362.11	1,368.11	March, 2020	\$ 35,115.40	1,755.77
April, 2010	\$ 21,409.54	1,070.48	April, 2015	\$ 27,476.12	1,373.81	April, 2020	\$ 35,261.72	1,763.09
May, 2010	\$ 21,498.75	1,074.94	May, 2015	\$ 27,590.60	1,379.53	May, 2020	\$ 35,408.64	1,770.43
June, 2010	\$ 21,588.32	1,079.42	June, 2015	\$ 27,705.56	1,385.28	June, 2020	\$ 35,556.18	1,777.81
July, 2010	\$ 21,678.28	1,083.91	July, 2015	\$ 27,821.00	1,391.05	July, 2020	\$ 35,704.33	1,785.22
August, 2010	\$ 21,768.60	1,088.43	August, 2015	\$ 27,936.92	1,396.85	August, 2020	\$ 35,853.09	1,792.65
September, 2010	\$ 21,859.30	1,092.97	September, 2015	\$ 28,053.33	1,402.67	September, 2020	\$ 36,002.48	1,800.12
October, 2010	\$ 21,950.38	1,097.52	October, 2015	\$ 28,170.22	1,408.51	October, 2020	\$ 36,152.49	1,807.62
November, 2010	\$ 22,041.84	1,102.09	November, 2015	\$ 28,287.59	1,414.38	November, 2020	\$ 36,303.13	1,815.16
December, 2010	\$ 22,133.69	1,106.68	December, 2015	\$ 28,405.46	1,420.27	December, 2020	\$ 36,454.39	1,822.72
January, 2011	\$ 22,225.91	1,111.30	January, 2016	\$ 28,523.81	1,426.19	January, 2021	\$ 36,606.28	1,830.31
February, 2011	\$ 22,318.52	1,115.93	February, 2016	\$ 28,642.66	1,432.13	February, 2021	\$ 36,758.81	1,837.94
March, 2011	\$ 22,411.51	1,120.58	March, 2016	\$ 28,762.01	1,438.10	March, 2021	\$ 36,911.97	1,845.60
April, 2011	\$ 22,504.89	1,125.24	April, 2016	\$ 28,881.85	1,444.09	April, 2021	\$ 37,065.77	1,853.29

Date	Reimbursement Amt.	City Fee
May, 2021	\$ 37,220.21	1,861.01
June, 2021	\$ 37,375.30	1,868.76
July, 2021	\$ 37,531.03	1,876.55
August, 2021	\$ 37,687.41	1,884.37
September, 2021	\$ 37,844.44	1,892.22
October, 2021	\$ 38,002.12	1,900.11
November, 2021	\$ 38,160.46	1,908.02
December, 2021	\$ 38,319.47	1,915.97
January, 2022	\$ 38,479.13	1,923.96
February, 2022	\$ 38,639.46	1,931.97
March, 2022	\$ 38,800.46	1,940.02
April, 2022	\$ 38,962.13	1,948.11
May, 2022	\$ 39,124.47	1,956.22
June, 2022	\$ 39,287.49	1,964.37
July, 2022	\$ 39,451.19	1,972.56
August, 2022	\$ 39,615.57	1,980.78
September, 2022	\$ 39,780.63	1,989.03
October, 2022	\$ 39,946.38	1,997.32
November, 2022	\$ 40,112.83	2,005.64
December, 2022	\$ 40,279.96	2,014.00
January, 2023	\$ 40,447.80	2,022.39
February, 2023	\$ 40,616.33	2,030.82
March, 2023	\$ 40,785.56	2,039.28
April, 2023	\$ 40,955.50	2,047.78
May, 2023	\$ 41,126.15	2,056.31
June, 2023	\$ 41,297.51	2,064.88
July, 2023	\$ 41,469.58	2,073.48
August, 2023	\$ 41,642.37	2,082.12
September, 2023	\$ 41,815.88	2,090.79
October, 2023	\$ 41,990.12	2,099.51
November, 2023	\$ 42,165.07	2,108.25
December, 2023	\$ 42,340.76	2,117.04
January, 2024	\$ 42,517.18	2,125.86
February, 2024	\$ 42,694.34	2,134.72
March, 2024	\$ 42,872.23	2,143.61
April, 2024	\$ 43,050.86	2,152.54
May, 2024	\$ 43,230.24	2,161.51
June, 2024	\$ 43,410.37	2,170.52
July, 2024	\$ 43,591.25	2,179.56
August, 2024	\$ 43,772.88	2,188.64
September, 2024	\$ 43,955.26	2,197.76
October, 2024	\$ 44,138.41	2,206.92
November, 2024	\$ 44,322.32	2,216.12
December, 2024	\$ 44,507.00	2,225.35
January, 2025	\$ 44,692.44	2,234.62
February, 2025	\$ 44,878.66	2,243.93
March, 2025	\$ 45,065.66	2,253.28
April, 2025	\$ 45,253.43	2,262.67
May, 2025	\$ 45,441.98	2,272.10
June, 2025	\$ 45,631.33	2,281.57
July, 2025	\$ 45,821.46	2,291.07
August, 2025	\$ 46,012.38	2,300.62
September, 2025	\$ 46,204.10	2,310.20
October, 2025	\$ 46,396.61	2,319.83
November, 2025	\$ 46,589.93	2,329.50
December, 2025	\$ 46,784.06	2,339.20
January, 2026	\$ 46,978.99	2,348.95
February, 2026	\$ 47,174.74	2,358.74
March, 2026	\$ 47,371.30	2,368.56
April, 2026	\$ 47,568.68	2,378.43

Date	Reimbursement Amt.	City Fee
May, 2026	\$ 47,766.88	2,388.34
June, 2026	\$ 47,965.91	2,398.30
July, 2026	\$ 48,165.77	2,408.29
August, 2026	\$ 48,366.46	2,418.32
September, 2026	\$ 48,567.99	2,428.40
October, 2026	\$ 48,770.35	2,438.52
November, 2026	\$ 48,973.56	2,448.68
December, 2026	\$ 49,177.62	2,458.88
January, 2027	\$ 49,382.53	2,469.13
February, 2027	\$ 49,588.29	2,479.41
March, 2027	\$ 49,794.91	2,489.75
April, 2027	\$ 50,002.38	2,500.12
May, 2027	\$ 50,210.73	2,510.54
June, 2027	\$ 50,419.94	2,521.00
July, 2027	\$ 50,630.02	2,531.50
August, 2027	\$ 50,840.98	2,542.05
September, 2027	\$ 51,052.82	2,552.64
October, 2027	\$ 51,265.54	2,563.28
November, 2027	\$ 51,479.14	2,573.96
December, 2027	\$ 51,693.64	2,584.68
January, 2028	\$ 51,909.03	2,595.45
February, 2028	\$ 52,125.32	2,606.27
March, 2028	\$ 52,342.51	2,617.13
April, 2028	\$ 52,560.60	2,628.03
May, 2028	\$ 52,779.60	2,638.98
June, 2028	\$ 52,999.52	2,649.98
July, 2028	\$ 53,220.35	2,661.02
August, 2028	\$ 53,442.10	2,672.11
September, 2028	\$ 53,664.78	2,683.24
October, 2028	\$ 53,888.38	2,694.42
November, 2028	\$ 54,112.91	2,705.65
December, 2028	\$ 54,338.39	2,716.92
January, 2029	\$ 54,564.80	2,728.24
February, 2029	\$ 54,792.15	2,739.61
March, 2029	\$ 55,020.45	2,751.02
April, 2029	\$ 55,249.70	2,762.49
May, 2029	\$ 55,479.91	2,774.00
June, 2029	\$ 55,711.07	2,785.55
July, 2029	\$ 55,943.20	2,797.16
August, 2029	\$ 56,176.30	2,808.82
September, 2029	\$ 56,410.37	2,820.52
October, 2029	\$ 56,645.41	2,832.27
November, 2029	\$ 56,881.43	2,844.07
December, 2029	\$ 57,118.44	2,855.92
January, 2030	\$ 57,356.43	2,867.82
February, 2030	\$ 57,595.42	2,879.77
March, 2030	\$ 57,835.40	2,891.77
April, 2030	\$ 58,076.38	2,903.82
May, 2030	\$ 58,318.37	2,915.92
June, 2030	\$ 58,561.36	2,928.07
July, 2030	\$ 58,805.36	2,940.27
August, 2030	\$ 59,050.39	2,952.52
September, 2030	\$ 59,296.43	2,964.82
October, 2030	\$ 59,543.50	2,977.17
November, 2030	\$ 59,791.60	2,989.58
December, 2030	\$ 60,040.73	3,002.04
January, 2031	\$ 60,290.90	3,014.54
February, 2031	\$ 60,542.11	3,027.11
March, 2031	\$ 60,794.37	3,039.72
April, 2031	\$ 61,047.68	3,052.38

Susan & Kelly Morris
5342 Chesebro Road
Agoura Hills, CA 91301
Srmorris27@gmail.com

Oct 23, 2025

Re: Request for Extension of Sewer Reimbursement Agreement of 2006

To: The City of Agoura Hills

Please allow this letter to serve as our formal request for an extension of our Sewer Reimbursement Agreement. The current agreement with approved extensions expires on April 30, 2026. However, pursuant to paragraph 11C of the original Reimbursement Agreement, we are allowed an additional extension for an additional five years to continue the Reimbursement Agreement until April 30, 2031.

To provide you with a very brief history: sometime in 2004 our septic system began to fail. We explored all of our options---- repair the existing system, install a new septic system or connect to the main sewer line on Driver Ave. Repair was not an option as we would no longer be able to have the system in the front of our home. A new septic system would require a pump to the back of our property, and although this was less expensive than connection to the sewer, we felt the cleanest, healthiest and most environmentally appropriate choice was to connect to the sewer.

This was no small feat; it took us over a year to finally get approval from the City of Agoura Hills to bring the sewer line down Chesebro Road. During this time we suffered immensely with a failing septic system. We had to pay for all of the costs and coordinate the entire construction project, including repaving a portion of Chesebro Road, with no assistance from the City as they had provided for the residents on Driver Ave. We paid out of pocket well over \$150,000 to have the sewer line constructed on Chesebro Road. However, out of this \$150,000 only approximately \$123,000 of hard construction costs were considered reimbursable by the City.

Since installation, to date, only one homeowner has connected and we would still like the opportunity to recover as much as possible of the costs that we had to lay out. Most homeowners will not consider connecting until their own septic systems fail. In the interest of fairness and to allow us to recoup a portion of our out of pocket expenses, we are asking that this agreement be extended. This will cost the City nothing. No one will lose by extending this agreement, and the City still retains its 5% administrative fee.

As the City would not allow us reimbursement for our permit fees, design fees, engineering fees and the cost of the traffic management plan that the City required, at the very least, we would hope you can see why we, as an individual homeowners, should not have to shoulder the entire burden for the sewer line.

Having to pay over \$150,000 for the construction of the sewer line was a significant financial burden for our family. Therefore, we hope in all fairness that you will find it reasonable to allow us to recover at least some of the \$123,000 of our hard construction costs by extending our current agreement.

Thank you for your consideration and please note we request your written confirmation of your agreement to extend our Reimbursement Agreement, pursuant to the terms therein.

Respectfully Submitted,

Susan R. Morris

Kelly M. Morris



REPORT TO CITY COUNCIL

DATE: JANUARY 28, 2026
TO: HONORABLE MAYOR AND MEMBERS OF THE CITY COUNCIL
FROM: NATHAN HAMBURGER, CITY MANAGER
BY: KELLY FISHER, DEPUTY DIRECTOR OF PUBLIC WORKS
CHARMAINE YAMBAO, DIRECTOR OF PUBLIC WORKS DIRECTOR / CITY ENGINEER
SUBJECT: ADOPT ORDINANCE NO. 26-483, ADOPTING THE 2025 ENGINEERING AND TRAFFIC SURVEY

On January 14, 2026, the City Council waived full reading and introduced Ordinance No. 26-483, which adopts the 2025 Engineering and Traffic Survey (E&TS). The ordinance will amend prima facie speed limits on nine specific road segments of Agoura Road, Canwood Street, Driver Avenue/Palo Comado Canyon Road, Kanan Road, Reyes Adobe Road, and Cornell Road.

With City Council approval, staff will notify the Los Angeles County Sheriff's Department of the new speed limits. In addition, the E&TS will be available to the public for review on the City's website, or by contacting the Public Works Department.

The City would begin replacing the various speed limit signs thirty (30) days after the approval of the E&TS. AB 43 requires that drivers traveling 10 mph or less over the speed limit only be subject to a warning citation until 30 days after the lower speed limit is in effect. It is anticipated that the new speed limits would be fully enforceable by March 29, 2026.

FISCAL IMPACT

There are sufficient funds budgeted in the Fiscal Year 2025-26 Public Works Department's Traffic Signing Account (064-4510-5520.12) to fund the replacement of the speed limit signs.

RECOMMENDATION

Staff respectfully recommends the City Council adopt Ordinance No. 26-483, adopting the 2025 Engineering and Traffic Survey.

Attachments

[Ordinance No. 26-483 Amending and Declaring Prima Facie Speed Limits for Nine Specific Road Segments.pdf](#)

ORDINANCE NO. 26-483

AN ORDINANCE OF THE CITY COUNCIL OF THE CITY OF AGOURA HILLS, CALIFORNIA, AMENDING AND DECLARING PRIMA FACIE SPEED LIMITS FOR NINE SPECIFIC ROAD SEGMENTS OF AGOURA ROAD, CANWOOD STREET, DRIVER AVENUE/PALO COMADO CANYON ROAD, KANAN ROAD, REYES ADOBE ROAD AND CORNELL ROAD

WHEREAS, engineering and traffic surveys have been conducted on various streets within the City of Agoura Hills as required by provisions of the California Vehicle Code; and

WHEREAS, California Vehicle Code sections 22357 and 22358.8 provide that if the local authority determines, on a basis of a survey, that a speed higher or lower than the statutory speed limit would facilitate the orderly movement of vehicular traffic and would be reasonable and safe, the local authority may determine and declare a speed limit by ordinance; and

WHEREAS, the declared prima facie speed limits shall only be effective when appropriate signs giving notice thereof are erected upon the street and the limits shall not be revised except upon the basis of an engineering and traffic study; and

WHEREAS, an engineering and traffic survey was conducted by Kimley-Horn and Associates, Inc. in 2025; and

WHEREAS, on the basis of the survey, staff has determined that the adoption of the following recommended speed limits are reasonable and safe and will facilitate the orderly movement of vehicular traffic.

NOW, THEREFORE, THE CITY COUNCIL OF THE CITY OF AGOURA HILLS HEREBY ORDAINS AS FOLLOWS:

SECTION 1. The City Council makes the following findings in connection with the adoption of this Ordinance:

A. Section 22358.8 of the California Vehicle Code permits cities, after completing an engineering and traffic survey and finding that the speed limit is still more than is reasonable or safe, to retain the current speed limit or restore the immediately prior speed limit if that speed limit was established with an engineering and traffic study and if a registered engineer has evaluated the section of highway and determined that no additional general purpose lanes have been added to the roadway since completion of the traffic survey that established the prior speed limit.

B. Pursuant to California Vehicle Code 22358.8, the City of Agoura Hills performed an engineering and traffic survey entitled "2025 Engineering and Traffic Survey to Establish Speed Limits" conducted by Kimley-Horn and Associates, Inc. in April 2025 ("2025 Traffic Survey").

C. The 2025 Traffic Survey and roadway segment have been reviewed and evaluated by the City's Contract Traffic Engineer Matt Stewart ("Traffic Engineer"), a Registered Professional Engineer and Traffic Engineer in the State of California.

D. Based on the 2025 Traffic Survey, the City Council hereby finds that the speed limits on the following eight road segments are still more than are reasonable or safe: 1) Agoura Road between Reyes Adobe Road and Ladyface Court; 2) Agoura Road between Ladyface Court and Kanan Road; 3) Agoura Road between Cornell Road and Chesebro Road/Laura La Plante; 4) Agoura Road between Chesebro Road/Laura La Plante and Liberty Canyon Road; 5) Canwood Street between Derry Avenue and Chesebro Road; 6) Driver Avenue/Palo Comado Canyon Road between Argos Street and the 101 Freeway; 7) Kanan Road between Canwood Street and Agoura Road; and 8) Reyes Adobe Road between Lake Lindero Drive and the northern City limit; and

E. Given that the road segment of Cornell Road between Cornell Way and Agoura Road currently has no posted speed limit, based on the 2025 Traffic Survey, the City Council hereby finds that a speed limit of 35 miles per hour is the most appropriate to facilitate the orderly movement of traffic and is reasonable and safe.

SECTION 2. Based on the findings set forth in Section 1 of this Ordinance, the City Council of the City of Agoura Hills ("City Council") hereby adopts said 2025 Traffic Survey and adopts and enacts new speed limits on nine road segments described in Exhibit "A", attached hereto and incorporated by reference as though set forth in full, as recommended in Table 3 of the 2025 Traffic Survey .

SECTION 3. Pursuant to Vehicle Code Section 22358.8(c), the City shall issue only warning citations for violations exceeding the speed limit by 10 miles per hour or less for the first 30 days that the new, lower speed limit is in effect.

SECTION 4. CALIFORNIA ENVIRONMENTAL QUALITY ACT (CEQA). Pursuant to Section 15060(c)(2) of the California CEQA Guidelines, the City Council finds that this Ordinance will not result in a direct or reasonably foreseeable indirect physical change in the environment and therefore is not subject to CEQA. Additionally, pursuant to Section 15060(c)(3) the activity is not a "project" as defined in Section 15378 because it has no potential for resulting in physical change to the environment, directly or indirectly.

SECTION 5. SEVERABILITY. If any section, subsection, subdivision, sentence, clause, phrase, or portion of this Ordinance, is for any reason held to be invalid or unconstitutional by the decision of any court or competent jurisdiction, such decision shall not affect the validity of the remaining portions of this Ordinance. The City Council hereby declares that it would have adopted this Ordinance, and each section, subsection, subdivision, sentence, clause, phrases, or portion thereof, irrespective of the fact that any one or more sections, subsections, subdivisions, sentences, clauses, phrases, or portions thereof, be declared invalid or unconstitutional.

SECTION 6. CITY CLERK CERTIFICATION. The City Clerk shall certify to the adoption of this Ordinance and cause the same to be posted at the duly designated posting places within the City and published once within fifteen (15) days after passage and adoption as required by law; or, in the alternative, the City Clerk may cause to be published a summary of this Ordinance and post a certified copy of the text of this Ordinance in the Office of the City Clerk five (5) days prior to the date of adoption of this Ordinance, and, within fifteen (15) days after adoption, the City Clerk shall cause to be published the aforementioned summary and shall post a certified copy of this Ordinance, together with the vote for and against the same, in the Office of the City Clerk.

PASSED, APPROVED, AND ADOPTED by the City Council of the City of Agoura Hills this 28th day of January 2026, by the following vote to wit:

AYES: ()
NOES: ()
ABSENT: ()
ABSTAIN: ()

CITY OF AGOURA HILLS:

Jeremy Wolf, Mayor

ATTEST:

Kimberly M. Rodrigues, MMC
City Clerk

APPROVED AS TO FORM:

Candice K. Lee
City Attorney

EXHIBIT "A"

AMENDED SPEED LIMITS

Road Segment	Limits (From)	Limits (To)	Direction	Current Speed Limit (mph)	Proposed Speed Limit (mph)
Agoura Road	Reyes Adobe Road	Ladyface Court	Both	45	40
Agoura Road	Ladyface Court	Kanan Road	Both	45	40
Agoura Road	Cornell Road	Chesebro Road/Laura La Plante	Both	45	40
Agoura Road	Chesebro Road/Laura La Plante	Liberty Canyon Road	Both	45	40
Canwood Street	Derry Avenue	Chesebro Road	Both	40	35
Driver Avenue/Palo Comado Canyon Road	Argos Street	101 Freeway	Both	30/35	30
Kanan Road	Canwood Street	Agoura Road	Southbound	35 NB 40/35 SB	35 NB 35 SB
Reyes Adobe Road	Lake Lindero Drive	North City Limit	Both	40	35
Cornell Road	Cornell Way	Agoura Road	Both	None	35



REPORT TO CITY COUNCIL

DATE: JANUARY 28, 2026

TO: HONORABLE MAYOR AND MEMBERS OF THE CITY COUNCIL

FROM: NATHAN HAMBURGER, CITY MANAGER

SUBJECT: CONDUCT A PUBLIC HEARING, WAIVE FULL READING, AND INTRODUCE ORDINANCE NO. 26-484; AMENDING SECTION 2900 OF CHAPTER 9 OF ARTICLE II OF THE AGOURA HILLS MUNICIPAL CODE TO ADJUST COMPENSATION FOR CITY COUNCIL MEMBERS

This item is being presented to consider adjusting compensation to City Council Members in compliance with Senate Bill 329.

In August 1983, the City adopted Ordinance No. 35, establishing the City Council ("Council") salary at \$150 per month. In 1986, Ordinance No. 113 was adopted, amending Ordinance No. 35, and consistent with state law, the City Council of the City of Agoura Hills (City) set the salaries for the City Councilmembers (Collectively "Council Members") as follows: Article II, Chapter 9, Section 2900 of the Agoura Hills Municipal Code:

"Each member of the city council shall receive as salary the sum of three hundred dollars (\$300.00) per month as set forth in Section 36516 of the Government Code of the State of California for cities up to thirty-five thousand (35,000) in population. Such salaries shall be payable at the same time and in the same manner as salaries are paid to other officers and employees of the city."

The Council salary amount was statutorily based on the law at the time and was directly connected to the City's population that remains under 35,000 residents. There have been no increases in the monthly salary amount since 1986.

In June 2023, the Governor signed Senate Bill (SB) 329, which amended Government Code Section 36516, increasing the maximum amount of monthly salary payable to Council Members of general law cities, such as the City of Agoura Hills. In enacting SB 329, the Legislature found that "[t]he compensation schedule for general law cities had not been adjusted since 1986, meaning that city council compensation has not kept pace with inflation," and further found that "[a]llowing cities to adjust their compensation for inflation since 1986 may help city councils become more diverse because increased compensation can help individuals from across different income levels receive sufficient income from their service to help ensure that they can continue to serve the public and support their families." (SB 329, Section 1.) Under SB 329, maximum Council Member salary amounts remain tied to City population, as determined by the last federal census or estimated by the California Department of Finance.

The 2020 census shows the City's population as 19,904, (see https://data.census.gov/profile/Agoura_Hills_city,_California?g=160XX00US0622020). The California Department of Finance also confirmed that the City of Agoura Hills' population as of January 1, 2024, is 19,904 (<https://dof.ca.gov/forecasting/demographics/estimates-e1/>). Under either population measure, the population of the City of Agoura Hills is below 35,000; therefore, the City Council may increase the monthly Council Member salary from \$300 per month up to \$950 per month.

At the November 12, 2025, City Council meeting, the City Council discussed the possibility of increasing salaries based on the changes made to the Government Code via Senate Bill 329. Following that discussion, the City Council provided direction to staff to present a draft ordinance for consideration, increasing the City Council Member salaries to \$850 per month for consideration, below the maximum amount allowed via SB 329.

Following the establishment of the population-based salary by a City Council, as set forth above, SB 329 authorizes the City Council to increase Council Member salaries beyond those amounts set forth above by an amendment to the ordinance. The amount of the increase shall not exceed the greater of either: (1) an amount not-to-exceed five percent for each calendar year from the operative date of the last adjustment of the salary; or (2) the inflation amount since January 1, 2024, not to exceed 10 percent for each calendar year. (Gov. Code Section 36516(a)(4).) Under SB 329, an increase to the Council Member salary amount must be enacted by ordinance considered during at least two regular meetings of the City Council at least seven days apart.

The maximum monthly City Council compensation for general law cities must be approved by ordinance, pursuant to the Government Code. Automatic future increases in Council Member salary, such as automatic cost of living increases, are not permitted. (Gov. Code Section 36516(a)(5).) Any change in salary adopted by ordinance would not take effect until the start of a new term of any one Council Member, including Council Members who may be re-elected. (Gov. Code Section 36516.5.) The start of a new term for the City of Agoura Hills City Council would occur in December 2026, following certification of the results of the general election concluding on November 3, 2026.

Although this is a rare occurrence, any amounts paid by the City to reimburse a Council Member for actual and necessary expenses pursuant to Government Code Section 36514.5 are not included for purposes of determining salary. In addition, any other benefits that Council Members are eligible to receive are not impacted by SB 329.

FISCAL IMPACT

If Ordinance No. 26-484 is adopted, the Fiscal Year 2025-26 impact would be total \$16,500 (\$550 x 5 members x 6 months). Future fiscal year budgets would include any updated compensation amount.

RECOMMENDATION

Staff respectfully recommends the City Council conduct a Public Hearing, waive full reading, and introduce Ordinance No. 26-484; amending Section 2900 of Chapter 9 of Article II of the Agoura Hills Municipal Code to Adjust Compensation for City Council Members.

Attachments

[Ordinance No. 26-484.pdf](#)

ORDINANCE NO. 26-484

AN ORDINANCE OF THE CITY COUNCIL OF THE CITY OF AGOURA HILLS, CALIFORNIA, AMENDING SECTION 2900 (COMPENSATION) OF CHAPTER 9 (CITY COUNCIL) OF ARTICLE II (ADMINISTRATION) OF THE AGOURA HILLS MUNICIPAL CODE TO ADJUST COMPENSATION FOR CITY COUNCIL MEMBERS

WHEREAS, effective January 1, 2024, SB 329 revised Government Code Section 36516 to permit general law cities, such as the City of Agoura Hills (“City”), to increase the maximum compensation amounts payable to members of the City Council up to a statutory limit based on city population; and

WHEREAS, Senate Bill (SB) 329 was adopted to “reset” city council salaries to take into account that the salary amounts listed in the Government Code had not been revised in 40 years (*i.e.*, since 1984) and thus had not kept pace with inflation. Moreover, in adopting SB 329, and the State Legislature found and declared that allowing cities to adjust council member salaries would assist city councils become more diverse and would encourage more persons to consider public service as council members because increased compensation could help individuals from across different income levels receive sufficient income from their service to help ensure that they can continue to serve the public and support their families; and

WHEREAS, California Government Code Section 36516 provides a method by which salaries for members of a city council are established based on city population; and

WHEREAS, according to the 2020 United States Census and the California Department of Finance, the City of Agoura Hills has an estimated population of 19,904; and

WHEREAS, under SB 329, city council monthly salaries in cities with populations under 35,000 can be up to \$950; and

WHEREAS, pursuant to Ordinance No. 113 (1986), Agoura Hills City Council Members currently receive \$300 per month in salary; and

WHEREAS, compensation paid to City Council Members has not been changed since 1986, which is a period of 40 years; and

WHEREAS, California Government Code Section 36516.5 provides that a change in salary for each city council member does not take effect until one or more members of the city council begins a new term in office; and

WHEREAS, the new salary for each City Council Member would go into effect beginning on the date on which a City Council Member is sworn into office after the general municipal election date of November 3, 2026; and

WHEREAS, at the City Council of the City of Agoura Hills meeting of November 12, 2025, a public discussion item was presented, and directions were provided to staff to prepare a duly noticed public hearing; and

WHEREAS, at the regular council meetings on January 28, 2026 and February 11, 2026, the City Council of the City of Agoura Hills considered the Ordinance in open session as required by law; and

WHEREAS, all legal prerequisites to the adoption of the Ordinance have occurred.

NOW, THEREFORE, THE CITY COUNCIL OF THE CITY OF AGOURA HILLS HEREBY ORDAINS AS FOLLOWS:

Section 1. The City Council hereby specifically finds that all of the facts set forth in the recitals of this Ordinance are true and correct and are incorporated herein as if set forth in full.

Section 2. Pursuant to Government Code Section 36516(g)(2), the City Council makes the following findings demonstrating the need for the increased compensation as follows: (a) the statewide compensation schedule for city council members of general law cities, which includes the City of Agoura Hills, has not been adjusted since 1986, meaning that city council compensation has not kept pace with inflation; (b) California has had an approximate 300% increase in the cost of living since 1986; (c) the privilege to serve on the city council requires the expenditure of significant time during weekdays and weekends to attend meetings of the City as well as other meeting assignments as well as attend events in the community; (d) city council service also involves time and work in reviewing staff reports, other agenda reports, legal documents, and state legislation that would impact the city; attending to representative assignments at regional government body meetings; staying informed on current local and state issues; and reviewing financial materials, budgets and reports among the many duties of a council member; and (e) increasing city council compensation will reflect the time and work being performed by members of the city council but more importantly, will create opportunities to assist the City in encouraging that its council become more diverse as stated by the findings of Senate Bill 329 and that increased compensation can help individuals from across different income levels receive sufficient income from their service to help ensure that they can continue to serve the public and support themselves and their families.

Section 3. Section 2900 (Compensation) of Chapter 9 (City Council) of Article II (Administration) of the Agoura Hills Municipal Code is hereby amended to read as follows:

“2900. – Compensation

Each member of the City Council shall receive as salary the sum of eight hundred and fifty dollars (\$850) per month as set forth in California Government Code Section 36516. Such salaries shall be payable at the same time and in the same manner as salaries are paid to other officers and employees of the City.”

Section 4. Severability Clause. If any section, subsection, subdivision, paragraph, sentence, clause or phrase of this Ordinance or its application to any person or circumstances, is for any reason held to be invalid or unenforceable by a court of competent jurisdiction, such invalidity or unenforceability shall not affect the validity or enforceability of the remaining sections, subsections, subdivisions, paragraphs, sentences, clauses or phrases of this Ordinance, or its application to any other person or circumstance. The City Council declares that it would have adopted each section, subsections, subdivision, paragraph, sentence, clause, phrase hereof, irrespective of the fact that any one or more sections, subsections, subdivisions, paragraphs, sentences, clauses or phrases hereof be declared invalid or unenforceable.

Section 5. Effective Date. Pursuant to California Government Code Section 36516.5, the adjustment in compensation for all City Council members provided by this Ordinance shall not take effect until the commencement of the terms of any new City Council members or re-elected City Council members following the general municipal election to be held in November 2026. Ordinance No. 113 shall be repealed as of the date such adjustment in compensation takes effect.

Section 6. Certification. The Mayor shall sign and the City Clerk shall certify to the passage and adoption of this Ordinance and shall cause the same or a summary thereof to be published and posted in the manner required by law.

PASSED, APPROVED, AND ADOPTED this ___ day of _____, 2026, by the following vote to wit:

AYES: (
NOES: (
ABSENT: (
ABSTAIN: (
)

Jeremy Wolf, Mayor

ATTEST:

Kimberly M. Rodrigues, MMC, City Clerk

APPROVED AS TO FORM:

Candice K. Lee, City Attorney



REPORT TO CITY COUNCIL

DATE: JANUARY 28, 2026

TO: HONORABLE MAYOR AND MEMBERS OF THE CITY COUNCIL

FROM: NATHAN HAMBURGER, CITY MANAGER

**BY: JOHN TREICHLER, ADMINISTRATIVE ANALYST
AMY BRINK, DIRECTOR OF COMMUNITY SERVICES**

**SUBJECT: CONDUCT A PUBLIC HEARING TO CONSIDER THE ADOPTION OF RESOLUTION NO. 26-2124;
APPROVING COMMUNITY DEVELOPMENT BLOCK GRANT (CDBG) PROGRAMS AND PROJECTS
FOR THE 52ND PROGRAM YEAR**

The request before the City Council is to conduct a public hearing to consider adoption of Resolution No. 26-2124, approving Community Development Block Grant (CDBG) Programs and Projects for the 52nd Program Year (July 1, 2026 - June 20, 2027).

Community Development Block Grant (CDBG) funds are allocated on an annual basis to municipalities by the Federal Housing and Urban Development Department (HUD) and administered through the Los Angeles County Development Authority (LACDA). Funding for participating cities of the Los Angeles Urban County CDBG Program is based upon the total number of participating cities and on the cities' needs to provide housing, economic and social services, and community development opportunities that principally benefit seniors and persons of low to moderate income levels, aid in the prevention of neighborhood blight, and meet other urgent community development needs due to natural disasters or other emergencies. The City of Agoura Hills ("City") has participated in the CDBG Program since 1984.

While the City Council has flexibility in selecting programs and projects that best suit the City's needs, these programs and projects must also comply with the specific federal qualification criteria of benefiting persons of low to moderate income, including seniors, and certain public projects for compliance with the Americans with Disabilities Act (ADA).

Most recently, the City Council allocated CDBG funds for this past fiscal year towards the Morrison Park ADA Path of Travel Improvements Project, in addition to the annual allotment for senior social services classes being offered through the Community Services Department. These classes, which include various topics such as caregiver support, health care, and finances, are provided by Senior Concerns and have been provided via virtual meetings.

The City's estimated CDBG allocation for the 2026-27 Program Fiscal Year total approximately \$69,593. Staff wishes to emphasize that this is a planning estimate only. LACDA will not release final appropriations from HUD until later this spring.

Staff is recommending the City Council approve designating \$10,000 toward the Senior Social Services Program, which is the minimum amount the City may allocate toward public service programs with the remaining \$59,593 towards a future project.

Staff reviewed the current needs and presented recommendations to the Community Services Subcommittee on December 11, 2025, for the 52nd CDBG Program Year.

The Community Services Subcommittee expressed support with the continued ongoing support for our Senior Social Services Program and roll over the remaining funds towards a future project.

Should the City Council approve Resolution No. 26-2124, the next step would be to get final approval from the LACDA.

FISCAL IMPACT

There is no fiscal impact for the current Fiscal Year 2025-26 Budget. The current request is to appropriate CDBG funds for the upcoming Fiscal Year 2026-27.

RECOMMENDATION

Staff respectfully recommends the City Council conduct a Public Hearing and adopt Resolution No. 26-2124; approving Community Development Block Grant (CDBG) Programs and Projects for the 52nd Program Year (July 1, 2026 – June 30, 2027).

Attachments

[Resolution 26-2124.pdf](#)

RESOLUTION NO. 26-2124

A RESOLUTION OF THE CITY COUNCIL OF THE CITY OF AGOURA HILLS, CALIFORNIA, APPROVING COMMUNITY BLOCK GRANT (CDBG) PROGRAMS AND PROJECTS FOR THE 52ND PROGRAM YEAR (JULY 1, 2026 - JUNE 30, 2027)

WHEREAS, on August 22, 1974, the President of the United States signed into law the Housing and Community Development Act (Act) of 1974; and,

WHEREAS, the primary goals of Title I of the Act are the development of viable urban communities by providing decent housing and a suitable living environment and expanding economic opportunities, principally for persons of low and moderate income, and certain public projects for compliance with the Americans with Disabilities Act (ADA); and,

WHEREAS, the City of Agoura Hills estimates receiving \$60,593 of allocated funds in federal Community Development Block Grant (CDBG) funds to further the attainment of these goals during Fiscal Year 2026-27; and,

WHEREAS, the City Council has published information regarding eligible activities under the Act and has conducted a duly-noticed Public Hearing on January 28, 2026, at 6:00 p.m. in the Council Chambers of City Hall, 30001 Ladyface Court, Agoura Hills, California; and,

WHEREAS, the notice of the Public Hearing was posted and advertised pursuant to applicable federal, state and local laws; and,

WHEREAS, both verbal and written testimony was presented to the City Council at the Public Hearing.

NOW, THEREFORE, BE IT RESOLVED, by the City Council of the City of Agoura Hills as follows:

Section 1. That the City of Agoura Hills desires to fund eligible CDBG projects with the 52nd Program Year funds.

Section 2. That City staff is hereby directed to submit to the Los Angeles County Development Authority, through this document, the City's intent to approve and fund CDBG projects.

Section 3. That City staff is hereby directed to prepare and submit documentation required for the approval and implementation of the 52nd Program Year CDBG projects.

Section 4. That the City Council hereby authorizes for planning purposes, the City's estimated annual allocation for the upcoming 2026-27 Program Year is estimated at \$69,593 and those funds will be utilized for: 1) eligible senior social service programs, not to exceed \$10,000 of the Program Year allocation, including senior advocates information and resources, support groups for senior caregivers and care-giving spouses, and legal and financial services to seniors; and 2) allocating the remaining balance of funds towards a future project.

Section 5. That City staff is authorized to perform modifications to the approved projects, as required, to conform to CDBG requirements, and to provide for the expedient expenditure of funds.

Section 6. That the Mayor and/or City Manager are authorized to execute the contractual and related documents to be prepared by the County of Los Angeles that are required for the implementation of projects set forth herein.

PASSED, APPROVED, AND ADOPTED this 28th day of January 2026, by the following vote to wit:

AYES: ()
NOES: ()
ABSTAIN: ()
ABSENT: ()

Jeremy Wolf,
Mayor

ATTEST:

Kimberly M. Rodrigues, MMC City
Clerk



REPORT TO CITY COUNCIL

DATE: JANUARY 28, 2026
TO: HONORABLE MAYOR AND MEMBERS OF THE CITY COUNCIL
FROM: NATHAN HAMBURGER, CITY MANAGER
BY: RAMIRO ADEVA, ASSISTANT CITY MANAGER
SUBJECT: CONSIDERATION OF 2026 SOLID WASTE RATE ADJUSTMENT (SWRA) REQUEST FROM WASTE MANAGEMENT

The City of Agoura Hills maintains an exclusive residential solid waste franchise agreement with Waste Management (WM). The City's Solid Waste Franchise Agreement with WM provides for two distinct rate adjustment mechanisms, both effective on January 1st of each calendar year, pending Council approval.

The first is the Consumer Price Index (CPI) escalation outlined in Section 5.3.1. This is an annual adjustment tied to the CPI for the 12-month period ending September 30 of each year and is capped at three percent (3%). For the relevant timeframe under consideration, the CPI as published by the Department of Labor and Statistics (DLS) reflects a calculated increase of 3.198%. However, pursuant to the terms of the franchise agreement, the annual CPI escalation is expressly limited to a maximum of three percent (3%). Accordingly, staff has reviewed the applicable CPI data and confirmed that a three percent (3%) increase is the appropriate escalation to implement for this period in full compliance with the agreement.

The second is the Solid Waste Rate Adjustment (SWRA) outlined in Section 5.3.2 of the franchise agreement. The SWRA is a discretionary adjustment intended to offset documented increases in operational costs and is not guaranteed. Operational costs eligible for consideration under an SWRA may include, but are not limited to, motor vehicle fuel, insurance, personnel costs (including salaries and benefits), equipment repair and maintenance costs, landfill disposal and processing fees, tipping fees, and equipment purchases.

To qualify for an SWRA, the current franchise agreement requires WM to submit documentation substantiating the claimed increases in operational costs and to satisfy the following qualitative criteria:

- (1) overall customer satisfaction with WM services;
- (2) satisfactory compliance with all provisions of the franchise agreement; and
- (3) compliance with solid waste diversion requirements mandated by the State of California and implemented by the City of Agoura Hills.

Additionally, during the City Council's consideration of last year's Solid Waste Rate Adjustment (SWRA), the City Council required Waste Management (WM) to satisfy additional qualitative outreach and performance-related measures as a condition of future SWRA consideration. These measures included enhanced promotion and advertising of the senior discount program, as well as targeted outreach and education related to the City's organics program, specific to proper placement of food waste within green waste/organics containers. These requirements were established to reinforce customer awareness, promote participation in available programs, and support the City's compliance with state-mandated organics diversion requirements.

With respect to the qualitative outreach and performance requirements established by the City Council, staff believes that WM continues to be a good operational partner for the City and has satisfactorily met these requirements. As documented in Attachment 1, the memorandum prepared by Solid Waste Solutions, Inc. (SWS) includes a dedicated *Contract Review* section that evaluates WM's overall compliance with the franchise agreement and provides feedback on service quality, customer responsiveness, and regulatory compliance. Based on this review, staff finds that WM has demonstrated satisfactory performance relative to the qualitative criteria established by the City Council for consideration of discretionary Solid Waste Rate Adjustment requests.

With respect to the specific rate increase, WM submitted the required documentation citing increases in operational costs. The primary cost drivers identified in the request include increased landfill disposal and processing costs, as well as higher organics gate rate tipping fees associated with waste disposal and processing facilities utilized for Agoura Hills' solid waste services.

Staff, with the assistance of the City's solid waste consultant, Solid Waste Solutions, Inc. (SWS), reviewed the 2026 rate adjustment request from WM, including all supporting documentation. As part of this review, SWS evaluated the cost assumptions, calculations, and proposed rate tables and confirmed that the calculations and proposed rates submitted by WM have been verified mathematically and are supported by the documented increases in disposal and processing costs (Refer to Attachment 1).

However, not all of the requested rate increases may be implemented. In accordance with Section 5.4 of the franchise agreement, commonly referred to as the *Most Favored Nation (MFN)* provision, WM has agreed that rates charged to Agoura Hills customers shall not exceed the rates charged in comparable neighboring jurisdictions. The franchise agreement identifies the neighboring cities of Calabasas, Hidden Hills, Malibu, and Westlake Village for comparison purposes. Hidden Hills does not have comparable service and Malibu rates are not comparable as there is no franchise agreement. Therefore, for purposes of applying the MFN provision, the cities used for rate comparison are limited to Calabasas and Westlake Village. Refer to Attachment 2 to see the proposed final 2026 rates, which account for the MFN provision for only those items where applicable.

On December 8, 2025, this item was presented to the Public Works Subcommittee (Mayor Jeremy Wolf and Councilmember Kate Anderson) for consideration. As part of that discussion, WM initially presented two alternative rate adjustment scenarios for consideration. The first scenario reflected the 2025 rates plus the guaranteed CPI escalation and additional increases based on documented operational cost changes. The second scenario reflected the 2025 rates plus the guaranteed CPI escalation and a flat three percent (3%) Solid Waste Rate Adjustment (SWRA). The subcommittee supported the second scenario, which was the 2025 rates plus CPI plus a three percent (3%) SWRA. Accordingly, Attachment 2 reflects the proposed 2026 rates aligned with the second scenario, representing the 2025 rates plus the guaranteed CPI escalation and an additional three percent (3%) SWRA.

If approved by the City Council, the adjusted solid waste rates would be implemented consistent with the terms of the franchise agreement and would take effect retroactively as of January 1, 2026. WM would be responsible for providing required customer notice and administering any retroactive billing adjustments in accordance with the franchise agreement and applicable law.

FISCAL IMPACT

City Council review of this item does not affect the approved Fiscal Year 2025-26 budget, as no appropriations are needed for this item. Approval of the Solid Waste Rate Adjustment (SWRA) would authorize Waste Management to increase the rates charged directly to residential and commercial customers in Agoura Hills for solid waste hauling services. Waste Management invoices customers directly for these services, and the City does not subsidize or directly pay for residential or commercial solid waste collection under the current franchise agreement.

RECOMMENDATION

Staff respectfully recommends the City Council consider Waste Management's request for an additional Solid Waste Rate Adjustment (SWRA), and provide direction to staff regarding approval, modification, or denial of the requested SWRA increase for 2026.

Attachments

[Attachment 1: SWS summary of SWRA request.pdf](#)

[Attachment 2: 2026 Proposed Agoura Hills Rates.pdf](#)



Transmittal Memorandum

To:	Ramiro Adeva, Assistant City Manager
From:	Kimberly Nilsson, President
Date:	November 26, 2025
Subject:	Waste Management Rate Increase Review 2026

At the City's request Solid Waste Solutions, Inc. (SWS) was tasked to review the rate increase request submitted by Waste Management on October 30, 2025. As part of a rate increase SWS will review the Franchise Agreement between the City of Agoura Hills and G.I. Industries, a Utah Corporation for Integrated Exclusive Residential Waste Management Services, dated January 1, 2017, for contract compliance.

1. Evaluate the rate increase request.
2. Provide a franchise compliance review.

1. Rate Increase Review:

In accordance with the Franchise Agreement for Integrated Exclusive Residential Waste Management Services, Article 5 Company Compensation, Rates and Fees: City Fees Sections 15.3 Future Adjustments 5.3.1 Escalation and 5.3.2 Solid Waste Rate Adjustments, Waste Management has submitted a request for an escalation increase using Consumer Price Index (CPI) values defined as the 12-month period ending September 30 of each year and also an operational cost increase. Both increases are requested to be effective on January 1, 2026.

The CPI increase presented to the City is a straightforward calculation in accordance with the franchise agreement and in this case is calculated at 3.198%. Pursuant to the contract, Section 5.3.1 Escalation, the maximum CPI allowed is 3%.

The operational increase makes up the remaining amount and is due to the increase in landfill and organics gate rate tipping fee increases. Waste Management has presented documentation to support the following tipping increases:

Refuse/Trash:	\$9.04/ton	Simi Valley Landfill
	\$3.79/ton	Calabasas Landfill
Organics:	\$9.00/ton	Simi Valley Landfill
	\$3.77/ton	Calabasas Landfill
Recycling:	\$15.50/ton	Gold Coast to Sun Valley Recycle Park



Solid Waste Solutions, Inc./City Permit Services

Note: Simi Valley Landfill owner: Waste Management; Calabasas Landfill owner: County Sanitation District of Los Angeles

Waste Management has presented their calculations and verified the cost increases using the tonnages of material that come from the City of Agoura Hills. Calculations and summary rate tables for the residential and commercial sectors have been provided and included in the attached report.

The Waste Management calculations indicate that the residential cart rates will be increased between 7.61% and 8.23%. The residential bin rates are billed by type of service, therefore the increases range in magnitude from 5.91% for a 1.5CY1 day/week refuse collection to 9.17% for 4CY/6 days/week.

Waste Management also submitted a set rate increase. This was set using the 3% CPI maximum plus a 3.01% SWRA increase. This increase was applied to all service levels equally whereas the other is based on actual tonnages.

SWS has reviewed all calculations and the new rates that Waste Management has presented have been verified mathematically. But all the requested increases cannot be implemented. In accordance with Franchise Section 5.4 Most Favored City, it states that WM agrees that the Agoura Hills rates shall not be greater than the identified neighboring Cities. Those cities are Calabasas, Hidden Hills, Malibu and Westlake Village. SWS has compared the rates of the neighboring cities. Hidden Hills does not have comparable service and Malibu rates are not comparable as there is no franchise agreement. The area rates shown are from Calabasas and Westlake Village. There are lower rates in some service levels and the basics are identified below. SWS has taken the spreadsheets provided by WM and added the Calabasas and Westlake rates. The spreadsheets are attached. Also, the orange rates on the spreadsheet below cannot be increased.



Solid Waste Solutions, Inc./City Permit Services

Proposed Rates:					Area Rates: Eff: 7/1/25	
Type of Service		Current 2025 Rates	2026 Rates Cpi + SWRA	2026 Rates 6.1% Increase	Westlake Village	Calabasas
Residential						
Mini-can Service	32 Gallon Trash	\$ 23.57	\$ 25.51	\$ 25.00	\$ 28.30	\$ 26.12
Level 1	64 Gallon Trash	\$ 29.35	\$ 31.69	\$ 31.14	\$ 30.37	\$ 37.58
Level 2	96 Gallon Trash	\$ 36.63	\$ 39.42 *	\$ 38.86 *	\$ 33.48	\$ 45.25
Level 3	2-64 Gallon Trash	\$ 63.58	\$ 67.41	\$ 67.46		
Level 4	1-64 & 1-96 Gallon trash	\$ 71.47	\$ 75.75	\$ 75.82		
Level 5	2-96 Gallon Trash	\$ 72.83	\$ 77.38	\$ 77.26		
Multi-Family						
3 Cubic Yards Trash	1/Week	\$ 111.63	\$ 120.13	\$ 118.73		\$ 123.72
3 Cubic Yard Recycle	1/Week	\$ 49.88	\$ 60.24	\$ 52.92		\$ 61.86

*This rate has not been held to the lower Westlake Village Rate as it was already above the Westlake rate upon execution of their franchise agreement.

2. Contract Review:

SWS completed a review of the Waste Management submittal, attachments and reports submitted throughout the year 2024. We find that Waste Management is in compliance with the agreement and a good service provider. With regards to the efficiency of collection and compliance with the agreement, Waste Management has met the stated 50% diversion mandated by AB939 for the residential and multi-family sectors, submitted all required reports on time, and continues to demonstrate as an active participant in the Agoura Hills community.

Below is a table indicating the haulers franchise diversion (Residential & Multi-Family only) for the last 3 years:

Year	Residential/Multi-Family
2023	51.04%
2024	52.45%
2025	51.78%*

* Through 2nd Quarter 2023



Solid Waste Solutions, Inc./City Permit Services

Waste Management staff are available for inquiries, and appear responsive to City staff needs, and the company demonstrates its commitment to safety with their frequent trainings of their staff.

Procedures for Customer Complaints/Resolution: Waste Management continues to demonstrate an efficient system in handling customer complaints and providing same day resolutions. Below is a summary of total customer claims submitted to Waste Management. These numbers equate to less the 0.5% of the total customers.

2025 Quarter	Number of Occurrences Reported
1 st	17
2 nd	15
3 rd	24

The franchise agreement requires the Franchisee to implement all State of California mandatory programs. Beyond meeting the 50% diversion mandated by AB 939, the following programs are also required and reported to be fully implemented by Waste Management.

- AB 341: Mandatory Commercial/Multi-family Recycling: Triggering level 4CY commercial waste generated weekly or multi-family units of 5 or greater.
- AB 1826: Mandatory Organics Recycling: Triggering level 4CY commercial waste generated weekly or multi-family units of 5 or greater.
- SB 1383: Short Lived Climate Pollutants: Organics Recycling: All residential and multi-family/commercial accounts shall have an organics program.

Upon reviewing diversion reports submitted quarterly, ongoing program implementation/coordination, and review of the request for a CPI and Operational rate increases, SWS finds that Waste Management is in compliance with the franchise agreement requirements for the rate increase. SWS thereby is submitting the Waste Management 2026 Rate Adjustment Review package to the City for final consideration.

If the rate increase is deemed acceptable by the City, the City at their discretion, in accordance with the contract, is authorized to make a final determination of the appropriate amount of the adjustment that may be applied.



Solid Waste Solutions, Inc./City Permit Services

The contractor is required to provide all customers with a minimum of fifteen days' written notice prior to the increase. The Residential bills for January 2025 are typically mailed out around December 15th.



Solid Waste Solutions, Inc./City Permit Services

Attachment 1
Waste Management 2025 Rate Increase request



October 28, 2025

Mr. Ramiro Adeva
 City of Agoura Hills
 30001 Ladyface Court
 Agoura Hills, CA 91301

RE: 2026 Rate Adjustment Request

Dear Mr. Adeva,

In accordance with the amended Franchise Agreement between the City of Agoura Hills and G.I. Industries (WM), we respectfully submit our request for the annual service rate adjustment for 2026. Included, you will find the calculations and supporting documentation that provide a detailed basis for this request.

In addition to the standard CPI-based adjustment, WM is requesting a Solid Waste Rate Adjustment (SWRA) to account for year-over-year increases in landfill, organics and recyclables disposal and processing cost changes, as permitted under Section 5.3.2 of the Agreement. These cost changes are summarized as follows:

Material	Facilities	Rate Setting Entity	2026 Change in Cost Per Ton	% Change
Trash	Simi Valley Landfill & Recycling Center	County of Ventura	\$9.04	9.61%
Organics	Simi Valley Landfill & Recycling Center/ Calabasas Landfill	Conty of Ventura / Los Angeles County Sanitation Districts	\$5.50	6.75%
Recyclables	Gold Coast Recycling & Transfer Station / Sun Valley Recycling Park	Gold Coast Recycling & Transfer Station / Sun Valley Recycling Park	\$15.50	16.67%

Summary of Requested Adjustments

For reference, the most common residential service level (Level 1) is currently billed at \$29.35/month. The proposed 2026 adjustments are as follows:

- 2025 Current Residential Level 1 Rate: \$29.35
- 2026 CPI = X.XX%, capped at 3%: \$0.88
- 2026 SWRA for Disposal and Processing Cost Changes: \$1.46
- Proposed 2026 Residential Level 1 Rate: \$31.69 (rounded to the nearest cent)

Since 2021, many residential customers have experienced minimal to no changes in their rates, even though the City Council has approved adjustments. This situation arises from the staff's interpretation of the "Most Favored City" provision outlined in Section 5.4. When compared to rates in Westlake Village, this provision has been an ongoing factor in limiting rate adjustments, despite clear documentation of increased costs.

Its also important to note that a significant portion of the proposed 2026 rate adjustment is based on actual and unavoidable changes in disposal and processing costs. These adjustments are necessary and highlight genuine economic factors that we must navigate together for a sustainable future!

We understand the intent of the MFN clause is to protect residents from steep or unpredictable rate hikes. However, in practice, it has created a disconnect between actual service costs and approved rates. We respectfully request that the City continue discussions to amend this provision and ensure future adjustments reflect true cost changes.

The table below illustrates the disparity between calculated rate changes and actual rates over the past five years:

Category	2021	2022	2023	2024	2025	Total
Standard Level 1 Service Rate	\$29.35	\$29.35	\$29.35	\$29.35	\$29.35	\$29.35
Calculated % Change in Rate Per Approved Formula	3.01%	2.97%	5.07%	6.65%	8.36%	26.06
Actual % Change in Rate Limited by MFN ¹	0%	0%	0%	0%	6.86%	0.3%
Difference in Actual Rate Versus CPI & SWRA	(3.01%)	(2.97%)	(5.04%)	(6.65%)	(1.50%)	(18.26%)
Difference in Actual Rate Versus CPI & SWRA (in dollars)	(\$0.88)	(\$0.89)	(\$1.57)	(\$1.72)	(\$2.91)	(\$8.26)
CPI & SWRA Rate	\$30.22	\$31.21	\$32.68	\$34.40	\$37.76	\$37.67

In closing, WM is proud to serve the City of Agoura Hills. From helping meet regulations and increasing material diversion to promoting environmental stewardship through outreach and education, we are committed to enhancing the quality of life for residents and businesses. We appreciate your favorable consideration of this request and look forward to discussing it with you soon.

Kindest regards,



Denise Kane
Public Sector Solutions

Attachments:

Exhibit A – 2026 Rate Adjustment Calculations

Exhibit B – 2026 SWRA Supporting Information

Exhibit C – WM Statement of Review

Exhibit D – City Comparison Rates

City of Agoura Hills
Proposed Rates effective 1/1/26

	SWRA Increase						SWRA				
	2025	CPI	MSW			Proposed	%	Approved		2026	
			Disposal	Organics	Recycle			Rate + CPI	3.00%	Rate + SWRA	%
RESIDENTIAL CART SERVICE - TRASH											
32 GAL TOTER S/L	\$ 23.57	0.71	\$ 0.23	\$ 0.57	\$ 0.43	\$ 25.51	8.23%	\$ 24.28	\$ 0.73	\$ 25.00	6.10%
32 GAL TOTER S/L - senior 15%	\$ 20.03	0.60	\$ 0.23	\$ 0.57	\$ 0.43	\$ 21.86	9.13%	\$ 20.63	\$ 0.62	\$ 21.25	6.09%
64 GAL TOTER S/L (Level 1)	\$ 29.35	0.88	\$ 0.46	\$ 0.57	\$ 0.43	\$ 31.69	7.96%	\$ 30.23	\$ 0.91	\$ 31.14	6.09%
64 GAL TOTER S/L (Level 1) - senior 15%	\$ 26.47	0.79	\$ 0.46	\$ 0.57	\$ 0.43	\$ 28.72	8.49%	\$ 27.26	\$ 0.82	\$ 28.08	6.07%
96 GAL TOTER S/L (Level 2)	\$ 36.63	1.10	\$ 0.69	\$ 0.57	\$ 0.43	\$ 39.42	7.61%	\$ 37.73	\$ 1.13	\$ 38.86	6.09%
96 GAL TOTER S/L (Level 2) - senior 15%	\$ 33.03	0.99	\$ 0.69	\$ 0.57	\$ 0.43	\$ 35.70	8.10%	\$ 34.02	\$ 1.02	\$ 35.04	6.09%
Level 3 (2 - 64 gallon trash carts)	\$ 63.58	1.91	\$ 0.91	\$ 0.57	\$ 0.43	\$ 67.41	6.01%	\$ 65.49	\$ 1.96	\$ 67.46	6.09%
Level 3 senior 15%	\$ 54.04	1.62	\$ 0.91	\$ 0.57	\$ 0.43	\$ 57.58	6.54%	\$ 55.66	\$ 1.67	\$ 57.33	6.09%
Level 4 (1 - 64 gallon trash and 1 - 96 gallon trash)	\$ 71.47	2.14	\$ 1.14	\$ 0.57	\$ 0.43	\$ 75.75	5.99%	\$ 73.61	\$ 2.21	\$ 75.82	6.08%
Level 4 senior 15%	\$ 60.75	1.82	\$ 1.14	\$ 0.57	\$ 0.43	\$ 64.72	6.52%	\$ 62.57	\$ 1.88	\$ 64.45	6.09%
Level 5 (2 - 96 gallon trash carts)	\$ 72.83	2.18	\$ 1.37	\$ 0.57	\$ 0.43	\$ 77.38	6.25%	\$ 75.01	\$ 2.25	\$ 77.26	6.08%
Level 5 senior 15%	\$ 61.91	1.86	\$ 1.37	\$ 0.57	\$ 0.43	\$ 66.14	6.84%	\$ 63.77	\$ 1.91	\$ 65.68	6.09%
32 GAL TOTER S/L - multi family	\$ 18.30	0.55	\$ 0.23		\$ 0.43	\$ 19.51	6.62%	\$ 18.85	\$ 0.57	\$ 19.42	6.10%
64 GAL TOTER S/L - multi family	\$ 26.90	0.81	\$ 0.46		\$ 0.43	\$ 28.60	6.32%	\$ 27.71	\$ 0.83	\$ 28.55	6.10%
96 GAL TOTER S/L - multi family	\$ 31.88	0.96	\$ 0.69		\$ 0.43	\$ 33.96	6.52%	\$ 32.84	\$ 0.99	\$ 33.83	6.10%
VALET SERVICE S/L	\$ 20.00	0.60				\$ 20.60	3.00%	\$ 20.60	\$ 0.62	\$ 21.22	6.09%
START CHARGE	\$ 25.25	0.76				\$ 26.01	3.01%	\$ 26.01		\$ 26.01	3.01%
CUT OFF / RESTART FEE	\$ 24.62	0.74				\$ 25.36	3.01%	\$ 25.36		\$ 25.36	3.01%
CUSTOMER SERVICE CREDIT CARD PROCESSING FEE	\$ 10.21	0.31				\$ 10.52	3.04%	\$ 10.52		\$ 10.52	3.04%
RECYCLE CONTAMINATION FEE	\$ 30.58	0.92				\$ 31.50	3.01%	\$ 31.50		\$ 31.50	3.01%
GREENWASTE CONTAMINATION FEE	\$ 30.58	0.92				\$ 31.50	3.01%	\$ 31.50		\$ 31.50	3.01%
EXTRA PICKUP ON SCHEDULED SERVICE DAY - BAG	\$ 4.10	0.12	\$ 0.15			\$ 4.37	6.59%	\$ 4.22	\$ 0.13	\$ 4.35	6.02%
EXTRA PICKUP ON SCHEDULED SERVICE DAY - CART	\$ 6.87	0.21	\$ 0.46			\$ 7.54	9.71%	\$ 7.08	\$ 0.21	\$ 7.29	6.15%
EXTRA PICKUP ON NON-SCHEDULED SERVICE DAY*	\$ 34.15	1.02	\$ 0.46			\$ 35.63	4.32%	\$ 35.17	\$ 1.06	\$ 36.23	6.08%
ADDITIONAL BULKY ITEMS PICKUP (after 2 trips of two items)	\$ 32.17	0.97	\$ 0.46			\$ 33.59	4.44%	\$ 33.14	\$ 0.99	\$ 34.13	6.11%
* For 3 carts or bags, anything over this is extra - see above.											
64 GAL S/L TOTER - RECYCLING ADD'L	\$ 5.46	0.16	\$ -		\$ 0.43	\$ 6.05	10.87%	\$ 5.62	\$ 0.17	\$ 5.79	6.02%
96 GAL S/L TOTER - RECYCLING ADD'L	\$ 5.71	0.17	\$ -		\$ 0.43	\$ 6.31	10.57%	\$ 5.88	\$ 0.18	\$ 6.05	6.07%
96 GAL S/L TOTER - GRN/YDW ADD'L	\$ 4.73	0.14	\$ -	\$ 0.57		\$ 5.43	14.95%	\$ 4.87	\$ 0.15	\$ 5.01	6.05%
96 GAL GRN/YDW/Manure	\$ 12.68	0.38	\$ -	\$ 0.57		\$ 13.63	7.47%	\$ 13.06	\$ 0.39	\$ 13.45	6.09%
Additional 64 gallon trash toter	\$ 13.64	0.41	\$ 0.46			\$ 14.50	6.36%	\$ 14.05	\$ 0.42	\$ 14.47	6.10%
Third additional 96 gallon trash toter	\$ 25.36	0.76	\$ 0.69			\$ 26.80	5.70%	\$ 26.12	\$ 0.78	\$ 26.90	6.09%
RESIDENTIAL BIN SERVICE - TRASH											
1.5 YD 1X Per Week Trash	\$ 98.16	2.94	\$ 2.57			\$ 103.67	5.62%	\$ 101.10	\$ 3.03	\$ 104.13	6.08%
1.5 YD 2X Per Week Trash	\$ 176.42	5.29	\$ 5.14			\$ 186.85	5.91%	\$ 181.71	\$ 5.45	\$ 187.16	6.09%
1.5 YD 3X Per Week Trash	\$ 247.57	7.43	\$ 7.72			\$ 262.72	6.12%	\$ 255.00	\$ 7.65	\$ 262.65	6.09%
1.5 YD 4X Per Week Trash	\$ 313.33	9.40	\$ 10.29			\$ 333.01	6.28%	\$ 322.73	\$ 9.68	\$ 332.41	6.09%
1.5 YD 5X Per Week Trash	\$ 389.83	11.70	\$ 12.86			\$ 414.39	6.30%	\$ 401.53	\$ 12.05	\$ 413.58	6.09%
1.5 YD 6X Per Week Trash	\$ 461.01	13.83	\$ 15.43			\$ 490.27	6.35%	\$ 474.84	\$ 14.25	\$ 489.08	6.09%
3.0 YD 1X Per Week Trash	\$ 111.63	3.35	\$ 5.14			\$ 120.13	7.61%	\$ 114.98	\$ 3.45	\$ 118.43	6.09%
3.0 YD 2X Per Week Trash	\$ 205.38	6.16	\$ 10.29			\$ 221.83	8.01%	\$ 211.54	\$ 6.35	\$ 217.89	6.09%
3.0 YD 3X Per Week Trash	\$ 307.34	9.22	\$ 15.43			\$ 331.99	8.02%	\$ 316.56	\$ 9.50	\$ 326.06	6.09%
3.0 YD 4X Per Week Trash	\$ 398.40	11.95	\$ 20.58			\$ 430.93	8.16%	\$ 410.35	\$ 12.31	\$ 422.66	6.09%
3.0 YD 5X Per Week Trash	\$ 489.47	14.68	\$ 25.72			\$ 529.87	8.25%	\$ 504.15	\$ 15.12	\$ 519.27	6.09%
3.0 YD 6X Per Week Trash	\$ 580.55	17.42	\$ 30.86			\$ 628.83	8.32%	\$ 597.97	\$ 17.94	\$ 615.91	6.09%
4.0 YD 1X Per Week Trash	\$ 121.06	3.63	\$ 6.86			\$ 131.54	8.66%	\$ 124.69	\$ 3.74	\$ 128.43	6.09%
4.0 YD 2X Per Week Trash	\$ 222.76	6.68	\$ 13.72			\$ 243.16	9.16%	\$ 229.44	\$ 6.88	\$ 236.32	6.09%
4.0 YD 3X Per Week Trash	\$ 330.26	9.91	\$ 20.58			\$ 360.75	9.23%	\$ 340.17	\$ 10.21	\$ 350.37	6.09%
4.0 YD 4X Per Week Trash	\$ 445.50	13.36	\$ 27.43			\$ 486.29	9.16%	\$ 458.86	\$ 13.77	\$ 472.62	6.09%
4.0 YD 5X Per Week Trash	\$ 556.87	16.71	\$ 34.29			\$ 607.87	9.16%	\$ 573.58	\$ 17.21	\$ 590.79	6.09%
4.0 YD 6X Per Week Trash	\$ 667.06	20.01	\$ 41.15			\$ 728.22	9.17%	\$ 687.07	\$ 20.61	\$ 707.68	6.09%
RESIDENTIAL BIN SERVICE - RECYCLE											
1.5 YD 1X Per Week Recycle	\$ 41.93	1.26		\$ 4.43		\$ 47.62	13.57%	\$ 43.19	\$ 1.30	\$ 44.49	6.10%
1.5 YD 2X Per Week Recycle	\$ 83.53	2.51		\$ 8.86		\$ 94.90	13.61%	\$ 86.04	\$ 2.58	\$ 88.62	6.10%
1.5 YD 3X Per Week Recycle	\$ 125.13	3.75		\$ 13.29		\$ 142.17	13.62%	\$ 128.88	\$ 3.87	\$ 132.75	6.09%
1.5 YD 4X Per Week Recycle	\$ 167.08	5.01		\$ 17.72		\$ 189.81	13.60%	\$ 172.09	\$ 5.16	\$ 177.25	6.09%
1.5 YD 5X Per Week Recycle	\$ 208.66	6.26		\$ 22.15		\$ 237.07	13.61%	\$ 214.92	\$ 6.45	\$ 221.37	6.09%
1.5 YD 6X Per Week Recycle	\$ 250.40	7.51		\$ 26.58		\$ 284.49	13.61%	\$ 257.91	\$ 7.74	\$ 265.65	6.09%

City of Agoura Hills
Proposed Rates effective 1/1/26

RESIDENTIAL CART SERVICE - TRASH	2025	SWRA Increase					Proposed 2026	%	SWRA		2026	%
		CPI	MSW Disposal	Organics Disposal	Recycle Disposal	Approved			Rate + SWRA			
		3.00%	Increase	Increase	Increase	3.00%			Rate + SWRA			
3.0 YD 1X Per Week Recycle	\$ 49.88	1.50		\$ 8.86	\$ 60.24	20.77%	\$ 51.38	\$ 1.54	\$ 52.92	6.10%		
3.0 YD 2X Per Week Recycle	\$ 98.15	2.94		\$ 17.72	\$ 118.81	21.05%	\$ 101.09	\$ 3.03	\$ 104.12	6.09%		
3.0 YD 3X Per Week Recycle	\$ 143.76	4.31		\$ 26.58	\$ 174.65	21.49%	\$ 148.07	\$ 4.44	\$ 152.51	6.09%		
3.0 YD 4X Per Week Recycle	\$ 189.68	5.69		\$ 35.44	\$ 230.81	21.68%	\$ 195.37	\$ 5.86	\$ 201.23	6.09%		
3.0 YD 5X Per Week Recycle	\$ 235.29	7.06		\$ 44.30	\$ 286.65	21.83%	\$ 242.35	\$ 7.27	\$ 249.62	6.09%		
3.0 YD 6X Per Week Recycle	\$ 281.00	8.43		\$ 53.16	\$ 342.59	21.92%	\$ 289.43	\$ 8.68	\$ 298.11	6.09%		
4.0 YD 1X Per Week Recycle	\$ 56.53	1.70		\$ 11.81	\$ 70.04	23.90%	\$ 58.23	\$ 1.75	\$ 59.98	6.10%		
4.0 YD 2X Per Week Recycle	\$ 107.45	3.22		\$ 23.62	\$ 134.29	24.98%	\$ 110.67	\$ 3.32	\$ 113.99	6.09%		
4.0 YD 3X Per Week Recycle	\$ 158.34	4.75		\$ 35.44	\$ 198.53	25.38%	\$ 163.09	\$ 4.89	\$ 167.98	6.09%		
4.0 YD 4X Per Week Recycle	\$ 206.97	6.21		\$ 47.25	\$ 260.43	25.83%	\$ 213.18	\$ 6.40	\$ 219.58	6.09%		
4.0 YD 5X Per Week Recycle	\$ 255.24	7.66		\$ 59.06	\$ 321.96	26.14%	\$ 262.90	\$ 7.89	\$ 270.79	6.09%		
4.0 YD 6X Per Week Recycle	\$ 303.64	9.11		\$ 70.87	\$ 383.62	26.34%	\$ 312.75	\$ 9.38	\$ 322.13	6.09%		
Valet service 1X Per Week	\$ 47.60	1.43			\$ 49.03	3.00%	\$ 49.03	\$ 1.47	\$ 50.50	6.09%		
Valet service 2X Per Week	\$ 61.10	1.83			\$ 62.93	3.00%	\$ 62.93	\$ 1.89	\$ 64.82	6.08%		
Valet service 3X Per Week	\$ 91.39	2.74			\$ 94.13	3.00%	\$ 94.13	\$ 2.82	\$ 96.96	6.09%		
3yd Yard Waste/Manure	\$ 163.28	4.90			\$ 168.18	3.00%	\$ 168.18	\$ 5.05	\$ 173.22	6.09%		

**Consumer Price Index for All Urban Consumers (CPI-U)
Original Data Value**

Series Id: CUURS49ASA0

Not Seasonally Adjusted

Series: All items in Los Angeles-Long Beach-Anaheim, CA, all
Title: urban consumers, not seasonally adjusted
Area: Los Angeles-Long Beach-Anaheim, CA
Item: All items
Base: 1982-84=100
Period:
Years: 2014 to 2024

Year	Jan	Feb	Mar	Apr	May	Jun	Jul	Aug	Sep	Oct	Nov	Dec	Annual
2014	239.857	241.059	242.491	242.437	243.362	243.528	243.727	243.556	243.623	243.341	241.753	240.475	242.434
2015	239.724	241.297	243.738	243.569	246.093	245.459	247.066	246.328	245.431	245.812	245.711	245.357	244.632
2016	247.155	247.113	247.873	248.368	249.554	249.789	249.784	249.700	250.145	251.098	250.185	250.189	249.246
2017	252.373	253.815	254.525	254.971	255.674	255.275	256.023	256.739	257.890	258.883	259.135	259.220	256.210
2018	261.235	263.012	264.158	265.095	266.148	265.522	266.007	266.665	268.032	269.482	268.560	267.631	265.962
2019	269.468	269.608	271.311	273.945	274.479	274.380	274.682	274.579	276.054	278.075	277.239	275.553	274.114
2020	277.755	278.657	276.589	275.853	276.842	278.121	279.899	280.116	279.366	279.947	280.102	279.560	278.567
2021	280.178	281.347	282.648	285.808	287.620	289.218	290.890	291.333	292.209	294.961	296.790	297.925	289.244
2022	301.209	302.164	306.679	308.302	310.649	314.072	313.415	313.608	315.033	317.014	314.633	312.601	310.782
2023	318.591	317.571	317.873	320.089	320.514	322.055	321.931	324.050	324.984	324.545	323.341	323.456	321.583
2024	326.640	328.232	330.671	332.572	332.956	332.357	332.928	333.359	334.123				

319.326
329.598
10.27283

3.22% Change in the CPI
3% Max allowed amount under agreement

**Consumer Price Index for All Urban Consumers (CPI-U)
Original Data Value**

Series Id: CUURS49ASA0

Not Seasonally Adjusted

Series: All items in Los Angeles-Long Beach-Anaheim, CA, all
Title: urban consumers, not seasonally adjusted
Area: Los Angeles-Long Beach-Anaheim, CA
Item: All items
Base: 1982-84=100
Period:
Years: 2015 to 2025

Year	Jan	Feb	Mar	Apr	May	Jun	Jul	Aug	Sep	Oct	Nov	Dec	Annual
2015	239.724	241.297	243.738	243.569	246.093	245.459	247.066	246.328	245.431	245.812	245.711	245.357	244.632
2016	247.155	247.113	247.873	248.368	249.554	249.789	249.784	249.700	250.145	251.098	250.185	250.189	249.246
2017	252.373	253.815	254.525	254.971	255.674	255.275	256.023	256.739	257.890	258.883	259.135	259.220	256.210
2018	261.235	263.012	264.158	265.095	266.148	265.522	266.007	266.665	268.032	269.482	268.560	267.631	265.962
2019	269.468	269.608	271.311	273.945	274.479	274.380	274.682	274.579	276.054	278.075	277.239	275.553	274.114
2020	277.755	278.657	276.589	275.853	276.842	278.121	279.899	280.116	279.366	279.947	280.102	279.560	278.567
2021	280.178	281.347	282.648	285.808	287.620	289.218	290.890	291.333	292.209	294.961	296.790	297.925	289.244
2022	301.209	302.164	306.679	308.302	310.649	314.072	313.415	313.608	315.033	317.014	314.633	312.601	310.782
2023	318.591	317.571	317.873	320.089	320.514	322.055	321.931	324.050	324.984	324.545	323.341	323.456	321.583
2024	326.640	328.232	330.671	332.572	332.956	332.357	332.928	333.359	334.123	334.242	333.718	334.531	332.194
2025	337.508	338.438	340.648	342.565	343.010	343.024	343.624	344.503	345.865				

329.598
340.140
10.54133

3.1982% Change in the CPI
3% Max allowed amount under agreement

5.3 Future Adjustments

5.3.1 Escalation

The maximum rates set forth in Exhibit 1 are subject to escalation beginning January 1, 2018. The maximum rates shall be escalated only if Company is in full and complete compliance with the obligations of this Agreement. Such escalation shall be calculated by computing the percentage change in the CPI index for the twelve (12) month period ending September 30 of each year, and multiplying the applicable amount to be escalated by one hundred percent (100%) of that percentage change in the CPI, to a maximum of three percent (3%).

"CPI Index" means the Pacific Cities and City Average All-Items Index (Los Angeles-Anaheim-Riverside), All Urban Consumers, for the Los Angeles-Anaheim-Riverside Area, as published by the United States Department of Labor, Bureau of Labor Statistics.

3955.180 Total for 2023-2024
4081.676 Total for 2024-2025
126.496 Change in the CPI
0.031982 Change in the CPI divided by the Total for 2023-2024

3.1982% Change in the CPI multiplied by 100%
3% Max allowed amount under agreement

Homes Per Month	C # of Carts	D Container Size	E Weeks Per Month	F Gallons Per Month	D*E Monthly Gallons per cart	F12 Pounds Per Gallon	H*I Monthly Pounds per cart	F16 \$ Per Pound	J*K \$ Per Home Per Month	C*L Monthly Amount	Pounds per Week
32S - 32 gallon service	685	32	4.33	94,914	138.56	0.33	45.97	\$ 0.0050	\$ 0.23	\$ 156.58	10.61
64S - 64 gallon service	3,755	64	4.33	1,040,586	277.12	0.33	91.95	\$ 0.0050	\$ 0.46	\$ 1,716.68	21.22
96S - 96 gallon service	1,482	96	4.33	616,038	415.68	0.33	137.92	\$ 0.0050	\$ 0.69	\$ 1,016.29	31.83
	5,922			1,751,538						\$ 2,889.56	

Average Residential + MF MSW Tons Per Month

290.58

MSW Cost Increase Per Month w/out franchise fees

\$ 2,626.87

\$ 94.09 Simi Valley Landfill - 2025 Tip Fee (LA County) - See See SWRA Supporting Information
 \$ 103.13 Simi Valley Landfill - 2026 Tip Fee (LA County) - See See SWRA Supporting Information
 \$ 9.04 Rate Change

MSW Cost Increase Per Month with franchise fees

\$ 2,889.56

Average Residential MSW Pounds Per Month
(tons * 2000)

581,167

Average Pounds Per Gallon

0.33

MSW Cost Per Ton Increase

\$ 9.04

MSW Cost Per Pound

\$ 0.0045

Franchise Fee %

10.00%

Rate Per Pound Including Franchise Fees

\$ 0.0050

5.3.2 Solid Waste Rate Adjustments

In addition to the annual escalation provided in subsection 5.3.1, commencing with the rate year commencing on July 1, 2018, but not more often than annually, Company may apply for an increase in the Solid Waste rates if Company can demonstrate that Company's operational costs have substantially increased in an amount greater than the CPI adjustment pursuant to subsection 5.3.1. For the purpose of this subsection, operational costs shall be defined as: motor vehicle fuel, insurance, Company's personnel costs (salaries and benefits), equipment repair costs, landfill and processing fee, tipping fees, and equipment purchases. When applying for an increase, Company shall submit to City, by October 30, information in support of the adjustment. Additional factors to be taken into consideration in connection with the adjustment request will include, but are not limited to:

- Overall customer satisfaction with Company.
- Company's satisfactory compliance with all provisions of this Agreement.
- Company's compliance with Solid Waste diversion requirements as defined and mandated by the State of California and implemented by the City of Agoura Hills.

MSW Bin Service

Average yards per month

3,262.75

Average tons per month

130.51

Average pound per yard

80.00

MSW Cost Per Ton Increase

\$ 9.04

Increased expense per month for bin MSW

\$ 1,179.81

Rate adjustment per yard before franchise fees

\$ 0.36

Rate adjustment per yard including franchise fees

10.00% \$ 0.40

Rate Verification:

\$ 1,179.81 monthly increase = \$4.01 times 131 tons per month

\$ 117.98 franchise fees - 10%

\$ 1,292.05 total monthly cost increase = 3,262.75 yards at \$0.18 per yard

Service

Service	Cont Size	Frequency	Monthly Yards	Monthly increase
MSW 1.5 X 1	1.5	1	6.50	\$ 2.57
MSW 1.5 X 2	1.5	2	12.99	\$ 5.14
MSW 1.5 X 3	1.5	3	19.49	\$ 7.72
MSW 1.5 X 4	1.5	4	25.98	\$ 10.29
MSW 1.5 X 5	1.5	5	32.48	\$ 12.86
MSW 1.5 X 6	1.5	6	38.97	\$ 15.43
MSW 3.0 X 1	3.0	1	12.99	\$ 5.14
MSW 3.0 X 2	3.0	2	25.98	\$ 10.29
MSW 3.0 X 3	3.0	3	38.97	\$ 15.43
MSW 3.0 X 4	3.0	4	51.96	\$ 20.58
MSW 3.0 X 5	3.0	5	64.95	\$ 25.72
MSW 3.0 X 6	3.0	6	77.94	\$ 30.86
MSW 4.0 X 1	4.0	1	17.32	\$ 6.86
MSW 4.0 X 2	4.0	2	34.64	\$ 13.72
MSW 4.0 X 3	4.0	3	51.96	\$ 20.58
MSW 4.0 X 4	4.0	4	69.28	\$ 27.43
MSW 4.0 X 5	4.0	5	86.60	\$ 34.29
MSW 4.0 X 6	4.0	6	103.92	\$ 41.15

Homes Per Month	C # of Carts	D Container Size	E Weeks Per Month	F Gallons Per Month
32G - 32 gallon service	185	32	4.33	25,634
64G - 64 gallon service	2,367	64	4.33	655,943
96G - 96 gallon service	2,838	96	4.33	1,179,700
	5,390			1,861,277

Average Residential + MF Organics Tons Per Month

419.79

Organics Cost Increase Per Month w/out franchise fees

\$ 2,307.14

Organics Cost Increase Per Month with franchise fees

\$ 2,537.86

Average Residential Organics Pounds Per Month
(tons * 2000)

839,587

Average Pounds Per Gallon

0.45

Organics Cost Per Ton Increase

\$ 5.50

Organics Cost Per Pound

\$ 0.0027

Franchise Fee %

10.00%

Rate Per Pound Including Franchise Fees

\$ 0.0030

Organic Bin Service

Average yards per month

-

Average tons per month

-

Average pound per yard

-

Organics Cost Per Ton Increase

\$ -

Increased expense per month for bin Organics

\$ -

Rate adjustment per yard before franchise fees

0

Rate adjustment per yard including franchise fees

10.00% \$ -

Service

Organics 3YD X 1

Cont Size	Frequency	Monthly Yards	Monthly increase
3.0	1	12.99	\$ -

D*E Monthly Gallons per cart	F12 Pounds Per Gallon	H*I Monthly Pounds per cart	F16 \$ Per Pound	J*K \$ Per Home Per Month	C*L Monthly Amount	Pounds per Week
138.56	0.45	62.50	\$ 0.0030	\$ 0.19	\$ 34.95	14.42
277.12	0.45	125.00	\$ 0.0030	\$ 0.38	\$ 894.38	28.85
415.68	0.45	187.51	\$ 0.0030	\$ 0.57	\$ 1,608.52	43.27
					\$ 2,537.86	

**For backup documentation, see See SWRA Supporting Information

\$ 75.40 Calabasas Landfill - 2025 Rate \$ 93.70 Simi Valley Landfill - 2025 Tip Fee (LA County)

\$ 79.17 Calabasas Landfill - 2026 Rate \$ 102.70 Simi Valley Landfill - 2026 Tip Fee (LA County)

\$ 3.77 Rate Change \$ 9.00 Rate Change

67% Weighting based on OPUS Disposal Cycle De 33% Weighting based on OPUS Disposal Cycle Detail Reports

\$ 2.53 \$ 2.97

1.1.38 Solid Waste

"Solid Waste" has the meaning defined in Public Resources Code Section 40191, including all putrescible and nonputrescible solid and semi-solid waste, generated in or upon, related to the occupancy or, remaining in or emanating from residential premises or commercial premises, including Recyclable Materials, Green Waste, Organic Waste, garbage, trash, refuse, paper, rubbish, ashes, industrial waste, demolition and construction wastes, discarded home and industrial appliances, manure, vegetable or animal solid wastes, other solid and semi-solid waste, excluding liquid wastes, abandoned vehicles, hazardous and medical waste.

Notes: There are 3 customers in MAS with Organic Bin service; however, they are routed to a trash route ID.

Homes Per Month	C # of Carts	D Container Size	E Weeks Per Month	F Gallons Per Month	D*E Monthly Gallons per cart	F12 Pounds Per Gallon	H*I Monthly Pounds per cart	F16 \$ Per Pound	J*K \$ Per Home Per Month	C*L Monthly Amount	Pounds per Week
S32 - 32 gallon service	45	32	4.33	6,235	138.56	0.18	25.41	\$ 0.0085	\$ 0.22	\$ 9.75	5.87
S64 - 64 gallon service	5,645	64	4.33	1,564,342	277.12	0.18	50.83	\$ 0.0085	\$ 0.43	\$ 2,446.00	11.73
S96 - 96 gallon service	895	96	4.33	372,034	415.68	0.18	76.24	\$ 0.0085	\$ 0.65	\$ 581.71	17.60
	6,585			1,942,611						\$ 3,037.46	

Average Residential + MF Recycling Tons Per Month

178.15

Recycling Cost Increase Per Month w/out franchise fees

\$ 2,761.33

Recycling Cost Increase Per Month with franchise fees

\$ 3,037.46

Average Residential Recycling Pounds Per Month
(tons * 2000)

356,301

Average Pounds Per Gallon

0.18

Recycling Cost Per Ton Increase

\$ 15.50

Recycling Cost Per Pound

\$ 0.0078

Franchise Fee %

10.00%

Rate Per Pound Including Franchise Fees

\$ 0.0085

\$ 93.00 Gold Coast Recycle 2025 - See SWRA Supporting Information
 \$ 108.50 Sun Valley Recycle Park (SVRP) 2026 - See SWRA Supporting Information
 \$ 15.50 Rate Change

Recycling Bin Service

Average yards per month

626.12

Average tons per month

25.04

Average pound per yard

80.00

Recycling Cost Per Ton Increase

\$ 15.50

Increased expense per month for bin MSW

\$ 388.19

Rate adjustment per yard before franchise fees

\$ 0.62

Rate adjustment per yard including franchise fees

10.00% \$ 0.68

Rate Verification:

\$ 388.19 monthly increase = \$4.01 times 131 tons per month

\$ 38.82 franchise fees - 10%

\$ 427.01 total monthly cost increase = 3,262.75 yards at \$0.18 per yard

Service

Service	Cont Size	Frequency	Monthly Yards	Monthly increase
1.5 YD 1X Per Week Recycle	1.5	1	6.50	\$ 4.43
1.5 YD 2X Per Week Recycle	1.5	2	12.99	\$ 8.86
1.5 YD 3X Per Week Recycle	1.5	3	19.49	\$ 13.29
1.5 YD 4X Per Week Recycle	1.5	4	25.98	\$ 17.72
1.5 YD 5X Per Week Recycle	1.5	5	32.48	\$ 22.15
1.5 YD 6X Per Week Recycle	1.5	6	38.97	\$ 26.58
3.0 YD 1X Per Week Recycle	3.0	1	12.99	\$ 8.86
3.0 YD 2X Per Week Recycle	3.0	2	25.98	\$ 17.72
3.0 YD 3X Per Week Recycle	3.0	3	38.97	\$ 26.58
3.0 YD 4X Per Week Recycle	3.0	4	51.96	\$ 35.44
3.0 YD 5X Per Week Recycle	3.0	5	64.95	\$ 44.30
3.0 YD 6X Per Week Recycle	3.0	6	77.94	\$ 53.16
4.0 YD 1X Per Week Recycle	4.0	1	17.32	\$ 11.81
4.0 YD 2X Per Week Recycle	4.0	2	34.64	\$ 23.62
4.0 YD 3X Per Week Recycle	4.0	3	51.96	\$ 35.44
4.0 YD 4X Per Week Recycle	4.0	4	69.28	\$ 47.25
4.0 YD 5X Per Week Recycle	4.0	5	86.60	\$ 59.06
4.0 YD 6X Per Week Recycle	4.0	6	103.92	\$ 70.87

AGOURA HILLS 2026 PROPOSED RATES

Curbside Service	Trash Cart	Recycle Cart	Yard Cart	2025	2026
Minican	Blue 32	Grey 64	Green 96	\$ 23.57	\$25.00
Level 1	Blue 64	Grey 64	Green 96	\$ 29.35	\$31.14
Level 2	Blue 96	Grey 64	Green 96	\$ 36.63	\$38.86
Level 3	2- Blue 64	Grey 64	Green 96	\$ 63.58	\$67.46
Level 4	1-64 & 1-96	Grey 64	Green 96	\$ 71.47	\$75.82
Level 5	2-96 Blue	Grey 64	Green 96	\$ 72.83	\$77.26

6.09%
6.09%
6.09%
6.10%
6.09%
6.08%

approved 3% CPI and 3% SWRA
Previous MFN Protection

Condos/Townhomes	Trash Cart	Recycle Cart	Yard Cart	2025	2026
	Blue 32	Grey 64	N/A	\$18.30	\$19.42
	Blue 64	Grey 64	N/A	\$26.90	\$28.55
	Blue 96	Grey 64	N/A	\$31.88	\$33.83
Valet/Pull out service	Valet service			\$20.00	\$21.22

6.11%
6.12%
6.10%
6.09%

START CHARGE: \$26.01

SERVICE OPTIONS:

Cut Off Restart Fee	\$25.36
Credit Card Convenience Fee	\$10.52
Senior Discount	15%
3rd Additional 96 Trash Cart (See level 5)	\$26.90
Each Additional 64gal Trash Cart	\$14.47
Additional 64gal Recycle Cart	N/A for 2nd
Additional 64gal Recycle Cart (after 2nd)	\$5.79
Additional 96gal Recycle Cart	\$6.05
Additional 96gal Yard Cart	\$5.01
Manure Cart 96gal	\$13.45
Recycle Contamination Fee	\$31.50
Green Waste Contamination Fee	\$31.50
Extra Pick Up Bags Pick Up Days	\$4.35
Extra Pick Up Carts Pick Up Days	\$7.29
Extra Pick Up Non-pick up days	\$36.23
Bulky Item Pick Up	NO CHARGE 4 ITEMS TOTAL/2 TRIP
Additional Bulkies	\$34.13

2026 RESIDENTIAL & MULTI-FAMILY BIN SERVICE

TRASH BIN RATES

		2025	2026		2025	2026		
<u>1.5yd Trash:</u>	1x week	\$98.16	\$104.13	4x week	\$313.33	\$332.41	6.08%	6.09%
	2x week	\$176.42	\$187.16	5x week	\$389.83	\$413.58	6.09%	6.09%
	3x week	\$247.57	\$262.65	6x week	\$461.01	\$489.08	6.09%	6.09%
<u>3yd Trash:</u>	1x week	\$111.63	\$118.43	4x week	\$398.40	\$422.66	6.09%	6.09%
	2x week	\$205.38	\$217.89	5x week	\$489.47	\$519.27	6.09%	6.09%
	3x week	\$307.34	\$326.06	6x week	\$580.55	\$615.91	6.09%	6.09%
<u>4yd Trash:</u>	1x week	\$121.06	\$128.43	4x week	\$445.50	\$472.62	6.09%	6.09%
	2x week	\$222.76	\$236.32	5x week	\$556.87	\$590.79	6.09%	6.09%
	3x week	\$330.26	\$350.37	6x week	\$667.06	\$707.68	6.09%	6.09%

RECYCLING BIN RATES

		2025	2026		2025	2026		
<u>1.5yd Recycle:</u>	1x week	\$41.93	\$44.49	4x week	\$167.08	\$177.25	6.10%	6.09%
	2x week	\$83.53	\$88.62	5x week	\$208.66	\$221.37	6.10%	6.09%
	3x week	\$125.13	\$132.75	6x week	\$250.40	\$265.65	6.09%	6.09%
<u>3yd Recycle:</u>	1x week	\$49.88	\$52.92	4x week	\$189.68	\$201.23	6.10%	6.09%
	2x week	\$98.15	\$104.12	5x week	\$235.29	\$249.62	6.09%	6.09%
	3x week	\$143.76	\$152.51	6x week	\$281.00	\$298.11	6.09%	6.09%
<u>4yd Recycle:</u>	1x week	\$56.53	\$59.98	4x week	\$206.97	\$219.58	6.10%	6.09%
	2x week	\$107.45	\$113.99	5x week	\$255.24	\$270.79	6.09%	6.09%
	3x week	\$158.34	\$167.98	6x week	\$303.64	\$322.13	6.09%	6.09%

MANURE BIN RATES

		2025	2026	
<u>3yd Manure:</u>	1x week	\$163.28	\$173.22	6.09%

VALET SERVICE

		2025	2026		
<u>Valet</u>	1x week	\$47.60	\$50.50	\$47.60 for 2025	6.09%
	2x week	\$61.10	\$64.82	step up agreement	6.08%
	3x week	\$91.39	\$96.96		6.09%

City of Agoura Hills
2026 Solid Waste Rate Adjustment (SWRA)
Supporting Information

Disposal Cost Change Supporting Information

2025 Simi Valley Landfill and Recycling Center (SVLRC) Service and Fee Schedule	Page 2
2026 Simi Valley Landfill and Recycling Center (SVLRC) Service and Fee Schedule	Page 3

Organics Processing Cost Change Supporting Information

Calabasas Landfill Fee Schedule - Effective January 1, 2025	Page 4
Calabasas Landfill Fee Schedule - Effective October 6, 2025	Page 5
2025 Simi Valley Landfill and Recycling Center (SVLRC) Service and Fee Schedule	Page 6
2026 Simi Valley Landfill and Recycling Center (SVLRC) Service and Fee Schedule	Page 7

Recyclables Processing Cost Change Supporting Information

Gold Coast Recycling & Transfer Station Letter	Page 8
Sun Valley Recycling Park (SVRP) Letter	Page 9

Disposal Cost Change Supporting Information

2025 Simi Valley Landfill and Recycling Center (SVLRC) Service and Fee Schedule

EXHIBIT 1

SIMI VALLEY LANDFILL AND RECYCLING CENTER

Jan. 1 - Dec. 31, 2025

Service and Fee Schedule

Disposal Materials*	Ventura County (or outside CA)	Non-Ventura County (within CA)**
Municipal Solid Waste (MSW)	\$90.00 per ton	\$94.09 per ton
MSW - Transfer Trailers	\$58.05 per ton	\$62.05 per ton
MSW - Pickup trucks to height of cab or trailers 8 feet and under***	\$51.00 per load	\$55.00 per load
MSW - Cars up to 500 lbs.	\$35.50 min.	\$39.50 min.
Recycling Materials*		
Construction & Demolition (C&D) for Processing	\$108.50 per ton	\$112.80 per ton
C&D - Pickup trucks to height of cab or trailers 8 feet and under***	\$75.25 per ton	\$79.25 per ton
C&D Certification	\$15.05 per ton	\$15.05 per ton
Asphalt (clean only)	\$43.00 per ton	\$47.00 per ton
Concrete (clean only)	\$43.00 per ton	\$47.00 per ton
Dirt (clean only)	\$40.85 per ton	\$44.85 per ton
Food Waste	\$138.25 per ton	\$148.25 per ton
Bagged, Commingled Food Waste	\$100.85 per ton	\$104.85 per ton
Greenwaste and Wood	\$89.70 per ton	\$93.70 per ton
Greenwaste and Wood - Pickup trucks to height of cab or trailers 8 feet and under***	\$58.05 per load	\$62.30 per load
Special Handling Waste* Requires Pre-Approval		
Drums	\$145.10 ea.	\$145.10 ea.
Industrial, Process, Sewage Sludge	\$94.60 per ton	\$98.60 per ton
Non-Friable Asbestos	\$185.98 per ton	\$195.98 per ton
Preservative Treated Wood	\$111.20 per ton	\$115.20 per ton
Treated Medical Waste	\$111.20 per ton	\$115.20 per ton
Other Materials*		
Appliances	\$24.75 ea.	\$24.75 ea.
Dead Livestock	\$167.70 ea.	\$171.70 ea.
Hard-to-handle items (case by case basis)	\$129 - \$344 ea.	\$129 - \$344 ea.
Tires: Motorcycle/Passenger/Pickup truck	\$14.50 ea.	\$14.50 ea.
Tires: Large Truck	\$39.75 ea.	\$39.75 ea.
Tires: Off-Road/Heavy Equipment	\$306.50 ea.	\$306.50 ea.
Vehicle Weights Only	\$15.05 ea.	\$15.05 ea.

Non-Acceptable Materials
All hazardous materials are prohibited including but not limited to:

- Automotive bodies and fluids (fuel, antifreeze, oils)
- Batteries
- Biological/Medical Waste
- Chemicals of any kind (pool, pesticides, weed killer)
- Electronic Waste of any kind
- Empty Containers (that may have contained or have contained hazardous materials)
- Fluorescent Light Tubes and Ballasts
- Liquids
- Paint, lacquer, stain, thinner, varnish and wood preservatives
- Radioactive Materials
- Septic Tank or Chemical Toilet Waste
- Universal Waste
- Water-Soluble Solids (salts, borax, lye, caustics/ acids)

All Ventura County customers exceeding one (1) ton (excluding local jurisdiction Contract Collectors) will be required to complete a "Waste Origin Reporting Form."

State law requires all loads to be securely covered.

* CWMWP of \$.05 per ton collected on all disposed tons, excluding waste collected from Contract Collectors with any Ventura County jurisdiction.

** Non-Ventura County materials originating within California.

*** Per ton fee will apply if any minimum vehicle exceeds one (1) ton.

For information about the proper disposal of prohibited materials, household hazardous waste collection events and other waste and recycling services, please contact your local waste hauler, City or County.

City of Simi Valley	simivalley.org	(805) 583-6321
City of Moorpark	moorparkca.gov	(805) 517-6241
City of Thousand Oaks	toaks.org	(805) 449-7283
County of Ventura	vcpubliworks.org	(805) 658-4323

Location:
2801 N. Madera Road, Simi Valley, CA 93065
Phone (805) 579-7267 Fax (805) 579-7482

Hours of Operation
Monday - Saturday 7:00 a.m. - 4:00 p.m.
3rd Sunday of each month 10:00 a.m. - 4:00 p.m.
All vehicles must be unloaded by 4:30 p.m. Mon. - Sat.
No refunds for partially unloaded vehicles.

Payment Information
Credit or Debit Cards only, no cash or checks.
One (1) ton minimum on all per ton fees.
To open an account, call (805) 579-7267.
Volume discounts available by contract.

We reserve the right to refuse any load.
Please adhere to all safety guidelines at
Waste Management's facility.

2026 Simi Valley Landfill and Recycling Center (SVLRC) Service and Fee Schedule



SIMI VALLEY LANDFILL AND RECYCLING CENTER

Jan. 1 - Dec. 31, 2026

Service and Fee Schedule

Disposal Materials*	Ventura County (or outside CA)	Non-Ventura County (within CA)**
Municipal Solid Waste (MSW)	\$98.65 per ton	\$103.13 per ton
MSW - Pickup trucks to height of cab or trailers 8 feet and under***	\$62.47 per load	\$66.86 per load
MSW - Cars up to 500 lbs.	\$38.91 min.	\$43.29 min.
Recycling Materials*		
Construction & Demolition (C&D) for Processing	\$118.92 per ton	\$123.63 per ton
C&D - Pickup trucks to height of cab or trailers 8 feet and under***	\$82.47 per ton	\$86.86 per ton
C&D Certification	\$16.49 per ton	\$16.49 per ton
Asphalt (clean only)	\$47.13 per ton	\$51.51 per ton
Concrete (clean only)	\$47.13 per ton	\$51.51 per ton
Dirt (clean only)	\$44.77 per ton	\$49.16 per ton
Food Waste	\$151.52 per ton	\$162.48 per ton
Bagged, Commingled Food Waste	\$110.53 per ton	\$114.92 per ton
Greenwaste and Wood	\$98.31 per ton	\$102.70 per ton
Greenwaste and Wood - Pickup trucks to height of cab or trailers 8 feet and under***	\$63.62 per load	\$68.28 per load
Special Handling Waste* Requires Pre-Approval		
Drums	\$159.03 ea.	\$159.03 ea.
Industrial, Process, Sewage Sludge	\$103.68 per ton	\$108.07 per ton
Non-Friable Asbestos	\$203.83 per ton	\$214.79 per ton
Preservative Treated Wood	\$121.88 per ton	\$126.26 per ton
Treated Medical Waste	\$121.88 per ton	\$126.26 per ton
Other Materials*		
Appliances	\$27.13 ea.	\$27.13 ea.
Dead Livestock	\$183.80 ea.	\$188.18 ea.
Hard-to-handle items (case by case basis)	\$141-\$377 ea.	\$141-\$377 ea.
Tires: Motorcycle/Passenger/Pickup truck	\$15.89 ea.	\$15.89 ea.
Tires: Large Truck	\$43.57 ea.	\$43.57 ea.
Tires: Off-Road/Heavy Equipment	\$335.92 ea.	\$335.92 ea.
Vehicle Weights Only	\$16.49 ea.	\$16.49 ea.

Non-Acceptable Materials

All hazardous materials are prohibited including but not limited to:

- Automotive bodies and fluids (fuel, antifreeze, oils)
- Batteries
- Biological/Medical Waste
- Chemicals of any kind (pool, pesticides, weed killer)
- Electronic Waste of any kind
- Empty Containers (that may have contained or have contained hazardous materials)
- Fluorescent Light Tubes and Ballasts
- Liquids
- Paint, lacquer, stain, thinner, varnish and wood preservatives
- Radioactive Materials
- Septic Tank or Chemical Toilet Waste
- Universal Waste
- Water-Soluble Solids (salts, borax, lye, caustics/ acids)

All Ventura County customers exceeding one (1) ton (excluding local jurisdiction Contract Collectors) will be required to complete a "Waste Origin Reporting Form."

State law requires all loads to be securely covered.

* CIWMP of \$.05 per ton collected on all disposed tons, excluding waste collected from Contract Collectors with any Ventura County jurisdiction.

** Non-Ventura County materials originating within California.

*** Per ton fee will apply if any minimum vehicle exceeds one (1) ton.

For information about the proper disposal of prohibited materials, household hazardous waste collection events and other waste and recycling services, please contact your local waste hauler, City or County.

City of Simi Valley	simivalley.org	(805) 583-6321
City of Moorpark	moorparkca.gov	(805) 517-6241
City of Thousand Oaks	toaks.org	(805) 449-7283
County of Ventura	vcpubliworks.org	(805) 658-4323

Location:

2801 N. Madera Road, Simi Valley, CA 93065
Phone (805) 579-7267 Fax (805) 579-7482

Hours of Operation

Monday - Saturday 7:00 a.m. - 4:00 p.m.
3rd Sunday of each month 10:00 a.m. - 4:00 p.m.
All vehicles must be unloaded by 4:30 p.m. Mon. - Sat.
No refunds for partially unloaded vehicles.

Payment Information

Credit or Debit Cards only, no cash or checks.
One (1) ton minimum on all per ton fees.
To open an account, call (805) 579-7267.
Volume discounts available by contract.

We reserve the right to refuse any load.
Please adhere to all safety guidelines at Waste Management's facility.

Organics Processing Cost Change Supporting Information

Calabasas Landfill Fee Schedule - Effective January 1, 2025

EXHIBIT 1	d. Calabasas Sanitary Landfill Scholl Canyon Sanitary Landfill
Rates	
Effective July 1, 2025	
MATERIALS RECOVERY FACILITIES (MRF) +	
LANDFILLS -	
<u>Calabasas Landfill, Agoura</u> , ^{1,2,3,5}	
Type of Solid Waste/Recyclables	Rate
Municipal Solid and Inert Waste	\$75.40 per ton
Hard-to-Handle, Bulky Items	\$90.40 per ton
Untamminated Green Waste (green waste mixed with less than one percent [1%] waste material that is not green waste)	\$69.39 per ton
Acceptable Green Waste (green waste mixed with between one percent [1%] and three percent [3%] waste material that is not green waste)*	\$75.40 per ton
Contaminated Green Waste	\$90.40 per ton
Tires	\$185.00 per ton
Special Handling	\$90.40 per ton
Clean, segregated asphalt	FREE
Pull-Offs	\$54.40 per load
*Note: Contaminated Green Waste will be charged the Hard to Handle rate.	
<u>Scholl Canyon Landfill, Glendale</u> ^{1,2,3,6}	
Type of Solid Waste/Recyclables	Rate
Municipal Solid and Inert Waste	\$95.46 per ton
Hard-to-Handle, Bulky Items	\$110.46 per ton
Segregated Untamminated Green Waste*	\$115.13 per ton
Food Waste / Green Waste Program [†]	\$136.05 per ton
Tires	\$134.73 per ton
Special Handling	\$110.46 per ton
Clean, segregated asphalt **	\$30.00 per ton
Clean Dirt*** (All rates are subject to change and can be adjusted after a one-week notice period.)	\$7.50 per ton
-Minimum Charge	\$20.00 per load
Pull-Offs	\$54.40 per load
*Note: Contaminated Green Waste will be charged the Hard to Handle rate.	
**Note: All rates are subject to change and can be adjusted after a one-week notice period to prevent exceeding daily tonnage limit for green waste and refuse.	
***Note: To see if Scholl Canyon Landfill is currently accepting clean dirt, please call the Scholl Canyon Landfill scale house at 562-908-4288 Ext 4751 or 4752.	

City of Agoura Hills - Solid Waste Rate Adjustment (SWRA)
Supporting Information

Calabasas Landfill Fee Schedule - Effective October 6, 2025

<https://www.lacsd.org/services/solid-waste/tipping-fees-for-solid-waste-and-recyclables>

Calabasas Landfill, Agoura,^{1,2,3,5}

Type of Solid Waste/Recyclables	Rate
Municipal Solid and Inert Waste	\$79.17 per ton
Hard-to-Handle, Bulky Items	\$94.17 per ton
Segregated Uncontaminated Green Waste	\$71.75 per ton
Tires	\$185.00 per ton
Special Handling	\$94.17 per ton
Clean, segregated asphalt	\$20.00 per ton
Pull-Offs	\$57.12 per load

2025 Simi Valley Landfill and Recycling Center Service and Fee Schedule



Jan. 1 - Dec. 31, 2025

Service and Fee Schedule

Disposal Materials*	Ventura County (or outside CA)	Non-Ventura County (within CA)**
Municipal Solid Waste (MSW)	\$90.00 per ton	\$94.09 per ton
MSW - Transfer Trailers	\$58.05 per ton	\$62.05 per ton
MSW - Pickup trucks to height of cab or trailers 8 feet and under***	\$51.00 per load	\$55.00 per load
MSW - Cars up to 500 lbs.	\$35.50 min.	\$39.50 min.
Recycling Materials*		
Construction & Demolition (C&D) for Processing	\$108.50 per ton	\$112.80 per ton
C&D - Pickup trucks to height of cab or trailers 8 feet and under***	\$75.25 per ton	\$79.25 per ton
C&D Certification	\$15.05 per ton	\$15.05 per ton
Asphalt (clean only)	\$43.00 per ton	\$47.00 per ton
Concrete (clean only)	\$43.00 per ton	\$47.00 per ton
Dirt (clean only)	\$40.85 per ton	\$44.85 per ton
Food Waste	\$138.25 per ton	\$148.25 per ton
Bagged, Commingled Food Waste	\$100.85 per ton	\$104.85 per ton
Greenwaste and Wood	\$89.70 per ton	\$93.70 per ton
Greenwaste and Wood - Pickup trucks to height of cab or trailers 8 feet and under***	\$58.05 per load	\$62.30 per load
Special Handling Waste* Requires Pre-Approval		
Drums	\$145.10 ea.	\$145.10 ea.
Industrial, Process, Sewage Sludge	\$94.60 per ton	\$98.60 per ton
Non-Friable Asbestos	\$185.98 per ton	\$195.98 per ton
Preservative Treated Wood	\$111.20 per ton	\$115.20 per ton
Treated Medical Waste	\$111.20 per ton	\$115.20 per ton
Other Materials*		
Appliances	\$24.75 ea.	\$24.75 ea.
Dead Livestock	\$167.70 ea.	\$171.70 ea.
Hard-to-handle items (case by case basis)	\$129 - \$344 ea.	\$129 - \$344 ea.
Tires: Motorcycle/Passenger/Pickup truck	\$14.50 ea.	\$14.50 ea.
Tires: Large Truck	\$39.75 ea.	\$39.75 ea.
Tires: Off-Road/Heavy Equipment	\$306.50 ea.	\$306.50 ea.
Vehicle Weights Only	\$15.05 ea.	\$15.05 ea.

Non-Acceptable Materials

All hazardous materials are prohibited including but not limited to:

- Automotive bodies and fluids (fuel, antifreeze, oils)
- Batteries
- Biological/Medical Waste
- Chemicals of any kind (pool, pesticides, weed killer)
- Electronic Waste of any kind
- Empty Containers (that may have contained or have contained hazardous materials)
- Fluorescent Light Tubes and Ballasts
- Liquids
- Paint, lacquer, stain, thinner, varnish and wood preservatives
- Radioactive Materials
- Septic Tank or Chemical Toilet Waste
- Universal Waste
- Water-Soluble Solids (salts, borax, lye, caustics/acids)

All Ventura County customers exceeding one (1) ton (excluding local jurisdiction Contract Collectors) will be required to complete a "Waste Origin Reporting Form."

State law requires all loads to be securely covered.

* CWMMP of \$.05 per ton collected on all disposed tons, excluding waste collected from Contract Collectors with any Ventura County jurisdiction.

** Non-Ventura County materials originating within California.

*** Per ton fee will apply if any minimum vehicle exceeds one (1) ton.

For information about the proper disposal of prohibited materials, household hazardous waste collection events and other waste and recycling services, please contact your local waste hauler, City or County.

City of Simi Valley	simivalley.org	(805) 583-6321
City of Moorpark	moorparkca.gov	(805) 517-6241
City of Thousand Oaks	toaks.org	(805) 449-7283
County of Ventura	vcpublicworks.org	(805) 658-4323

Location:

2801 N. Madera Road, Simi Valley, CA 93065
Phone (805) 579-7267 Fax (805) 579-7482

Hours of Operation

Monday - Saturday 7:00 a.m. - 4:00 p.m.
3rd Sunday of each month 10:00 a.m. - 4:00 p.m.
All vehicles must be unloaded by 4:30 p.m. Mon. - Sat.
No refunds for partially unloaded vehicles.

Payment Information

Credit or Debit Cards only, no cash or checks.
One (1) ton minimum on all per ton fees.
To open an account, call (805) 579-7267.
Volume discounts available by contract.

We reserve the right to refuse any load.
Please adhere to all safety guidelines at
Waste Management's facility.

2026 Simi Valley Landfill and Recycling Center Service and Fee Schedule



SIMI VALLEY LANDFILL AND RECYCLING CENTER

Jan. 1 - Dec. 31, 2026

Service and Fee Schedule

Disposal Materials*	Ventura County (or outside CA)	Non-Ventura County (within CA)**
Municipal Solid Waste (MSW)	\$98.65 per ton	\$103.13 per ton
MSW - Pickup trucks to height of cab or trailers 8 feet and under***	\$62.47 per load	\$66.86 per load
MSW - Cars up to 500 lbs.	\$38.91 min.	\$43.29 min.
Recycling Materials*		
Construction & Demolition (C&D) for Processing	\$118.92 per ton	\$123.63 per ton
C&D - Pickup trucks to height of cab or trailers 8 feet and under***	\$82.47 per ton	\$86.86 per ton
C&D Certification	\$16.49 per ton	\$16.49 per ton
Asphalt (clean only)	\$47.13 per ton	\$51.51 per ton
Concrete (clean only)	\$47.13 per ton	\$51.51 per ton
Dirt (clean only)	\$44.77 per ton	\$49.16 per ton
Food Waste	\$151.52 per ton	\$162.48 per ton
Bagged, Commingled Food Waste	\$110.53 per ton	\$114.92 per ton
Greenwaste and Wood	\$98.31 per ton	\$102.70 per ton
Greenwaste and Wood - Pickup trucks to height of cab or trailers 8 feet and under***	\$63.62 per load	\$68.28 per load
Special Handling Waste* Requires Pre-Approval		
Drums	\$159.03 ea.	\$159.03 ea.
Industrial, Process, Sewage Sludge	\$103.68 per ton	\$108.07 per ton
Non-Friable Asbestos	\$203.83 per ton	\$214.79 per ton
Preservative Treated Wood	\$121.88 per ton	\$126.26 per ton
Treated Medical Waste	\$121.88 per ton	\$126.26 per ton
Other Materials*		
Appliances	\$27.13 ea.	\$27.13 ea.
Dead Livestock	\$183.80 ea.	\$188.18 ea.
Hard-to-handle items (case by case basis)	\$141- \$377 ea.	\$141 - \$377 ea.
Tires: Motorcycle/Passenger/Pickup truck	\$15.89 ea.	\$15.89 ea.
Tires: Large Truck	\$43.57 ea.	\$43.57 ea.
Tires: Off-Road/Heavy Equipment	\$335.92 ea.	\$335.92 ea.
Vehicle Weights Only	\$16.49 ea.	\$16.49 ea.

Non-Acceptable Materials

All hazardous materials are prohibited including but not limited to:

- Automotive bodies and fluids (fuel, antifreeze, oils)
- Batteries
- Biological/Medical Waste
- Chemicals of any kind (pool, pesticides, weed killer)
- Electronic Waste of any kind
- Empty Containers (that may have contained or have contained hazardous materials)
- Fluorescent Light Tubes and Ballasts
- Liquids
- Paint, lacquer, stain, thinner, varnish and wood preservatives
- Radioactive Materials
- Septic Tank or Chemical Toilet Waste
- Universal Waste
- Water-Soluble Solids (salts, borax, lye, caustics/ acids)

All Ventura County customers exceeding one (1) ton (excluding local jurisdiction Contract Collectors) will be required to complete a "Waste Origin Reporting Form."

State law requires all loads to be securely covered.

* CIWMP of \$.05 per ton collected on all disposed tons, excluding waste collected from Contract Collectors with any Ventura County jurisdiction.

** Non-Ventura County materials originating within California.

*** Per ton fee will apply if any minimum vehicle exceeds one (1) ton.

For information about the proper disposal of prohibited materials, household hazardous waste collection events and other waste and recycling services, please contact your local waste hauler, City or County.

City of Simi Valley	simivalley.org	(805) 583-6321
City of Moorpark	moorparkca.gov	(805) 517-6241
City of Thousand Oaks	toaks.org	(805) 449-7283
County of Ventura	vcpublicworks.org	(805) 658-4323

Location:

2801 N. Madera Road, Simi Valley, CA 93065
Phone (805) 579-7267 Fax (805) 579-7482

Hours of Operation

Monday - Saturday 7:00 a.m. - 4:00 p.m.
3rd Sunday of each month 10:00 a.m. - 4:00 p.m.
All vehicles must be unloaded by 4:30 p.m. Mon. - Sat.
No refunds for partially unloaded vehicles.

Payment Information

Credit or Debit Cards only, no cash or checks.
One (1) ton minimum on all per ton fees.
To open an account, call (805) 579-7267.
Volume discounts available by contract.

We reserve the right to refuse any load.
Please adhere to all safety guidelines at
Waste Management's facility.

Recyclables Processing Cost Change Supporting Information

Gold Coast Recycling & Transfer Station Letter



November 17, 2022

Mark Grady
Waste Management
2801 Madera Rd.
Simi Valley, CA 93065

Dear Mark,

Due to the unpredictability of recycling markets, we will be increasing the processing rate to \$93 per ton effective November 1, 2022 for residential and commercial recycling material received from Waste Management. The increase includes the cost of residual disposal and associated trucking. OCC & Mixed paper continue to decline or remain flat. Berg Mill tells us the upcoming year will be challenging. This coupled with wage, fuel, and trucking increases, makes operating the facility at desired profitability levels difficult. Let me know if you have any questions or need additional information. We value your business and look forward to a continued relationship.

Sincerely,

A handwritten signature in blue ink, appearing to read "M. George Harrison II".

M. George Harrison II, GM



Sun Valley Recycling Park (SVRP) Letter



Sun Valley Recycling Park
9227 Tujunga Avenue
Sun Valley, CA 91352

October 25, 2025

Steve Lee, District Manager
G.I. Industries
195 W. Los Angeles Ave.
Simi Valley, CA 93065

Subject: 2026 Processing Fee Notice

Steve,

As a recycling customer of Sun Valley Recycling Park, we are writing to inform you of the upcoming change to processing fees, effective January 1, 2026. This increase reflects our efforts to meet quality standards amid challenges in the market for recycled commodities.

Single Stream Processing Fee (effective 1/1/2026) \$108.50/per ton

At Sun Valley Recycling Park, our goal is to maximize the value and diversion of materials delivered to our facility, which has increased our operational costs to reduce contamination to saleable levels and disposal costs for residual waste. We appreciate your attention in this matter. Please contact me at (626) 344-4807 if you have any questions or concerns about this notice.

Sincerely,

A handwritten signature in black ink, appearing to read 'Mark Grady', written over a white background.

Mark Grady
Area Director, Recycling Operations



Statement for Rate Review

Collection Reliability

Waste Management has always met or exceeded all collection requirements in accordance with the Residential Franchise Agreement. WM has furnished new start customers with necessary equipment within 24 hours of notice of start date. To date WM has never failed to complete any route collection service on a scheduled day, all miss picks will be collected within 24 hours of notification.

Collection Quality

Waste Management performs ongoing routine inspections on all residential carts to ensure containers are in good working order, left standing after collection and uniform color with appropriate markings. Never at any time do WM drivers leave a site that has had a spill occurrence, Route Supervisors are notified and clean up starts immediately. WM starts collection at 7 am as stated in the Franchise Agreement. All equipment requests are delivered within 24 to 48 hours, in some cases if possible same day.

Customer Responsiveness

At this time Waste Management has no unresolved complaints to address with any residential customer. WM is always quick to find solutions and resolve every issue because our Route Supervisors perform personal visits to each and every situation that may arise. WM is committed to providing the highest level of customer service. No equipment is allowed out of facility that is not in like new condition.

Timeliness of Submissions to the City

Pursuant to the Franchise Agreement, Waste Management is in compliance with all reporting requirements, quarterly and annually.

Accuracy of Billing

Waste Management has billed all residential customers by type of service, with a due date and in accordance with the approved rate schedule.

Implementation of Public Education Plan

Waste Management has performed all public education plans set forth to meet all required deadlines.

Imposition of Liquidated Damages

Waste Management is not aware of any occurrences of events at this time through customer complaints or other investigation that would require liquidated damages. WM has not received a notice from the city of an incident of non-performance.

Amount & Timing of Payment

Waste Management has never been assessed by the City of Agoura Hills to pay for an assessment of Liquidated Damages.

Extension of Time of Performance

Since the inception of the Franchise Agreement July 2007 there has not been any interruption or discontinuance of service due to natural causes or other. WM has never asked for an extension for delayed services.

Assurance of Performance

Waste Management has made a commitment to the City of Agoura Hills to provide world class service to their customers and the environment. At no time during the beginning of the Franchise Agreement has WM provided untimely or unsatisfactory service.

City of Calabasas Residential Rates

1-Jul-25

Service Level	2025 Rate
Resi 32 gallon	\$ 26.12
Resi 64 gallon	\$ 37.58
Resi 96 gallon	\$ 45.25
Condo 32 gallon	\$ 20.91
Condo 64 gallon	\$ 32.39
Condo 96 gallon	\$ 40.02
Valet 32 gallon	\$ 52.42
Valet 64 gallon	\$ 63.92
Valet 96 gallon	\$ 71.55

Non - Valet

Cut off/Restart	\$ 25.89
Credit Card Fee	\$ 10.47
Setup Fee	\$ 21.22
Cancellation Fee	\$ 19.21
Delinquent Pmt Fee	\$ 6.40
Return Check Fee	\$ 19.21
IVR Payment Fee	\$ 6.40
Redelivery Fee	\$ 19.21
Container Exchange	\$ 25.61
Lost/Damage Cart	\$ 76.80
Service Level Chg	\$ 6.40
Add'l 96G Trash	\$ 12.24
Add'l 64G Trash	\$ 7.67
Add'l 96G REC	\$ -
Add'l 96G GW	\$ -
Extra Bag pickup	\$ 4.41
Extra Cart pickup	\$ 7.36
Xtra cart off day	\$ 36.75
Bulky items	\$ -
Add'l Bulkies	\$ 33.24
- <i>per item</i>	\$ 19.94

Valet

Cut off/Restart	\$ 25.89
Credit Card Fee	\$ 10.47
Setup Fee	\$ 21.22
Cancellation Fee	\$ 19.21
Delinquent Pmt Fee	\$ 6.40

Return Check Fee	\$ 19.21
IVR Payment Fee	\$ 6.40
Redelivery Fee	\$ 19.21
Container Exchange	\$ 25.61
Lost/Damage Cart	\$ 76.80
Service Level Chg	\$ 6.40
Add'l 96G Trash	\$ 21.40
Add'l 64G Trash	\$ 16.68
Add'l 96G REC	\$ -
Add'l 96G GW	\$ -
Extra Bag pickup	\$ 4.41
Extra Cart pickup	\$ 7.36
Xtra cart off day	\$ 36.75
Bulky items	\$ -
Add'l Bulkies	\$ 33.24
- per item	\$ 19.94

City of Calabasas Commercial Rates

1-Jul-25

Service Level	2025 Rate
1.5CY MSW 1 x week	\$ 113.23
1.5CY MSW 2 x week	\$ 208.34
1.5CY MSW 3 x week	\$ 312.51
1.5CY MSW 4 x week	\$ 416.66
1.5CY MSW 5 x week	\$ 520.83
1.5CY MSW 6 x week	\$ 625.02
3CY MSW 1 x week	\$ 123.72
3CY MSW 2 x week	\$ 227.60
3CY MSW 3 x week	\$ 341.39
3CY MSW 4 x week	\$ 455.75
3CY MSW 5 x week	\$ 568.99
3CY MSW 6 x week	\$ 682.84
4CY MSW 1 x week	\$ 134.15
4CY MSW 2 x week	\$ 246.85
4CY MSW 3 x week	\$ 366.00
4CY MSW 4 x week	\$ 493.71
4CY MSW 5 x week	\$ 617.13
4CY MSW 6 x week	\$ 740.56
6CY MSW 1 x week	\$ 155.10
6CY MSW 2 x week	\$ 285.38
6CY MSW 3 x week	\$ 428.07
6CY MSW 4 x week	\$ 713.37
6CY MSW 5 x week	\$ 855.98
1.5CY REC 1 x week	\$ 56.62
1.5CY REC 2 x week	\$ 104.17
1.5CY REC 3 x week	\$ 156.25
1.5CY REC 4 x week	\$ 208.32
1.5CY REC 5 x week	\$ 260.42
1.5CY REC 6 x week	\$ 312.52
3CY REC 1 x week	\$ 61.86
3CY REC 2 x week	\$ 113.80
3CY REC 3 x week	\$ 170.69
3CY REC 4 x week	\$ 227.88
3CY REC 5 x week	\$ 284.51
3CY REC 6 x week	\$ 341.42
4CY REC 1 x week	\$ 67.09
4CY REC 2 x week	\$ 123.43
4CY REC 3 x week	\$ 183.00

4CY REC 4 x week	\$	246.85
4CY REC 5 x week	\$	308.57
4CY REC 6 x week	\$	370.28
6CY REC 1 x week	\$	77.56
6CY REC 2 x week	\$	142.69
6CY REC 3 x week	\$	214.04
6CY REC 4 x week	\$	356.68
6CY REC 5 x week	\$	428.00

Organics

35 gallon 1 x week	\$	70.41
35 gallon 2 x week	\$	140.81
35 gallon 3 x week	\$	211.22
65 gallon 1 x week	\$	70.41
65 gallon 2 x week	\$	140.81
65 gallon 3 x week	\$	211.22

Additional Services

Cut off / Restart Fee	\$	25.87
Extra P/U with Support	\$	85.02
Extra P/U 1.5 CY MSW	\$	62.28
Extra P/U 3 CY MSW	\$	61.86
Extra P/U 4 CY MSW	\$	60.37
Extra P/U 6 CY MSW	\$	59.84
Extra P/U 1.5 CY REC	\$	28.31
Extra P/U 3 CY REC	\$	30.92
Extra P/U 4 CY REC	\$	33.53
Set up Fee	\$	20.70
Lock Charge	\$	14.54
Pull out service	\$	58.78
Bulkies 2 items	\$	58.21
Add'l Bulkies	\$	19.40

Rolloff-Perm

Trash	\$	257.16
Prepaid Three Tons	\$	281.03
Green	\$	257.16
OCC	\$	257.16
Inert	\$	257.16
Delivery Fee	\$	108.81
Trip / Relocate Fee	\$	108.81
Daily Rental (after 30 days)	\$	15.99
IAB	\$	203.57
IAB Trip Fee	\$	48.98

IAB Relocate Fee

\$ 48.98

IAB Daily Rental (after 7 days)

\$ 14.01

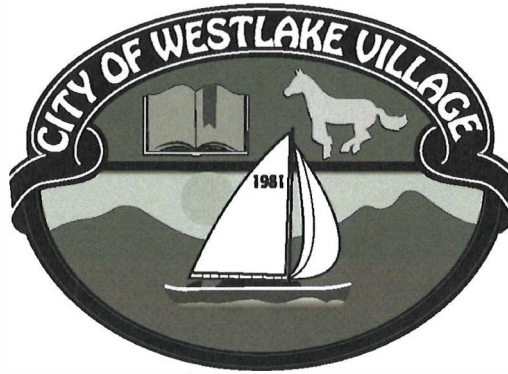

KELLY HONIG
Mayor

SUSAN McSWEENEY
Mayor Pro Tem

BRAD HALPERN
Councilmember

RAY PEARL
Councilmember

NED E DAVIS
Councilmember

May 23, 2025

Brian Neiens
Public Sector Manager
WM

[via email to bneiens@wm.com](mailto:bneiens@wm.com)

Re: 2025 Rate Adjustment Review

Dear Mr. Neiens:

The City of Westlake Village and our consultant R3 have reviewed WM's 2025 rate adjustment review submitted April 22, 2025 and revised on May 5, 2025, pursuant to Section 7.05 of the Collection Services Franchise Agreement.

The City has determined that the rate sheet, as submitted and attached here for reference, correctly reflects all rates and fees to take effect July 1, 2025.

If you have any questions or concerns, please contact me at kristen@wlv.org or 818-706-1613.

Sincerely,

A handwritten signature in blue ink, appearing to read "Kristen Asp", is written over a light blue horizontal line.

Kristen Asp
Planning Director

Attachment: 2025 Rate Sheet

City of Westlake Village Rates 2025

Residential	Proposed Rates
32G Trash SFR	\$ 28.30
64G Trash SFR	\$ 30.37
96G Trash SFR	\$ 33.48
32G Trash MF	\$ 28.30
64G Trash MF	\$ 30.37
96G Trash MF	\$ 33.48
2nd 64 Trash	\$ 13.14
3rd+ 64 Trash	\$ 8.37
2nd 96 Trash	\$ 19.51
3rd+ 96 Trash	\$ 11.80
2nd GW Cart	\$ -
3rd+ GW Cart	\$ 9.16
2nd REC Cart	\$ -
3rd+ REC Cart	\$ 5.02
Senior / Low Income Disc (cannot be combined)	10%
Franchise Fees	10% + \$1/cust /month

Non - Recurring Services Residential	
\$ 8.28	Additional pick-up
\$ 5.17	Extra bag (same day pick-up)
\$ 23.63	Set-up fee
18%	Finance charges
\$ 32.99	Return check fee
\$ 27.49	Cart Cleaning / Cart Exchange
\$ 109.95	Cart Damage Replacement
\$ 20.70	Bulky svc (after two annual trips)
\$ 30.23	Resume Service Fee

Non - Recurring Services Commercial	
\$ 276.19	Temporary 3CY bins + disposal
\$ 84.76	Extra Pick-up Fees
\$ 24.30	Set-up fee
\$ 33.90	Return check fee
18%	Finance charges
\$ 84.76	Bin Cleaning / Bin Exchange
\$ 339.06	Bin Damage - Significant
\$ 73.46	Return service same day

Additional Items	
\$ 7.15	Residential REC/ORG Contamination Fee - per event
\$ 21.52	Residential Back yard Service monthly fee
\$ (0.75)	HOA discount for centralized billing - per service account per billing period
\$ 22.60	Commercial Roll out service - per event
\$ 24.30	Commercial Bin Lock Fee monthly fee
\$ 59.90	Commercial REC/ORG Contamination Fee - per event
\$ 29.96	Commercial Overage Fee - per event
\$ 365.99	Roll-off Service - rate per pull
\$ 433.79	Compactor Roll-off Service
\$ 231.69	Rolloff delivery fee / Trip Charge
\$ 13.56	Rolloff inactivity fee - daily rate after 7 days no activity
\$ 93.71	Contamination fee per ton
\$ 87.62	Trash Disposal rate per ton*
\$ 98.49	Organics Disposal rate per ton*
\$ 134.93	Foodwaste Disposal rate per ton*
\$ 106.00	C&D Recycle Disposal rate per ton*

* Disposal per ton rates subject to change Jan 1st of each year prior to city rate sheet change in July 1st

Bundled Commercial Rate - Westlake Village*One Trash Bin comes with up to same capacity recycling and one 64 gallon organics cart***Compactor = 2x standard rate**

Commercial	Proposed Rate
32 gallon cart 1x / wk	\$ 50.86
32 gallon cart 2x / wk	\$ 91.54
32 gallon cart 3x / wk	\$ 141.83
32 gallon cart 4x / wk	\$ 191.45
32 gallon cart 5x / wk	\$ 241.19
32 gallon cart 6x / wk	\$ 289.42
64 gallon cart 1x / wk	\$ 50.85
64 gallon cart 2x / wk	\$ 91.54
64 gallon cart 3x / wk	\$ 141.83
64 gallon cart 4x / wk	\$ 191.45
64 gallon cart 5x / wk	\$ 241.19
64 gallon cart 6x / wk	\$ 289.42
96 gallon cart 1x / wk	\$ 55.84
96 gallon cart 2x / wk	\$ 97.58
96 gallon cart 3x / wk	\$ 153.43
96 gallon cart 4x / wk	\$ 209.24
96 gallon cart 5x / wk	\$ 265.08
96 gallon cart 6x / wk	\$ 320.91
1.5CY 1x / week	\$ 231.48
1.5CY 2x / week	\$ 363.20
1.5CY 3x / week	\$ 508.73
1.5CY 4x / week	\$ 651.82
1.5CY 5x / week	\$ 800.94
1.5CY 6x / week	\$ 968.24
2CY 1x / week	\$ 233.13
2CY 2x / week	\$ 381.41
2CY 3x / week	\$ 542.07
2CY 4x / week	\$ 672.49
2CY 5x / week	\$ 832.68
2CY 6x / week	\$ 983.87
3CY 1x / week	\$ 239.66
3CY 2x / week	\$ 426.25
3CY 3x / week	\$ 602.64
3CY 4x / week	\$ 746.36
3CY 5x / week	\$ 950.99
3CY 6x / week	\$ 1,150.79
4CY 1x / week	\$ 361.60
4CY 2x / week	\$ 627.62
4CY 3x / week	\$ 863.26
4CY 4x / week	\$ 1,139.33
4CY 5x / week	\$ 1,489.82
4CY 6x / week	\$ 1,688.11
6CY 1x / week	\$ 397.94
6CY 2x / week	\$ 723.77
6CY 3x / week	\$ 964.02
6CY 4x / week	\$ 1,286.82
6CY 5x / week	\$ 1,576.01
6CY 6x / week	\$ 1,886.94

Rate for additional recycling bin over and above bin provided with bundled rate

Add'l Recy Bin	Proposed Rate
32 gallon cart 1x / wk	\$ 25.42
32 gallon cart 2x / wk	\$ 39.16
32 gallon cart 3x / wk	\$ 59.79
32 gallon cart 4x / wk	\$ 81.54
32 gallon cart 5x / wk	\$ 103.30
32 gallon cart 6x / wk	\$ 125.06
64 gallon cart 1x / wk	\$ 25.42
64 gallon cart 2x / wk	\$ 45.78
64 gallon cart 3x / wk	\$ 70.92
64 gallon cart 4x / wk	\$ 95.73
64 gallon cart 5x / wk	\$ 120.59
64 gallon cart 6x / wk	\$ 144.70
96 gallon cart 1x / wk	\$ 27.93
96 gallon cart 2x / wk	\$ 48.79
96 gallon cart 3x / wk	\$ 76.71
96 gallon cart 4x / wk	\$ 104.61
96 gallon cart 5x / wk	\$ 132.54
96 gallon cart 6x / wk	\$ 160.46
1.5CY 1x / week	\$ 69.82
1.5CY 2x / week	\$ 116.51
1.5CY 3x / week	\$ 163.02
1.5CY 4x / week	\$ 214.49
1.5CY 5x / week	\$ 265.91
1.5CY 6x / week	\$ 335.46
2CY 1x / week	\$ 69.82
2CY 2x / week	\$ 122.01
2CY 3x / week	\$ 189.22
2CY 4x / week	\$ 235.18
2CY 5x / week	\$ 297.65
2CY 6x / week	\$ 351.10
3CY 1x / week	\$ 73.53
3CY 2x / week	\$ 143.67
3CY 3x / week	\$ 203.05
3CY 4x / week	\$ 248.36
3CY 5x / week	\$ 304.73
3CY 6x / week	\$ 367.27
4CY 1x / week	\$ 111.34
4CY 2x / week	\$ 194.51
4CY 3x / week	\$ 297.73
4CY 4x / week	\$ 391.37
4CY 5x / week	\$ 484.28
4CY 6x / week	\$ 514.29
6CY 1x / week	\$ 146.46
6CY 2x / week	\$ 258.06
6CY 3x / week	\$ 391.00
6CY 4x / week	\$ 513.54
6CY 5x / week	\$ 632.47
6CY 6x / week	\$ 755.90

Rate for additional organics cart over and above cart provided with bundled rate

Add'l Organics Cart	Proposed Rate
64G 1x / week	\$ 46.47
64G 2x / week	\$ 90.59
64G 3x / week	\$ 135.59

Manure Rates

	Proposed Rate		Proposed Rate
64G 1x / week	\$ 84.82	1.5CY 1x / week	\$ 136.06



Solid Waste Solutions, Inc./City Permit Services

Attachment 2 Franchise Agreement Language

rates effective July 1, 2016, and Exhibit 1-B, showing the maximum rates effective January 1, 2017. The compensation paid to Company for services rendered from the Operative Date shall not exceed that set forth in Exhibit 1, unless otherwise provided for in a written amendment to this Agreement, or adjusted pursuant to Section 5.3. Unless and until the maximum rates set forth in Exhibit 1 are adjusted, Company shall provide the services required by this Agreement charging no more than the maximum rates authorized by the approved Rate Schedule, except as provided herein.

5.3 Future Adjustments

5.3.1 Escalation

The maximum rates set forth in Exhibit 1 are subject to escalation beginning January 1, 2018. The maximum rates shall be escalated only if Company is in full and complete compliance with the obligations of this Agreement. Such escalation shall be calculated by computing the percentage change in the CPI index for the twelve (12) month period ending September 30 of each year, and multiplying the applicable amount to be escalated by one hundred percent (100%) of that percentage change in the CPI, to a maximum of three percent (3%).

“CPI Index” means the Pacific Cities and City Average All-Items Index (Los Angeles-Anaheim-Riverside), All Urban Consumers, for the Los Angeles-Anaheim-Riverside Area, as published by the United States Department of Labor, Bureau of Labor Statistics.

Company shall deliver to City notification of the rate escalation, with supporting data and calculations, by October 30 prior to the rate increase becoming effective. Failure of Company to request an increase in the maximum rates pursuant this subsection 5.3.1 in any one (1) year shall result in Company waiving its right to escalate the rates for that year.

5.3.2 Solid Waste Rate Adjustments

In addition to the annual escalation provided in subsection 5.3.1, commencing with the rate year commencing on July 1, 2018, but not more often than annually, Company may apply for an increase in the Solid Waste rates if Company can demonstrate that Company’s operational costs have substantially increased in an amount greater than the CPI adjustment pursuant to subsection 5.3.1. For the purpose of this subsection, operational costs shall be defined as: motor vehicle fuel, insurance, Company’s personnel costs (salaries and benefits), equipment repair costs, landfill and processing fee tipping fees, and equipment purchases. When applying for an increase, Company shall submit to City, by October 30, information in support of the adjustment. Additional factors to be taken into consideration in connection with the adjustment request will include, but are not limited to:

- Overall customer satisfaction with Company.
- Company's satisfactory compliance with all provisions of this Agreement.
- Company compliance with Solid Waste diversion requirements as defined and mandated by the State of California and implemented by the City of Agoura Hills.

Company shall submit any and all data requested in the format prescribed by the City Manager. The City Manager shall review the information submitted by Company and, in the City Manager's reasonable judgment, make the final determination on the appropriate amount of the adjustment, if any. A requested adjustment may not be denied in the case of changed or additional services requested by City, additional reporting required by City, City's designation of a disposal site or processing facility (except as provided in Section 3.8.4), any change in City's Municipal Code affecting Company's operations, or changes in state or local government solid waste fees and charges. Any such rate adjustment approved by the City Manager shall become effective on January 1. An adverse decision by the City Manager may be appealed to the City Council pursuant to the procedures in Section 8.1.

5.3.3 Notice of Rate Increase

Company shall provide all customers with advance written notice of Rate increases, in the form of a bill insert at least fifteen (15) days prior to the effective date of such increases.

5.4 Most Favored City

Company agrees that, should it provide comparable integrated waste management services in a neighboring city during the term of this Agreement, for rates lower than those charged by Company in City, the rates charged to customers in the City of Agoura Hills shall be reduced to an amount not greater than the amount charged to customers in that neighboring city. For purposes of this Section 5.4, "neighboring city" shall mean the cities of Calabasas, Hidden Hills, Malibu, and Westlake Village, and "comparable integrated waste management services" shall mean residential service for Solid Waste, Recyclable Materials, and Green Waste not less than once per calendar week, at generally similar frequencies, and using generally similar equipment and facilities.

5.5 City Fees

5.5.1 Administrative Fee

In consideration of this Agreement and the exclusive franchise, right and privilege to provide Solid Waste handling services to Residential Premises within the City granted by this Agreement, Company shall pay to City ten percent (10%) of all

gross receipts (the "Administrative Fee") from collection and disposal services provided to Residential Accounts within the City for each calendar year or portion thereof that this Agreement remains in effect. For purposes of this subsection 5.5.2, "gross receipts" means all revenues from services provided to Residential Accounts pursuant to this Agreement, exclusive of the waste management fee collected pursuant to subsection 5.5.3. Such sum shall be due and payable quarterly, within thirty (30) days after the end of each March, June, September and December of each year commencing on the Operative Date of this Agreement.

Once each calendar year, City may change the amount of the Administrative Fee upon thirty (30) days' written notice to Company. Should City change the amount of the Administrative Fee, the maximum rates authorized in the Rate Schedule shall be adjusted by a commensurate amount. In the event City adjusts the Annual Administrative Fee, Company shall propose a methodology for adjusting the maximum rates by a commensurate amount. Company shall submit the proposed methodology and proposed revised schedule of maximum rates to the City Manager for approval within thirty (30) days of receipt of written notice of the adjustment in the Administrative Fee.

In the event this Agreement is terminated, the balance due of any unpaid Administrative Fee shall be paid within thirty (30) days after the date services are terminated. Commencing November 30, 2016, and each November 30 thereafter, Company shall deliver to City its estimate of Company's gross receipts from Residential Accounts for the next calendar year, so that City may budget for the amount of the Administrative Fee City can anticipate receiving during the next calendar year.

5.5.2 Waste Management Fee

City has adopted a waste management fee ("WM Fee") pursuant to Public Resources Code Section 41901. In addition to the amount billed by Company for services rendered hereunder, each quarterly billing shall include the WM Fee in the amount of fifty cents (\$0.50) per month per Residential Account. This fee shall be collected by Company and paid to City quarterly.

5.5.3 Quarterly Remittance Statement

Company shall prepare and provide to City a quarterly remittance statement by the thirtieth (30th) day following the end of each March, June, September and December of each year commencing on the Operative Date of this Agreement. The quarterly remittance statement shall be accompanied by the full amount of the Administrative Fee and the WM Fee due for the preceding calendar quarter. The quarterly remittance statement shall be in the form determined by the City



Solid Waste Solutions, Inc./City Permit Services

Attachment 3
SWS modified rate increase tables
(Including Calabasas & Westlake Village Rates)

City of Agoura Hills
Proposed Rates effective 1/1/26

2025	CPI 3.00%	SWRA Increase			Proposed 2026	%	Westlake	Calabasas	Alternative Proposal Set increase at 6%				
		MSW Disposal Increase	Organics Disposal Increase	Recycle Disposal Increase					Rate + CPI	SWRA Approved 3.00%	2026 Rate + SWRA	%	
RESIDENTIAL CART SERVICE - TRASH													
32 GAL TOTER S/L	\$ 23.57	0.71	\$ 0.23	\$ 0.57	\$ 0.43	\$ 25.51	8.23%	\$ 28.30	\$ 26.12	\$ 24.28	\$ 0.73	\$ 25.00	6.10%
32 GAL TOTER S/L - senior 15%	\$ 20.03	0.60	\$ 0.23	\$ 0.57	\$ 0.43	\$ 21.86	9.13%			\$ 20.63	\$ 0.62	\$ 21.25	6.09%
64 GAL TOTER S/L (Level 1)	\$ 29.35	0.88	\$ 0.46	\$ 0.57	\$ 0.43	\$ 31.69	7.96%	\$ 30.37	\$ 37.58	\$ 30.23	\$ 0.91	\$ 31.14	6.09%
64 GAL TOTER S/L (Level 1) - senior 15%	\$ 26.47	0.79	\$ 0.46	\$ 0.57	\$ 0.43	\$ 28.72	8.49%			\$ 27.26	\$ 0.82	\$ 28.08	6.07%
96 GAL TOTER S/L (Level 2)	\$ 36.63	1.10	\$ 0.69	\$ 0.57	\$ 0.43	\$ 39.42	7.61%	\$ 33.48	\$ 45.25	\$ 37.73	\$ 1.13	\$ 38.86	6.09%
96 GAL TOTER S/L (Level 2) - senior 15%	\$ 33.03	0.99	\$ 0.69	\$ 0.57	\$ 0.43	\$ 35.70	8.10%			\$ 34.02	\$ 1.02	\$ 35.04	6.09%
Level 3 (2 - 64 gallon trash carts)	\$ 63.58	1.91	\$ 0.91	\$ 0.57	\$ 0.43	\$ 67.41	6.01%			\$ 65.49	\$ 1.96	\$ 67.46	6.09%
Level 3 senior 15%	\$ 54.04	1.62	\$ 0.91	\$ 0.57	\$ 0.43	\$ 57.58	6.54%			\$ 55.66	\$ 1.67	\$ 57.33	6.09%
Level 4 (1 - 64 gallon trash and 1 - 96 gallon trash)	\$ 71.47	2.14	\$ 1.14	\$ 0.57	\$ 0.43	\$ 75.75	5.99%			\$ 73.61	\$ 2.21	\$ 75.82	6.08%
Level 4 senior 15%	\$ 60.75	1.82	\$ 1.14	\$ 0.57	\$ 0.43	\$ 64.72	6.52%			\$ 62.57	\$ 1.88	\$ 64.45	6.09%
Level 5 (2 - 96 gallon trash carts)	\$ 72.83	2.18	\$ 1.37	\$ 0.57	\$ 0.43	\$ 77.38	6.25%			\$ 75.01	\$ 2.25	\$ 77.26	6.08%
Level 5 senior 15%	\$ 61.91	1.86	\$ 1.37	\$ 0.57	\$ 0.43	\$ 66.14	6.84%			\$ 63.77	\$ 1.91	\$ 65.68	6.09%
32 GAL TOTER S/L - multi family	\$ 18.30	0.55	\$ 0.23		\$ 0.43	\$ 19.51	6.62%	\$ 28.30	\$ 20.91	\$ 18.85	\$ 0.57	\$ 19.42	6.10%
64 GAL TOTER S/L - multi family	\$ 26.90	0.81	\$ 0.46		\$ 0.43	\$ 28.60	6.32%	\$ 30.37	\$ 32.39	\$ 27.71	\$ 0.83	\$ 28.55	6.10%
96 GAL TOTER S/L - multi family	\$ 31.88	0.96	\$ 0.69		\$ 0.43	\$ 33.96	6.52%	\$ 33.48	\$ 40.02	\$ 32.84	\$ 0.99	\$ 33.83	6.10%
VALET SERVICE S/L	\$ 20.00	0.60				\$ 20.60	3.00%	\$ 21.52	\$ 26.30	\$ 20.60	\$ 0.62	\$ 21.22	6.09%
START CHARGE	\$ 25.25	0.76				\$ 26.01	3.01%	\$ 30.23		\$ 26.01		\$ 26.01	3.01%
CUT OFF / RESTART FEE	\$ 24.62	0.74				\$ 25.36	3.01%	\$ 30.23	\$ 25.89	\$ 25.36		\$ 25.36	3.01%
CUSTOMER SERVICE CREDIT CARD PROCESSING FEE	\$ 10.21	0.31				\$ 10.52	3.04%		\$ 10.47	\$ 10.52		\$ 10.52	3.04%
RECYCLE CONTAMINATION FEE	\$ 30.58	0.92				\$ 31.50	3.01%			\$ 31.50		\$ 31.50	3.01%
GREENWASTE CONTAMINATION FEE	\$ 30.58	0.92				\$ 31.50	3.01%			\$ 31.50		\$ 31.50	3.01%
EXTRA PICKUP ON SCHEDULED SERVICE DAY - BAG	\$ 4.10	0.12	\$ 0.15			\$ 4.37	6.59%	\$ 5.17	\$ 4.41	\$ 4.22	\$ 0.13	\$ 4.35	6.02%
EXTRA PICKUP ON SCHEDULED SERVICE DAY - CART	\$ 6.87	0.21	\$ 0.46			\$ 7.54	9.71%	\$ 8.28	\$ 7.36	\$ 7.08	\$ 0.21	\$ 7.29	6.15%
EXTRA PICKUP ON NON-SCHEDULED SERVICE DAY*	\$ 34.15	1.02	\$ 0.46			\$ 35.63	4.32%		\$ 36.75	\$ 35.17	\$ 1.06	\$ 36.23	6.08%
ADDITIONAL BULKY ITEMS PICKUP (after 2 trips of two items)	\$ 32.17	0.97	\$ 0.46			\$ 33.59	4.44%	\$ 20.70	\$ 33.34	\$ 33.14	\$ 0.99	\$ 34.13	6.11%
* For 3 carts or bags, anything over this is extra - see above.									\$ 19.94				
64 GAL S/L TOTER - RECYCLING ADD'L	\$ 5.46	0.16	\$ -		\$ 0.43	\$ 6.05	10.87%	\$ 5.02		\$ 5.62	\$ 0.17	\$ 5.79	6.02%
96 GAL S/L TOTER - RECYCLING ADD'L	\$ 5.71	0.17	\$ -		\$ 0.43	\$ 6.31	10.57%		\$ -	\$ 5.88	\$ 0.18	\$ 6.05	6.07%
96 GAL S/L TOTER - GRN/YDW ADD'L	\$ 4.73	0.14	\$ -	\$ 0.57		\$ 5.43	14.95%	\$ 9.16	\$ -	\$ 4.87	\$ 0.15	\$ 5.01	6.05%

City of Agoura Hills
Proposed Rates effective 1/1/26

	2025	CPI 3.00%	SWRA Increase			Proposed 2026	%	Westlake	Calabasas	Alternative Proposal Set increase at 6%			
			MSW Disposal Increase	Organics Disposal Increase	Recycle Increase					Rate + CPI	SWRA Approved 3.00%	Rate + SWRA	2026
96 GAL GRN/YDW/Manure	\$ 12.68	0.38	\$ -	\$ 0.57	\$ 13.63	7.47%			\$ 13.06	\$ 0.39	\$ 13.45	6.09%	
Additional 64 gallon trash toter	\$ 13.64	0.41	\$ 0.46		\$ 14.50	6.36%	\$ 13.14	\$ 7.67	\$ 14.05	\$ 0.42	\$ 14.47	6.10%	
Third additional 96 gallon trash toter	\$ 25.36	0.76	\$ 0.69		\$ 26.80	5.70%	\$ 11.80	\$ 12.24	\$ 26.12	\$ 0.78	\$ 26.90	6.09%	
RESIDENTIAL BIN SERVICE - TRASH													
1.5 YD 1X Per Week Trash	\$ 98.16	2.94	\$ 2.57		\$ 103.67	5.62%		\$ 113.23	\$ 101.10	\$ 3.03	\$ 104.13	6.08%	
1.5 YD 2X Per Week Trash	\$ 176.42	5.29	\$ 5.14		\$ 186.85	5.91%		\$ 208.34	\$ 181.71	\$ 5.45	\$ 187.16	6.09%	
1.5 YD 3X Per Week Trash	\$ 247.57	7.43	\$ 7.72		\$ 262.72	6.12%		\$ 312.51	\$ 255.00	\$ 7.65	\$ 262.65	6.09%	
1.5 YD 4X Per Week Trash	\$ 313.33	9.40	\$ 10.29		\$ 333.01	6.28%		\$ 416.66	\$ 322.73	\$ 9.68	\$ 332.41	6.09%	
1.5 YD 5X Per Week Trash	\$ 389.83	11.70	\$ 12.86		\$ 414.39	6.30%		\$ 520.83	\$ 401.53	\$ 12.05	\$ 413.58	6.09%	
1.5 YD 6X Per Week Trash	\$ 461.01	13.83	\$ 15.43		\$ 490.27	6.35%		\$ 625.02	\$ 474.84	\$ 14.25	\$ 489.08	6.09%	
3.0 YD 1X Per Week Trash	\$ 111.63	3.35	\$ 5.14		\$ 120.13	7.61%		\$ 123.72	\$ 114.98	\$ 3.45	\$ 118.43	6.09%	
3.0 YD 2X Per Week Trash	\$ 205.38	6.16	\$ 10.29		\$ 221.83	8.01%		\$ 227.60	\$ 211.54	\$ 6.35	\$ 217.89	6.09%	
3.0 YD 3X Per Week Trash	\$ 307.34	9.22	\$ 15.43		\$ 331.99	8.02%		\$ 341.39	\$ 316.56	\$ 9.50	\$ 326.06	6.09%	
3.0 YD 4X Per Week Trash	\$ 398.40	11.95	\$ 20.58		\$ 430.93	8.16%		\$ 455.75	\$ 410.35	\$ 12.31	\$ 422.66	6.09%	
3.0 YD 5X Per Week Trash	\$ 489.47	14.68	\$ 25.72		\$ 529.87	8.25%		\$ 568.99	\$ 504.15	\$ 15.12	\$ 519.27	6.09%	
3.0 YD 6X Per Week Trash	\$ 580.55	17.42	\$ 30.86		\$ 628.83	8.32%		\$ 682.84	\$ 597.97	\$ 17.94	\$ 615.91	6.09%	
4.0 YD 1X Per Week Trash	\$ 121.06	3.63	\$ 6.86		\$ 131.54	8.66%		\$ 134.15	\$ 124.69	\$ 3.74	\$ 128.43	6.09%	
4.0 YD 2X Per Week Trash	\$ 222.76	6.68	\$ 13.72		\$ 243.16	9.16%		\$ 246.85	\$ 229.44	\$ 6.88	\$ 236.32	6.09%	
4.0 YD 3X Per Week Trash	\$ 330.26	9.91	\$ 20.58		\$ 360.75	9.23%		\$ 366.00	\$ 340.17	\$ 10.21	\$ 350.37	6.09%	
4.0 YD 4X Per Week Trash	\$ 445.50	13.36	\$ 27.43		\$ 486.29	9.16%		\$ 493.71	\$ 458.86	\$ 13.77	\$ 472.62	6.09%	
4.0 YD 5X Per Week Trash	\$ 556.87	16.71	\$ 34.29		\$ 607.87	9.16%		\$ 617.13	\$ 573.58	\$ 17.21	\$ 590.79	6.09%	
4.0 YD 6X Per Week Trash	\$ 667.06	20.01	\$ 41.15		\$ 728.22	9.17%		\$ 740.56	\$ 687.07	\$ 20.61	\$ 707.68	6.09%	
RESIDENTIAL BIN SERVICE - RECYCLE													
1.5 YD 1X Per Week Recycle	\$ 41.93	1.26		\$ 4.43	\$ 47.62	13.57%		\$ 56.62	\$ 43.19	\$ 1.30	\$ 44.49	6.10%	
1.5 YD 2X Per Week Recycle	\$ 83.53	2.51		\$ 8.86	\$ 94.90	13.61%		\$ 104.17	\$ 86.04	\$ 2.58	\$ 88.62	6.10%	
1.5 YD 3X Per Week Recycle	\$ 125.13	3.75		\$ 13.29	\$ 142.17	13.62%		\$ 156.25	\$ 128.88	\$ 3.87	\$ 132.75	6.09%	
1.5 YD 4X Per Week Recycle	\$ 167.08	5.01		\$ 17.72	\$ 189.81	13.60%		\$ 208.32	\$ 172.09	\$ 5.16	\$ 177.25	6.09%	
1.5 YD 5X Per Week Recycle	\$ 208.66	6.26		\$ 22.15	\$ 237.07	13.61%		\$ 206.42	\$ 214.92	\$ 6.45	\$ 221.37	6.09%	
1.5 YD 6X Per Week Recycle	\$ 250.40	7.51		\$ 26.58	\$ 284.49	13.61%		\$ 312.52	\$ 257.91	\$ 7.74	\$ 265.65	6.09%	
3.0 YD 1X Per Week Recycle	\$ 49.88	1.50		\$ 8.86	\$ 60.24	20.77%		\$ 61.86	\$ 51.38	\$ 1.54	\$ 52.92	6.10%	
3.0 YD 2X Per Week Recycle	\$ 98.15	2.94		\$ 17.72	\$ 118.81	21.05%		\$ 113.80	\$ 101.09	\$ 3.03	\$ 104.12	6.09%	
3.0 YD 3X Per Week Recycle	\$ 143.76	4.31		\$ 26.58	\$ 174.65	21.49%		\$ 170.69	\$ 148.07	\$ 4.44	\$ 152.51	6.09%	
3.0 YD 4X Per Week Recycle	\$ 189.68	5.69		\$ 35.44	\$ 230.81	21.68%		\$ 227.88	\$ 195.37	\$ 5.86	\$ 201.23	6.09%	

All of Westlake Commercial rates are bundled. Comes with equal volume recycling and 64 gal organics

2026 Rate sheet

City of Agoura Hills
Proposed Rates effective 1/1/26

	2025	CPI	MSW Disposal Increase	SWRA Increase			%	Westlake	Calabasas	Alternative Proposal Set increase at 6%			
		3.00%		Organics Disposal Increase	Recycle Disposal Increase	Proposed 2026				Rate + CPI	SWRA Approved 3.00%	2026 Rate + SWRA	%
3.0 YD 5X Per Week Recycle	\$ 235.29	7.06			\$ 44.30	\$ 286.65	21.83%		\$ 284.51	\$ 242.35	\$ 7.27	\$ 249.62	6.09%
3.0 YD 6X Per Week Recycle	\$ 281.00	8.43			\$ 53.16	\$ 342.59	21.92%		\$ 341.42	\$ 289.43	\$ 8.68	\$ 298.11	6.09%
4.0 YD 1X Per Week Recycle	\$ 56.53	1.70			\$ 11.81	\$ 70.04	23.90%		\$ 67.09	\$ 58.23	\$ 1.75	\$ 59.98	6.10%
4.0 YD 2X Per Week Recycle	\$ 107.45	3.22			\$ 23.62	\$ 134.29	24.98%		\$ 123.43	\$ 110.67	\$ 3.32	\$ 113.99	6.09%
4.0 YD 3X Per Week Recycle	\$ 158.34	4.75			\$ 35.44	\$ 198.53	25.38%		\$ 183.00	\$ 163.09	\$ 4.89	\$ 167.98	6.09%
4.0 YD 4X Per Week Recycle	\$ 206.97	6.21			\$ 47.25	\$ 260.43	25.83%		\$ 246.85	\$ 213.18	\$ 6.40	\$ 219.58	6.09%
4.0 YD 5X Per Week Recycle	\$ 255.24	7.66			\$ 59.06	\$ 321.96	26.14%		\$ 308.57	\$ 262.90	\$ 7.89	\$ 270.79	6.09%
4.0 YD 6X Per Week Recycle	\$ 303.64	9.11			\$ 70.87	\$ 383.62	26.34%		\$ 370.28	\$ 312.75	\$ 9.38	\$ 322.13	6.09%
Valet service 1X Per Week	\$ 47.60	1.43				\$ 49.03	3.00%		\$ 58.78	\$ 49.03	\$ 1.47	\$ 50.50	6.09%
Valet service 2X Per Week	\$ 61.10	1.83				\$ 62.93	3.00%			\$ 62.93	\$ 1.89	\$ 64.82	6.08%
Valet service 3X Per Week	\$ 91.39	2.74				\$ 94.13	3.00%			\$ 94.13	\$ 2.82	\$ 96.96	6.09%
3yd Yard Waste/Manure	\$ 163.28	4.90				\$ 168.18	3.00%			\$ 168.18	\$ 5.05	\$ 173.22	6.09%



Solid Waste Solutions, Inc./City Permit Services

Attachment 4 SWS CPI Calculation Verification

**Consumer Price Index for All Urban Consumers (CPI-U)
Original Data Value**

Series Id: CUURS49ASA0
Not Seasonally Adjusted
Series Title: All items in Los Angeles-Long Beach-Anaheim, CA, all
Area: Los Angeles-Long Beach-Anaheim, CA
Item: All items
Base Period: 1982-84=100
Years: 2015 to 2025

Year	Jan	Feb	Mar	Apr	May	Jun	Jul	Aug	Sep	Oct	Nov	Dec	Annual	HALF1	HALF2
2015	239.724	241.297	243.738	243.569	246.093	245.459	247.066	246.328	245.431	245.812	245.711	245.357	244.632	243.313	245.951
2016	247.155	247.113	247.873	248.368	249.554	249.789	249.784	249.700	250.145	251.098	250.185	250.189	249.246	248.309	250.184
2017	252.373	253.815	254.525	254.971	255.674	255.275	256.023	256.739	257.890	258.883	259.135	259.220	256.210	254.439	257.982
2018	261.235	263.012	264.158	265.095	266.148	265.522	266.007	266.665	268.032	269.482	268.560	267.631	265.962	264.195	267.730
2019	269.468	269.608	271.311	273.945	274.479	274.380	274.682	274.579	276.054	278.075	277.239	275.553	274.114	272.199	276.030
2020	277.755	278.657	276.589	275.853	276.842	278.121	279.899	280.116	279.366	279.947	280.102	279.560	278.567	277.303	279.832
2021	280.178	281.347	282.648	285.808	287.620	289.218	290.890	291.333	292.209	294.961	296.790	297.925	289.244	284.470	294.018
2022	301.209	302.164	306.679	308.302	310.649	314.072	313.415	313.608	315.033	317.014	314.633	312.601	310.782	307.179	314.384
2023	318.591	317.571	317.873	320.089	320.514	322.055	321.931	324.050	324.984	324.545	323.341	323.456	321.583	319.449	323.718
2024	326.640	328.232	330.671	332.572	332.956	332.357	332.928	333.359	334.123	334.242	333.718	334.531	332.194	330.571	333.817
2025	337.508	338.438	340.648	342.565	343.010	343.024	343.624	344.503	345.865						340.866

SWS Calculation check for Waste Management CPI

Oct 2024 - Sept 2025		4081.676				
Oct 2023-Sept 2024		3955.180				
				12 mo.	Average	
	Total:	Oct 2024 - Sept 2025	4081.676	340.1397		
	Total:	Oct 2023-Sept 2024	3955.180	329.5983		
3% maximum		Difference	126.4960	10.54133		
		Divided by Diff/23-24	0.0320	0.031982		
		Percentage (X100)	3.1982	3.1982		

	12 mon	Average
Oct 2024 - Sept 2025	4081.676	340.1397
Oct 2023-Sept 2024	3955.18	329.5983

City of Agoura Hills
Proposed Rates effective 1/1/26

RESIDENTIAL CART SERVICE - TRASH	CPI		SWRA		2026		MFN Rate	Final 2026	%
	2025	3.00%	Rate + CPI	3.00%	Rate + SWRA	Approved			
32 GAL TOTER S/L	\$ 23.57	0.71	\$ 24.28	\$ 0.73	\$ 25.00	\$ 26.12	\$ 25.00	6.10%	
32 GAL TOTER S/L - senior 15%	\$ 20.03	0.60	\$ 20.63	\$ 0.62	\$ 21.25	\$ 21.25	\$ 21.25	6.09%	
64 GAL TOTER S/L (Level 1)	\$ 29.35	0.88	\$ 30.23	\$ 0.91	\$ 31.14	\$ 30.38	\$ 30.38	3.51%	
64 GAL TOTER S/L (Level 1) - senior 15%	\$ 26.47	0.79	\$ 27.26	\$ 0.82	\$ 28.08	\$ 28.08	\$ 28.08	6.07%	
96 GAL TOTER S/L (Level 2)	\$ 36.63	1.10	\$ 37.73	\$ 1.13	\$ 38.86	\$ 33.48	\$ 36.63	0.00%	
96 GAL TOTER S/L (Level 2) - senior 15%	\$ 33.03	0.99	\$ 34.02	\$ 1.02	\$ 35.04	\$ 35.04	\$ 35.04	6.09%	
Level 3 (2 - 64 gallon trash carts)	\$ 63.58	1.91	\$ 65.49	\$ 1.96	\$ 67.46	\$ 67.46	\$ 67.46	6.09%	
Level 3 senior 15%	\$ 54.04	1.62	\$ 55.66	\$ 1.67	\$ 57.33	\$ 57.33	\$ 57.33	6.09%	
Level 4 (1 - 64 gallon trash and 1 - 96 gallon trash)	\$ 71.47	2.14	\$ 73.61	\$ 2.21	\$ 75.82	\$ 75.82	\$ 75.82	6.08%	
Level 4 senior 15%	\$ 60.75	1.82	\$ 62.57	\$ 1.88	\$ 64.45	\$ 64.45	\$ 64.45	6.09%	
Level 5 (2 - 96 gallon trash carts)	\$ 72.83	2.18	\$ 75.01	\$ 2.25	\$ 77.26	\$ 77.26	\$ 77.26	6.08%	
Level 5 senior 15%	\$ 61.91	1.86	\$ 63.77	\$ 1.91	\$ 65.68	\$ 65.68	\$ 65.68	6.09%	
32 GAL TOTER S/L - multi family	\$ 18.30	0.55	\$ 18.85	\$ 0.57	\$ 19.42	\$ 19.42	\$ 19.42	6.10%	
64 GAL TOTER S/L - multi family	\$ 26.90	0.81	\$ 27.71	\$ 0.83	\$ 28.55	\$ 28.55	\$ 28.55	6.10%	
96 GAL TOTER S/L - multi family	\$ 31.88	0.96	\$ 32.84	\$ 0.99	\$ 33.83	\$ 33.83	\$ 33.83	6.10%	
VALET SERVICE S/L	\$ 20.00	0.60	\$ 20.60	\$ 0.62	\$ 21.22	\$ 21.22	\$ 21.22	6.09%	
START CHARGE	\$ 25.25	0.76	\$ 26.01	\$ 26.01	\$ 26.01	\$ 26.01	\$ 26.01	3.01% No SWRA	
CUT OFF / RESTART FEE	\$ 24.62	0.74	\$ 25.36	\$ 25.36	\$ 25.36	\$ 25.36	\$ 25.36	3.01% ^	
CUSTOMER SERVICE CREDIT CARD PROCESSING FEE	\$ 10.21	0.31	\$ 10.52	\$ 10.52	\$ 10.52	\$ 10.52	\$ 10.52	3.04% ^	
RECYCLE CONTAMINATION FEE	\$ 30.58	0.92	\$ 31.50	\$ 31.50	\$ 31.50	\$ 31.50	\$ 31.50	3.01% ^	
GREENWASTE CONTAMINATION FEE	\$ 30.58	0.92	\$ 31.50	\$ 31.50	\$ 31.50	\$ 31.50	\$ 31.50	3.01% ^	
EXTRA PICKUP ON SCHEDULED SERVICE DAY - BAG	\$ 4.10	0.12	\$ 4.22	\$ 0.13	\$ 4.35	\$ 4.35	\$ 4.35	6.02%	
EXTRA PICKUP ON SCHEDULED SERVICE DAY - CART	\$ 6.87	0.21	\$ 7.08	\$ 0.21	\$ 7.29	\$ 7.29	\$ 7.29	6.15%	
EXTRA PICKUP ON NON-SCHEDULED SERVICE DAY*	\$ 34.15	1.02	\$ 35.17	\$ 1.06	\$ 36.23	\$ 36.23	\$ 36.23	6.08%	
ADDITIONAL BULKY ITEMS PICKUP (after 2 trips of two items)	\$ 32.17	0.97	\$ 33.14	\$ 0.99	\$ 34.13	\$ 34.13	\$ 34.13	6.11%	
* For 3 carts or bags, anything over this is extra - see above.									
64 GAL S/L TOTER - RECYCLING ADD'L	\$ 5.46	0.16	\$ 5.62	\$ 0.17	\$ 5.79	\$ 5.79	\$ 5.79	6.02%	
96 GAL S/L TOTER - RECYCLING ADD'L	\$ 5.71	0.17	\$ 5.88	\$ 0.18	\$ 6.05	\$ 6.05	\$ 6.05	6.07%	
96 GAL S/L TOTER - GRN/YDW ADD'L	\$ 4.73	0.14	\$ 4.87	\$ 0.15	\$ 5.01	\$ 5.01	\$ 5.01	6.05%	
96 GAL GRN/YDW/Manure	\$ 12.68	0.38	\$ 13.06	\$ 0.39	\$ 13.45	\$ 13.45	\$ 13.45	6.09%	
Additional 64 gallon trash toter	\$ 13.64	0.41	\$ 14.05	\$ 0.42	\$ 14.47	\$ 14.47	\$ 14.47	6.10%	
Third additional 96 gallon trash toter	\$ 25.36	0.76	\$ 26.12	\$ 0.78	\$ 26.90	\$ 26.90	\$ 26.90	6.09%	
RESIDENTIAL BIN SERVICE - TRASH									
1.5 YD 1X Per Week Trash	\$ 98.16	2.94	\$ 101.10	\$ 3.03	\$ 104.13	\$ 104.13	\$ 104.13	6.08%	
1.5 YD 2X Per Week Trash	\$ 176.42	5.29	\$ 181.71	\$ 5.45	\$ 187.16	\$ 187.16	\$ 187.16	6.09%	
1.5 YD 3X Per Week Trash	\$ 247.57	7.43	\$ 255.00	\$ 7.65	\$ 262.65	\$ 262.65	\$ 262.65	6.09%	
1.5 YD 4X Per Week Trash	\$ 313.33	9.40	\$ 322.73	\$ 9.68	\$ 332.41	\$ 332.41	\$ 332.41	6.09%	
1.5 YD 5X Per Week Trash	\$ 389.83	11.70	\$ 401.53	\$ 12.05	\$ 413.58	\$ 413.58	\$ 413.58	6.09%	
1.5 YD 6X Per Week Trash	\$ 461.01	13.83	\$ 474.84	\$ 14.25	\$ 489.08	\$ 489.08	\$ 489.08	6.09%	
3.0 YD 1X Per Week Trash	\$ 111.63	3.35	\$ 114.98	\$ 3.45	\$ 118.43	\$ 118.43	\$ 118.43	6.09%	
3.0 YD 2X Per Week Trash	\$ 205.38	6.16	\$ 211.54	\$ 6.35	\$ 217.89	\$ 217.89	\$ 217.89	6.09%	
3.0 YD 3X Per Week Trash	\$ 307.34	9.22	\$ 316.56	\$ 9.50	\$ 326.06	\$ 326.06	\$ 326.06	6.09%	
3.0 YD 4X Per Week Trash	\$ 398.40	11.95	\$ 410.35	\$ 12.31	\$ 422.66	\$ 422.66	\$ 422.66	6.09%	
3.0 YD 5X Per Week Trash	\$ 489.47	14.68	\$ 504.15	\$ 15.12	\$ 519.27	\$ 519.27	\$ 519.27	6.09%	
3.0 YD 6X Per Week Trash	\$ 580.55	17.42	\$ 597.97	\$ 17.94	\$ 615.91	\$ 615.91	\$ 615.91	6.09%	
4.0 YD 1X Per Week Trash	\$ 121.06	3.63	\$ 124.69	\$ 3.74	\$ 128.43	\$ 128.43	\$ 128.43	6.09%	
4.0 YD 2X Per Week Trash	\$ 222.76	6.68	\$ 229.44	\$ 6.88	\$ 236.32	\$ 236.32	\$ 236.32	6.09%	
4.0 YD 3X Per Week Trash	\$ 330.26	9.91	\$ 340.17	\$ 10.21	\$ 350.37	\$ 350.37	\$ 350.37	6.09%	
4.0 YD 4X Per Week Trash	\$ 445.50	13.36	\$ 458.86	\$ 13.77	\$ 472.62	\$ 472.62	\$ 472.62	6.09%	
4.0 YD 5X Per Week Trash	\$ 556.87	16.71	\$ 573.58	\$ 17.21	\$ 590.79	\$ 590.79	\$ 590.79	6.09%	
4.0 YD 6X Per Week Trash	\$ 667.06	20.01	\$ 687.07	\$ 20.61	\$ 707.68	\$ 707.68	\$ 707.68	6.09%	
RESIDENTIAL BIN SERVICE - RECYCLE									
1.5 YD 1X Per Week Recycle	\$ 41.93	1.26	\$ 43.19	\$ 1.30	\$ 44.49	\$ 44.49	\$ 44.49	6.10%	
1.5 YD 2X Per Week Recycle	\$ 83.53	2.51	\$ 86.04	\$ 2.58	\$ 88.62	\$ 88.62	\$ 88.62	6.10%	
1.5 YD 3X Per Week Recycle	\$ 125.13	3.75	\$ 128.88	\$ 3.87	\$ 132.75	\$ 132.75	\$ 132.75	6.09%	
1.5 YD 4X Per Week Recycle	\$ 167.08	5.01	\$ 172.09	\$ 5.16	\$ 177.25	\$ 177.25	\$ 177.25	6.09%	
1.5 YD 5X Per Week Recycle	\$ 208.66	6.26	\$ 214.92	\$ 6.45	\$ 221.37	\$ 221.37	\$ 221.37	6.09%	
1.5 YD 6X Per Week Recycle	\$ 250.40	7.51	\$ 257.91	\$ 7.74	\$ 265.65	\$ 265.65	\$ 265.65	6.09%	
3.0 YD 1X Per Week Recycle	\$ 49.88	1.50	\$ 51.38	\$ 1.54	\$ 52.92	\$ 52.92	\$ 52.92	6.10%	
3.0 YD 2X Per Week Recycle	\$ 98.15	2.94	\$ 101.09	\$ 3.03	\$ 104.12	\$ 104.12	\$ 104.12	6.09%	
3.0 YD 3X Per Week Recycle	\$ 143.76	4.31	\$ 148.07	\$ 4.44	\$ 152.51	\$ 152.51	\$ 152.51	6.09%	
3.0 YD 4X Per Week Recycle	\$ 189.68	5.69	\$ 195.37	\$ 5.86	\$ 201.23	\$ 201.23	\$ 201.23	6.09%	
3.0 YD 5X Per Week Recycle	\$ 235.29	7.06	\$ 242.35	\$ 7.27	\$ 249.62	\$ 249.62	\$ 249.62	6.09%	
3.0 YD 6X Per Week Recycle	\$ 281.00	8.43	\$ 289.43	\$ 8.68	\$ 298.11	\$ 298.11	\$ 298.11	6.09%	
4.0 YD 1X Per Week Recycle	\$ 56.53	1.70	\$ 58.23	\$ 1.75	\$ 59.98	\$ 59.98	\$ 59.98	6.10%	
4.0 YD 2X Per Week Recycle	\$ 107.45	3.22	\$ 110.67	\$ 3.32	\$ 113.99	\$ 113.99	\$ 113.99	6.09%	
4.0 YD 3X Per Week Recycle	\$ 158.34	4.75	\$ 163.09	\$ 4.89	\$ 167.98	\$ 167.98	\$ 167.98	6.09%	
4.0 YD 4X Per Week Recycle	\$ 206.97	6.21	\$ 213.18	\$ 6.40	\$ 219.58	\$ 219.58	\$ 219.58	6.09%	
4.0 YD 5X Per Week Recycle	\$ 255.24	7.66	\$ 262.90	\$ 7.89	\$ 270.79	\$ 270.79	\$ 270.79	6.09%	
4.0 YD 6X Per Week Recycle	\$ 303.64	9.11	\$ 312.75	\$ 9.38	\$ 322.13	\$ 322.13	\$ 322.13	6.09%	
Valet service 1X Per Week	\$ 47.60	1.43	\$ 49.03	\$ 1.47	\$ 50.50	\$ 50.50	\$ 50.50	6.09%	
Valet service 2X Per Week	\$ 61.10	1.83	\$ 62.93	\$ 1.89	\$ 64.82	\$ 64.82	\$ 64.82	6.08%	
Valet service 3X Per Week	\$ 91.39	2.74	\$ 94.13	\$ 2.82	\$ 96.96	\$ 96.96	\$ 96.96	6.09%	
3yd Yard Waste/Manure	\$ 163.28	4.90	\$ 168.18	\$ 5.05	\$ 173.22	\$ 173.22	\$ 173.22	6.09%	